

Replacement Manual

FW17 Release Handle



FW17 Series Replacement Handle Kit RK-171-11079-M

Introduction

This manual provides the information necessary to properly replace FW17 series top plate release handles.

NOTE: For Holland Fifth Wheel replacement components contact SAF-HOLLAND Customer Service: 888-396-6501.

Warranty

Refer to the complete warranty for the country in which the product will be used. A copy of the written warranty was included with the fifth wheel and can also be found on the SAF-HOLLAND Web Site (www.safholland.us).

Notes, Cautions, and Warnings

You must read and understand all of the procedures presented in this manual before starting work on any Holland fifth wheel.

NOTE: In the United States, work shop safety requirements are defined by federal and/or state Occupational Safety and Health Act. Equivalent laws may exist in other countries. This manual is written based on the assumption that OSHA or other applicable employee safety regulations are followed by the location where work is performed.

IMPORTANT: Read this manual before using this product. Keep this manual in a safe location for future reference.

WARNING Failure to follow all the repair procedures contained in this manual could cause a hazardous condition to develop which, if not avoided, could result in death or serious injury.

Proper tools must be used to perform the rebuild procedures described in this manual.

Throughout this manual, you will notice the terms "NOTE", "IMPORTANT", "CAUTION", and "WARNING", followed by useful product information. So that you may better understand the manual, those terms are as follows:

NOTE: Includes additional information to enable accurate and easy performance of procedures.

IMPORTANT: Includes additional information that if not followed could lead to hindered product performance.

CAUTION

Used without the safety alert symbol, indicates a potentially hazardous situation which, if not avoided, could result in property damage.

CAUTION

Indicates a potentially hazardous situation which, if not avoided, could result in minor or moderate injury.

WARNING

Indicates a potentially hazardous situation which, if not avoided, could result in death or serious injury.



SAF-HOLLAND Group

Model Identification and General Safety Instructions

1. Model Identification

This manual contains the installation procedures for SAF-HOLLAND replacement kit RK-171-11079-M. This repair kit is only for FW17 series fifth wheels where the fifth wheel's release handle remains on the top plate's unlock notch and does not automatically move to the "ready to couple" position when the trailer kingpin exits the top plate's locking mechanism. Therefore, the fifth wheel will remain unlocked during the next coupling attempt. Refer to Service Bulletin XL-FW10092SB-en-US for detailed information. Before replacement, verify that you have the correct replacement kit for the fifth wheel top plate you are attempting to repair.

Fifth wheel serial tags are located on the left side of the fifth wheel top plate above the fifth wheel bracket pin, or on the pickup ramps as shown. The part number and serial number are listed on the tag as indicated (**Figure 1**).

Figure 1

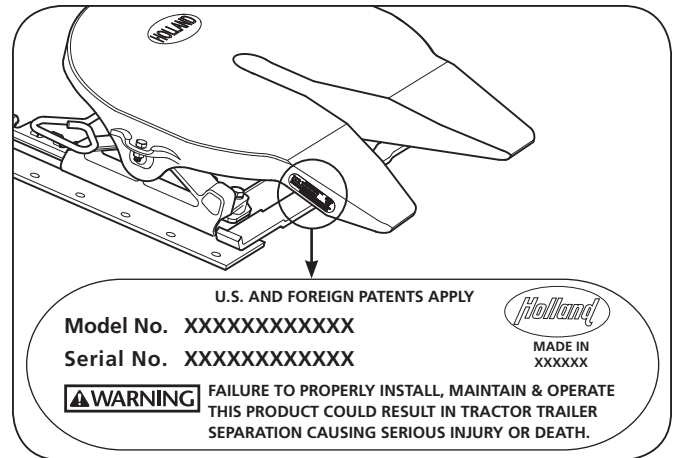

2. General Safety Instructions

Read and observe all Warning and Caution hazard alert messages in this publication. They provide information that can help prevent serious personal injury, damage to components, or both.

All fifth wheel repair and maintenance must be performed by a trained technician using proper tools and safe procedures.

NOTE: Before repairing your Holland Fifth Wheel review the model number on the identification tag. This replacement procedure applies only to the FW17 series fifth wheels.

IMPORTANT: These instructions apply to the proper replacement of FW17 series fifth wheel release handle only.

WARNING Failure to properly repair and install the fifth wheel could adversely affect performance resulting in tractor trailer separation which, if not avoided, could result in death or serious injury.

We recommend only the use of SAF-HOLLAND Original Parts.

A list of SAF-HOLLAND technical support locations to supply SAF-HOLLAND Original Parts can be found at www.safholland.us or contact our customer service group at 888-396-6501.

Updates to this manual will be published as necessary on the Internet at www.safholland.us.

3. Kit Contents (Figure 2)

ITEM	DESCRIPTION	PART NUMBER	QTY.
1	Release Handle	XA-10495-RP-M	1
2	Washer, 1/2" SAE	XB-PW-1732-1-116	1
3	Cotter Pin	XB-16	1
4	Extension Spring, Inner	XB-10489	1
5	Extension Spring, Outer	XB-10490	1

Figure 2

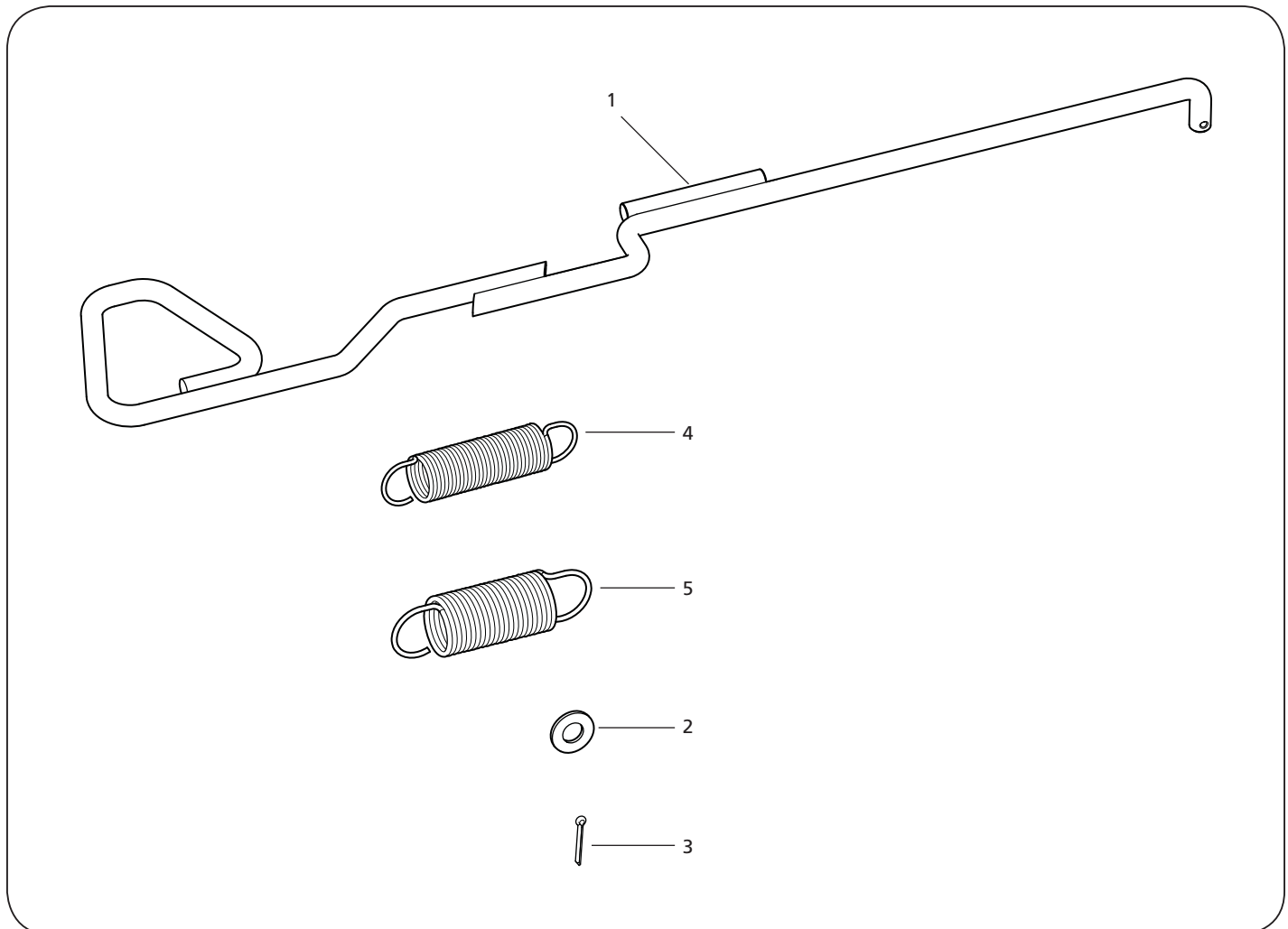

4. Top Plate Removal

1. Clean off excessive grease, grime, and dirt from top plate.
2. Remove bracket pin retention bolt and nut from both sides of fifth wheel top plate (**Figure 3**).
3. Using a pry bar, pull bracket retention pins out of fifth wheel top plate (**Figure 3**).
4. Using a lifting device capable of lifting 500 lbs. (227 kg), remove top plate from mounting base. Place fifth wheel upside down on a flat, clean working area.

NOTE: Follow instructions published by lifting device manufacturer for proper operation of lifting device.

Figure 3

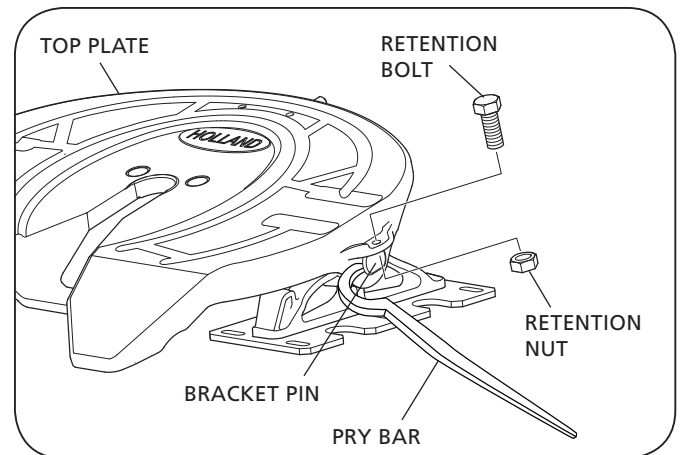

5. Replacement Procedures

1. Carefully detach springs from loop on release handle. Remove existing release handle from the top plate by cutting through the handle near the release cam so the "S-bend" in the handle can be removed (**Figure 4**). Discard all release handle parts.
2. Insert the new release handle through the cast slot on the top plate. Position the end of the release handle into the hole in the release cam (**Figure 5**).
3. Install the washer and cotter pin (**Figure 5**) to connect the new release handle to the release cam.
4. Spread the cotter pin legs so that the ends wrap around the release handle.
5. Insert the inner extension spring into the outer extension spring. Attach the new extension springs so that both spring openings face down when the fifth wheel is mounted on the truck (**Figure 6**).

Figure 4

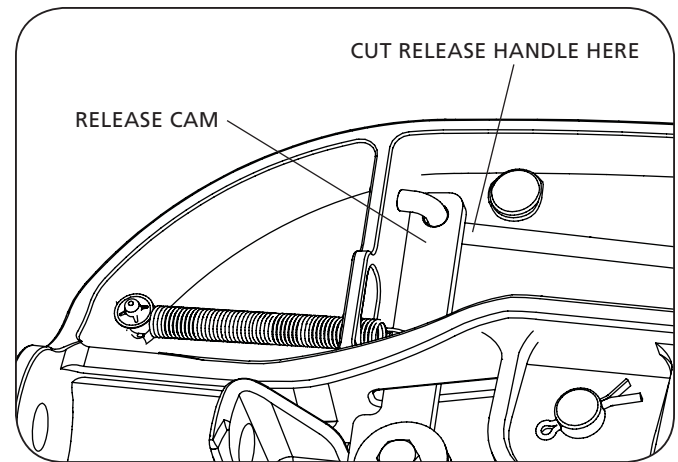

Figure 5

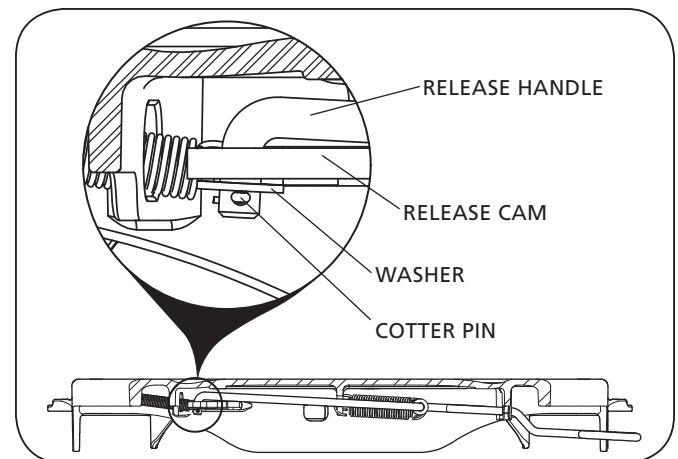
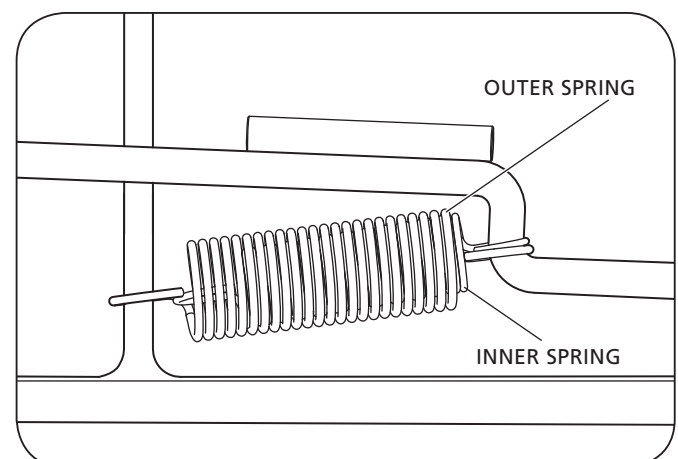

Figure 6



6. Operation Check

1. Verify the proper operation of the fifth wheel by locking and unlocking the fifth wheel using a SAF-HOLLAND Kingpin Lock Tester TF-TLN-5001 (**Figure 7**).
2. Set the lock tester tool on the fifth wheel, engage the "J" hook, and rotate the handle to lock (**Figure 7**).
3. Pull the release handle forward, out and forward to hook on casting to unlock.
4. Pull the lock tester handle rearward to unlock (**Figure 7**).
5. After each attempt, verify that the fifth wheel is properly locked (**Figure 8 and 9**).
6. After unlocking, verify that the handle 'kicks off' the unlock notch and moves into the ready to couple position.

IMPORTANT: Before using your fifth wheel, visually inspect all components of fifth wheel for proper operation while coupling and uncoupling fifth wheel with lock tester.

IMPORTANT: DO NOT use any fifth wheel which does not operate properly.

⚠ WARNING Failure to repair an improperly operating fifth wheel could result in tractor trailer separation which, if not avoided, could result in serious injury or death.

After three (3) successful operational checks, your fifth wheel is ready for installation and return to operation.

Figure 7

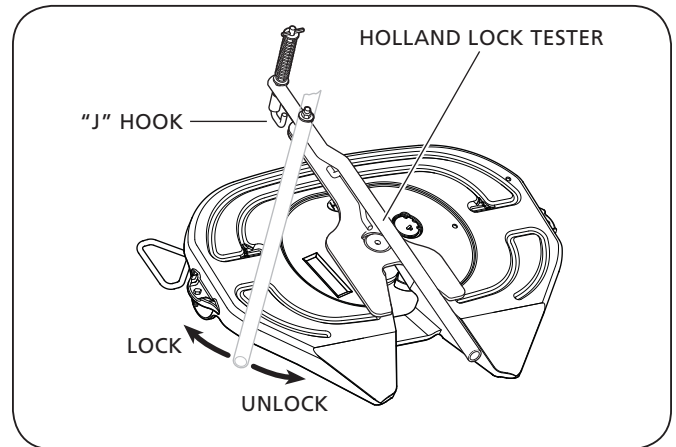

Figure 8

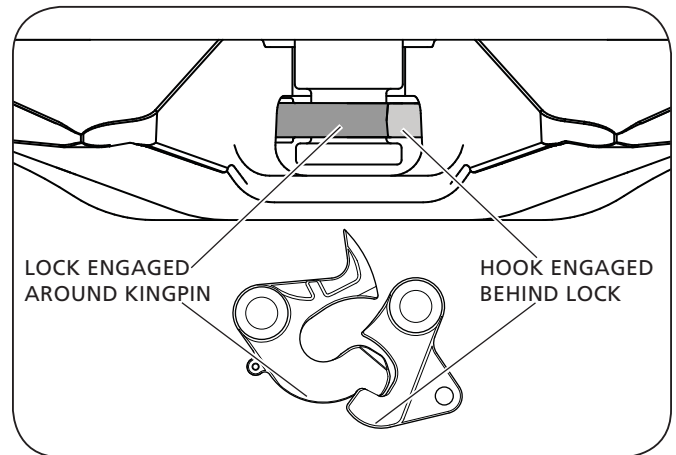
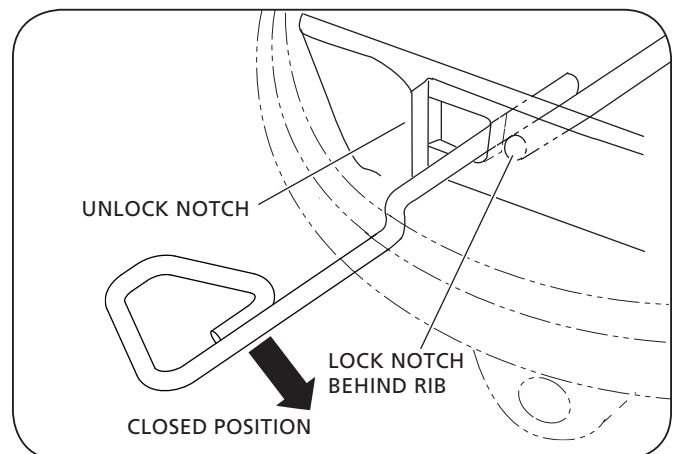

Figure 9



7. Top Plate Installation

1. If pocket inserts are dislodged from fifth wheel casting, clean pocket area of casting and apply a strip of double face tape in bottom of pockets. If tape is not available, use a general adhesive or silicone calk. Install pocket inserts by pressing them down into the pocket areas (**Figure 10**).
2. Using a lifting device capable of lifting 500 lbs. (227 kg), install fifth wheel top plate onto its mounting base.

NOTE: Follow instructions published by lifting device manufacturer for proper operation of lifting device.

3. Install bracket pins through fifth wheel casting and mounting base and secure by installing the bracket pins retention bolts and nuts (**Figure 11**). Torque retention bolts not to exceed 50-60 ft.- lbs. (68-81 N•m).

Figure 10

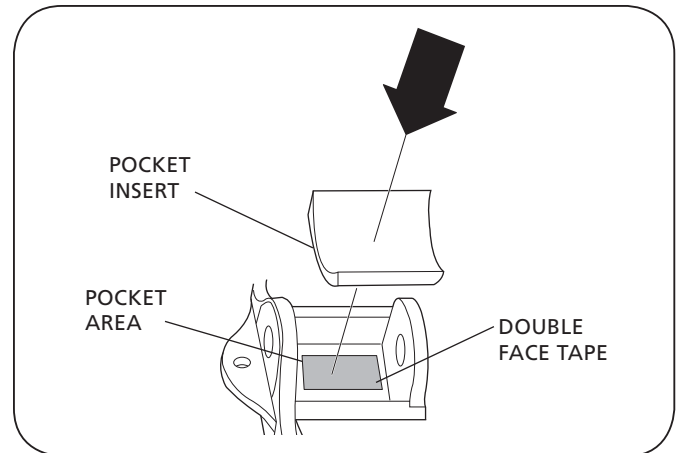
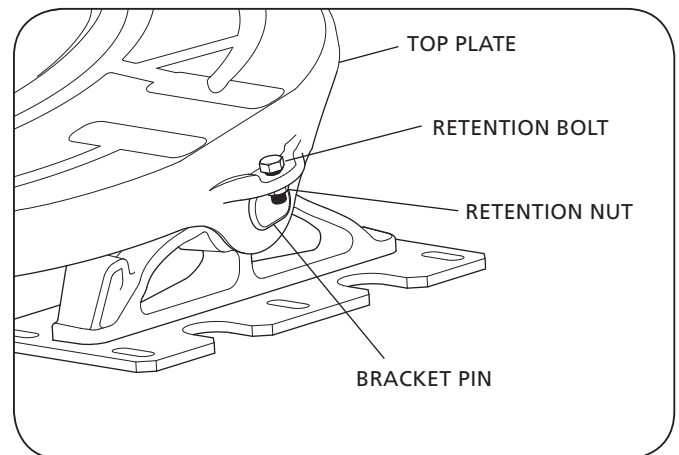

Figure 11





From fifth wheel rebuild kits to suspension bushing repair kits, SAF-HOLLAND Original Parts are the same quality components used in the original component assembly.

SAF-HOLLAND Original Parts are tested and designed to provide maximum performance and durability. Will-fits, look-alikes or, worse yet, counterfeit parts will only limit the performance potential and could possibly void SAF-HOLLAND's warranty. Always be sure to spec SAF-HOLLAND Original Parts when servicing your SAF-HOLLAND product.

SAF-HOLLAND USA • 888.396.6501 • Fax 800.356.3929
www.safholland.us

SAF-HOLLAND CANADA • 519.537.3494 • Fax 800.565.7753
WESTERN CANADA • 604.574.7491 • Fax 604.574.0244
www.safholland.ca

SAF-HOLLAND MEXICO • 52.1.55.5456.8641 • Fax 52.55.58162230
www.safholland.com.mx

info@safholland.com