



PH-T-60-AOS-L-8

PH-T-60-AOS-L-8 SPECIFICATIONS



Weight: 15 lbs.

WARNING Maintain adequate vertical (tongue) load to properly control the trailer (generally 10%) but do not exceed the above rated capacities.

TOWING APPLICATIONS:

Trailers and equipment designed for over-the-road towing within the stated capacities. Use **ONLY** with a non-swivel type drawbar. For off-road applications, reduce the above capacities by 25%. This pintle hook is well suited for use in the utility and construction industries.

DRAWBAR EYE DIMENSIONS:

2" to 3" I.D. with 1.25" to 1.62" diameter section.

MOUNTING:

1. Use a mounting structure of sufficient strength to support the rated capacity of the pintle hook in accordance with SAE J849 and SAE J847 respectively.
2. Use the hole pattern described on the reverse.
3. Remove cotter pin (XB-773), nut (XB-T-20-2), washer (XA-T-88), nuts (XB-758), lock washers (XB-T-45-1), bolts (XB-T-89) and both mounting brackets (XA-T-61-SF & XA-T-61-SR).
4. Install mounting brackets using bolts, lock washers and nuts provided. Be sure the front and rear mounting brackets are in the proper position and bolts are properly tightened.
5. Install pintle, washer and nut. Tighten nut to 20-25 ft-lbs torque, then back off as required to insert the cotter pin in the shank. Install and spread cotter pin.

OPERATING INSTRUCTIONS:

1. Before operating, inspect for proper operation, worn, damaged or missing parts and secure mounting. Correct as required before use.
2. Make sure the pintle hook is in the proper coupling position as shown above (latch on top).
3. Open latch (XA-T-62-O-1L-8) by removing cotter pin (A) and lifting lock (B).
4. Position drawbar eye over the horn of the pintle and lower into place.



Swivel Type Pintle Hook. Swivel action provides torsional relief at the coupling.

3,600 lbs. Maximum Vertical Load
18,000 lbs. Maximum Gross Trailer Weight

SAE J847 Information:

Type I - not applicable. Type II - 18,000 lbs.

WARNING **DO NOT** damage the latch. Be particularly careful with the drawbar when coupling or uncoupling.

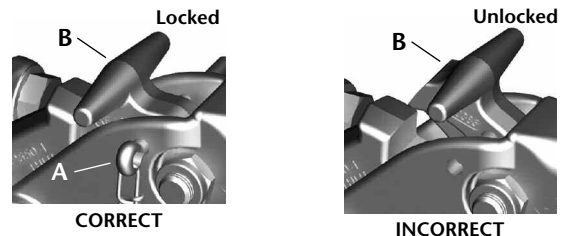

WARNING Other steps and inspections are also required. Consult OSHA and D.O.T. regulations and American Trucking Association for complete coupling and uncoupling procedures. These cover items such as cargo securement, brakes, lights, safety chains, and other important requirements.

5. Close the latch and insert cotter pin. Spread cotter pin to retain position.

MAINTENANCE:

For proper performance, the following maintenance steps should be performed every 30,000 miles or 3 months, whichever comes first.

1. Clean and check for proper operation. Inspect for worn, damaged or missing parts. Replace as required using only Holland parts.
2. Inspect, in particular, the coupling contact area and periodically disassemble to inspect for wear on the shank and mounting brackets. Replace any component when wear exceeds 1/8" (0.125") from the original surface profile.
3. Lubricate latch and lock pivots with a light oil lubricant. Apply a small quantity of grease through the grease fitting in the mounting bracket.
4. Check the mounting fasteners for proper torque. Retighten nut (XB-T-20-2) as instructed in Step 5, "Mounting".

GENERAL INFORMATION:

1. Do not modify or add to the product.
2. Wear safety goggles during installation, removal and servicing.
3. Never strike any part of the item with a steel hammer.
4. Do not weld on this product without written consent from the factory.



This product must not be used or maintained in a careless manner.

This product is covered by Holland's Commercial Products Warranty. Holland reserves the right, without giving prior notice, to change specifications and dimensions as designs are altered or improved.

PH-T-60-AOS-L-8

ALL DIMENSIONS SHOWN ARE NOMINAL

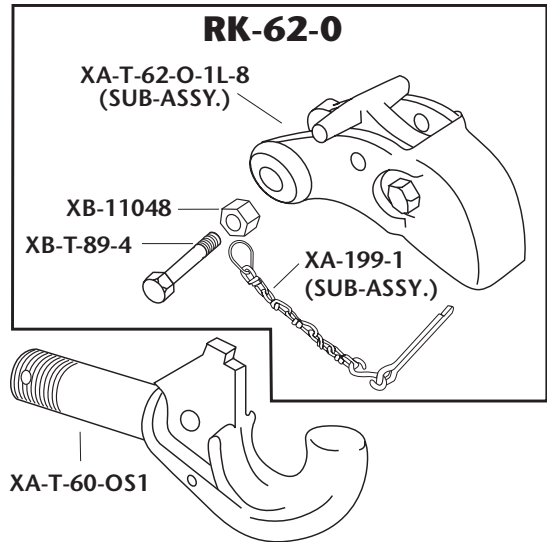
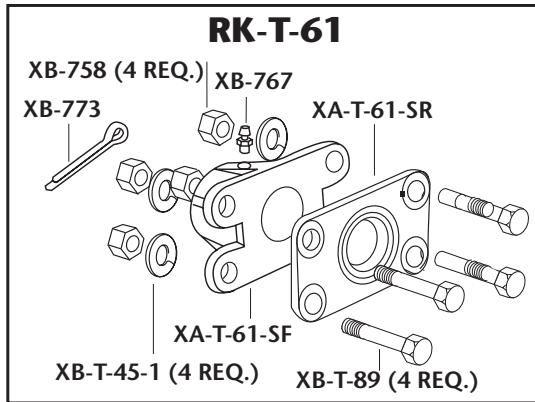
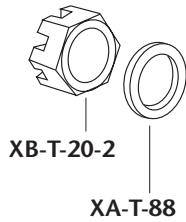
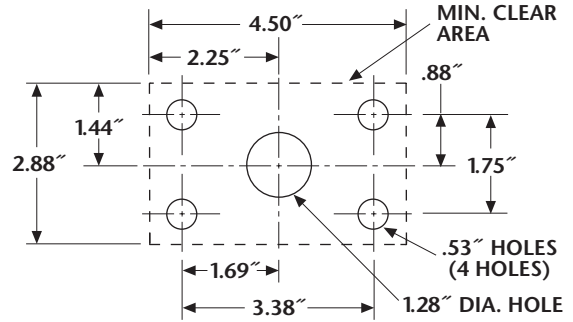
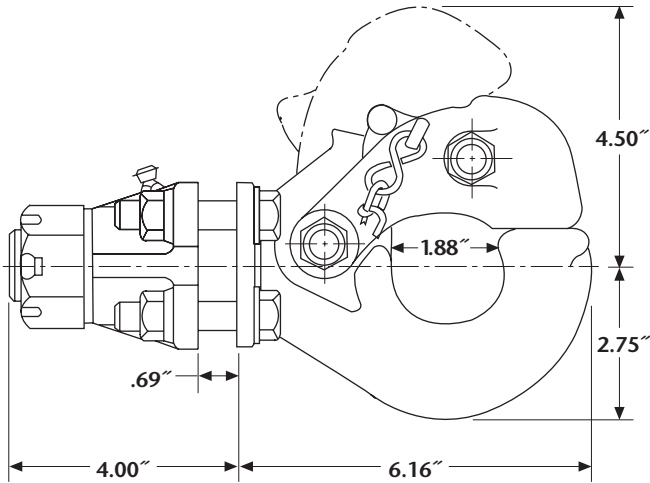

SAF-HOLLAND USA, Inc.
888.396.6501 Fax 800.356.3929

SAF-HOLLAND Canada Limited
519.537.3494 Fax 800.565.7753
Western Canada
604.574.7491 Fax 604.574.0244

SAF-HOLLAND International, Inc.
616.396.6501 Fax 616.356.1511