



FWOE70-02 ***FWOE70-03***



Fifth Wheel Operating Manual



WARNING

You must read and understand the instructions in this manual before operating your fifth wheel.

Failure to follow all of the important operating procedures contained in these instructions may result in a dangerous condition or cause a dangerous condition to develop.

These instructions apply to the proper operation of your fifth wheel only. There are other important checks, inspections, and procedures not listed here that are necessary, prudent, and/or required by law.

Table of Contents

	<u>Page</u>
1 Component Part Identification and Specifications	
1.1 Identification of component parts	2
1.2 Important specifications	2
2 Operating Instructions	
2.1 Pre-service inspection	3
2.2 Trailer coupling procedures	4-5
2.3 Trailer uncoupling procedures	5-6
3 Routine Inspection and Maintenance	
3.1 As Needed Lubrication	6
3.2 Required Inspections and Adjustments	
3.2.1 General fifth wheel inspection	7
3.2.2 Inspection of locking mechanism	7
3.2.3 Lock adjustment procedure	8

1 Component Part Identification and Specifications

1.1 Identification of component parts

NO.	PART NO.	QTY.	PART NAME
1	XA-1117-H	1	Release handle, primary
2A	XA-FW-104-D	1	Lock set replacement kit for 2,0" kingpin
2B	XA-FW-104-03	1	Lock set replacement kit for 3,5" kingpin
3	XA-FW-108-D-15	1	Lock pin, primary
4	XB-09153	1	Retaining ring
5	XB-H-38-A	1	Grease fitting
6	XA-08783	1	Release handle assembly, secondary
7	RK-65025	1	Secondary lock arm replacement kit
8	XB-16	1	Cotter pin
9	XA-1016-C	1	Lock pin, secondary
10	XB-0769	1	Grease fitting
11	XB-5	1	Cotter pin
12	XB-1028-2	1	Secondary lock spring
13	XA-1104	1	Locking plunger
14	XD-3123-1	1	Adjusting wedge
15	XB-09407	1	Socket Head Cap Screw (5/8"-11 x 4")
16	XB-HNH-58-C	1	Locknut (5/8"-11)
17	XB-403	1	Adjusting wedge spring
18	XB-1007	1	Locking plunger spring (red)
19	XA-1005-FH	1	Release arm
20	XB-2083	1	Hex Head Cap Screw (1/2"-20 x 1 3/4")
21	XB-T-49	1	Washer (1/2")
22	XB-02949	1	Bushing
23	XB-T-69-A	1	Locknut (1/2"-20)
24	XB-04473	1	Locknut (1" - 14)
25	XB-10327	1	Lock washer (1")

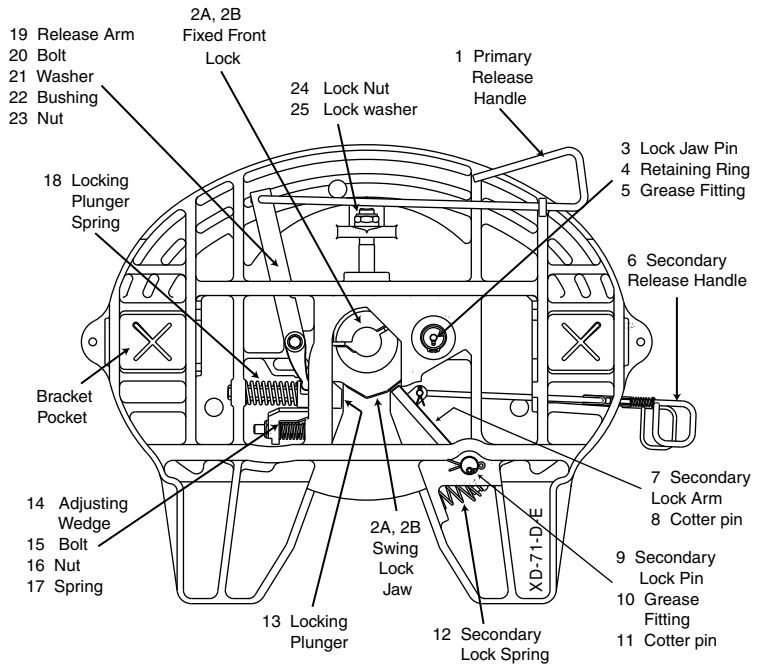

*Lock jaws and adjustment wedge are only sold as a complete lock set kit and cannot be ordered individually.

1.2 Important specifications



WARNING

The load limits given are valid for operation on paved roads and under conditions prevailing in Europe. For alternative conditions, please consult Holland Europe.

Mounting must be carried out in accordance with Holland instructions.

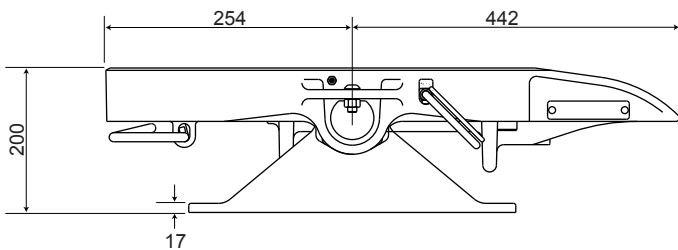
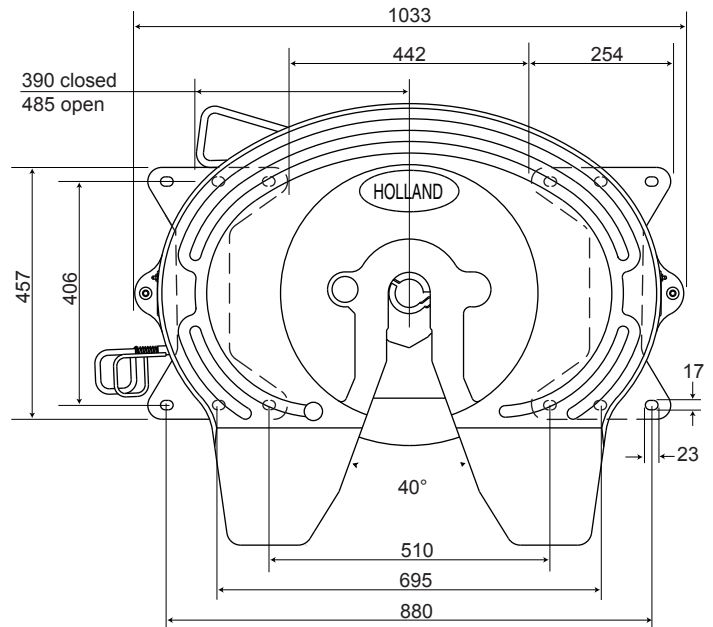

Part Number	Height	Vertical Load	D-Value	Weight	Locks
FW0E70-03-TP	top plate only	36000 kg	240 kN	148 kg	3.5"
FW0E70-02-TP	top plate only	30000 kg	170 kN	148 kg	2"
FW0E70-03-200	200 mm	36000 kg	240 kN	184 kg	3.5"
FW0E70-02-200	200 mm	30000 kg	170 kN	184 kg	2"

Holland Europe reserves the right, without prior notice, to change specifications and dimensions.

2 Operating Instructions

2.1 Pre-service inspection

- 1** Inspect the fifth wheel mounting

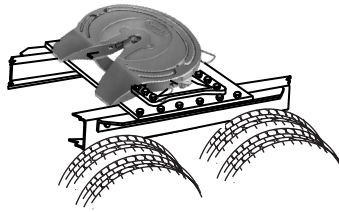

- Tighten loose fasteners with required torque
- Replace missing fasteners
- Repair/replace cracked components

- 2** Make sure coupling area is flat, level and clear of obstacles and persons

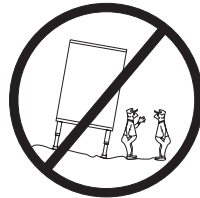

- 3** Lubricate the fifth wheel-to-trailer contact surface with grease

Tilt ramps down

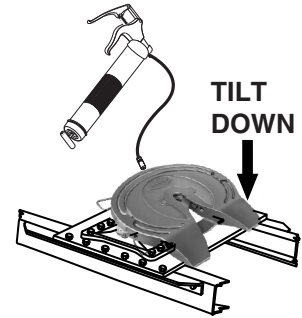

- 4** Make sure the locks are open

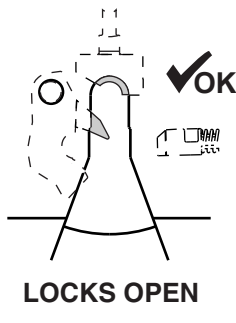

LOCKS OPEN

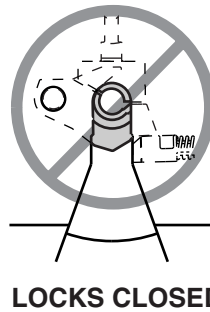

LOCKS CLOSED

If locks are closed:

FIRST, make sure **SECONDARY** lock is open:

- 1 grasp and pull inner handle
- 2 move handle down
- 3 pull handle out
- 4 lift handle up and hook handle "tab" on outer edge of casting

SECOND, make sure **PRIMARY** lock is open:

- 5 Pull handle straight out
- 6 lift up, and hook handle "tab" on edge of casting
- 7 Insert long bar into lock jaw opening and pry open lock jaws

To Open
SECONDARY Lock

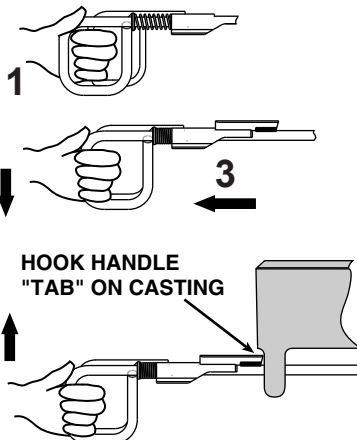

PRIMARY
Lock Handle

SECONDARY
Lock Handle

To Open
PRIMARY Lock

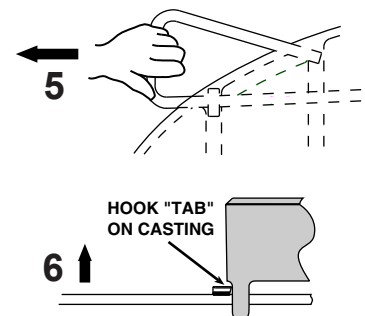

2 Operating Instructions

2.2 Trailer coupling procedures

- 1** Center kingpin with fifth wheel center

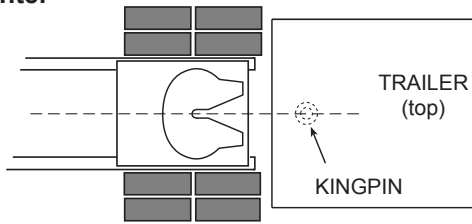

- 2** Back tractor close to trailer and **STOP**.

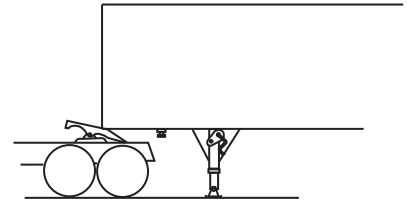

- 3** Chock trailer wheels
4 Connect brake lines and light cord
5 Support slack in lines to prevent interference
6 Set trailer brakes

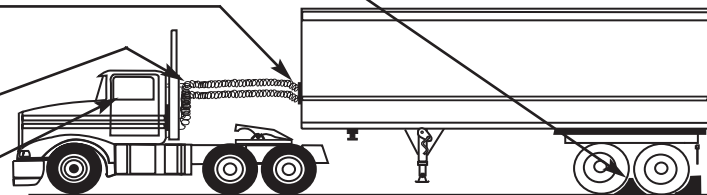

- 7** Adjust trailer height so fifth wheel will lift trailer. Trailer should contact fifth wheel 100 - 150 mm behind fifth wheel bracket pin.

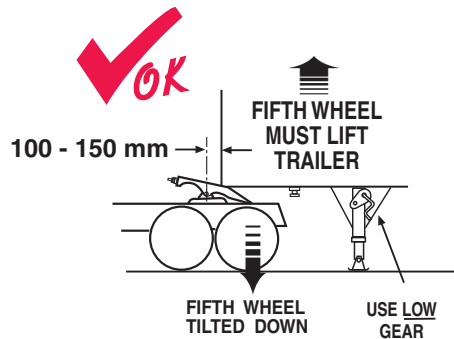

WRONG



- 8** **SLOWLY** back into trailer

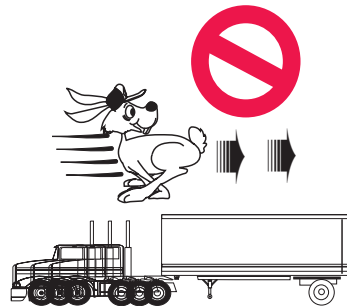
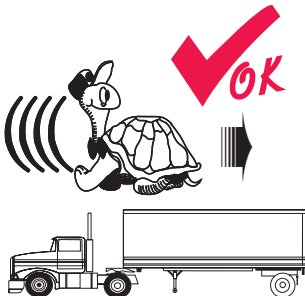

- 9** Do a pull test

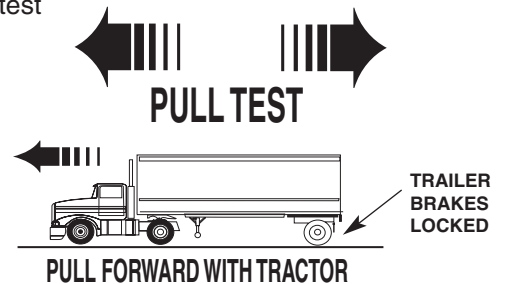

WARNING

The coupling procedure is not complete without a visual inspection. You must get out of the tractor and verify that the fifth wheel is properly coupled. Proceed to Step 9 on the following page for visual inspection procedures.

2 Operating Instructions

2.2 Trailer coupling procedures (continued)

10 Visual inspection

Get out of tractor

Visually check that the fifth wheel is locked
1 - 2 - 3

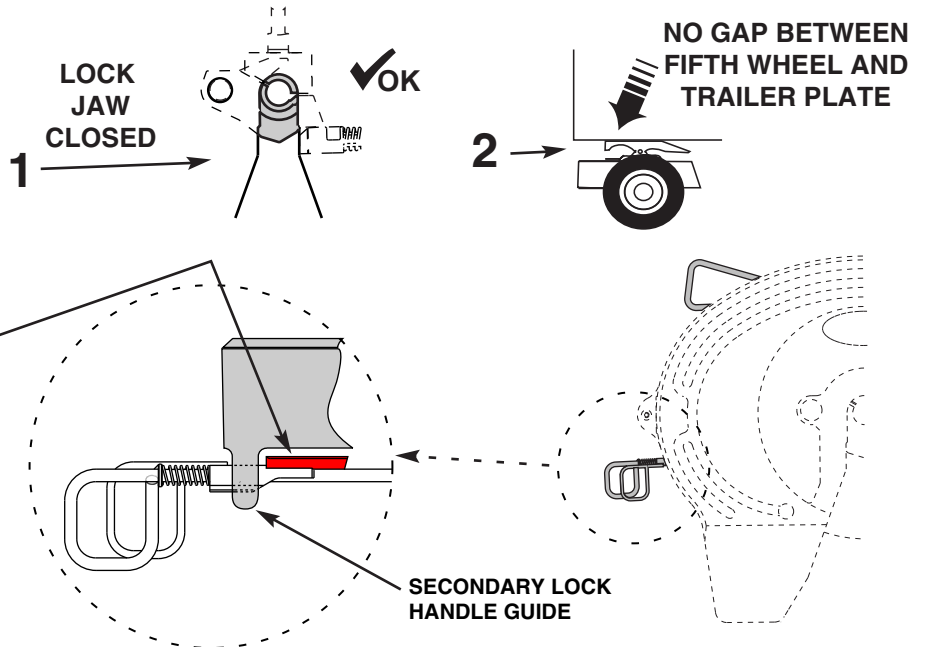

WARNING

Failure to properly couple and inspect this fifth wheel could result in tractor and trailer separation causing death or serious injury to others. If you do not obtain a proper couple, repeat the coupling procedure. **DO NOT USE ANY FIFTH WHEEL THAT FAILS TO OPERATE PROPERLY!**

11 Retract landing gear until pads come off the ground

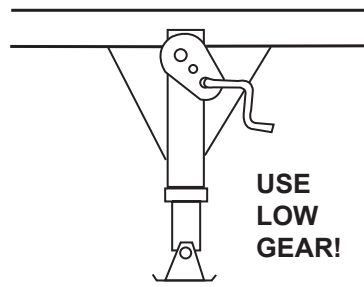

12 Switch to high gear, fully retract, then secure crank handle

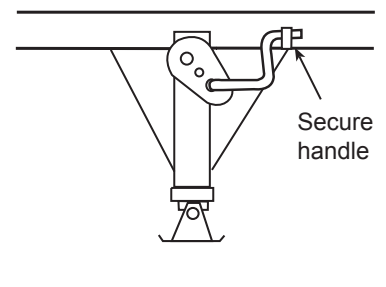

13 Re-check brake lines and light cord. Remove wheel chocks, continue with pre-trip inspection.

2.3 Trailer uncoupling procedure

1 Position tractor and trailer on firm, level ground clear of obstacles and persons

2 Set trailer brakes

3 Slowly back tractor tightly against trailer

4 Set tractor brakes

5 Chock trailer wheels

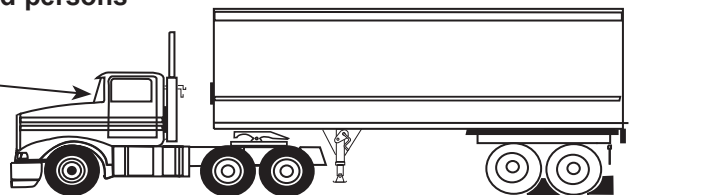

2.3 Trailer uncoupling procedure (continued)

- 6** Extend landing gear until pads just touch the ground

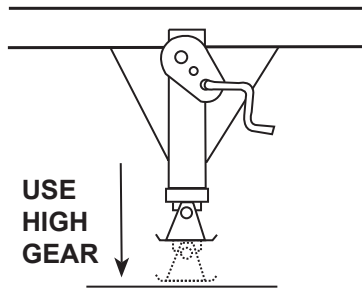

- 7** Switch to low gear and crank an additional 4 - 8 turns

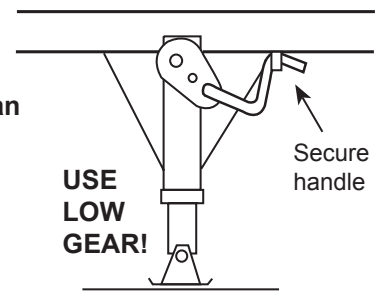

- 8** Unlock fifth wheel.

First open secondary lock:

- 1 grasp and pull inner handle
- 2 move handle down
- 3 pull handle out
- 4 lift handle up and hook handle "tab" on outer edge of casting

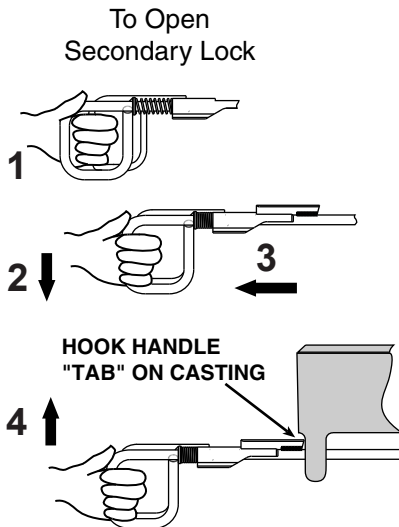

Second, open primary lock:

- 1 pull handle straight out
- 2 lift handle up and hook handle "tab" on outer edge of casting

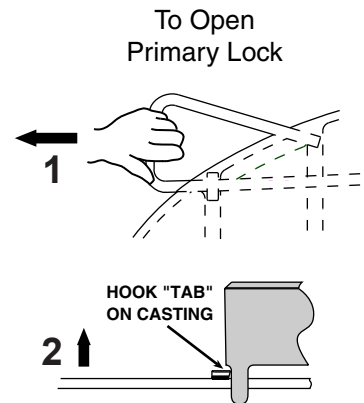

3 MAINTENANCE PROCEDURES

3.1 As needed lubrication

NOTE: Maintain adequate lubrication on the following surfaces by inspecting and re-lubricating at regular intervals. Use a water-resistant, lithium grease.

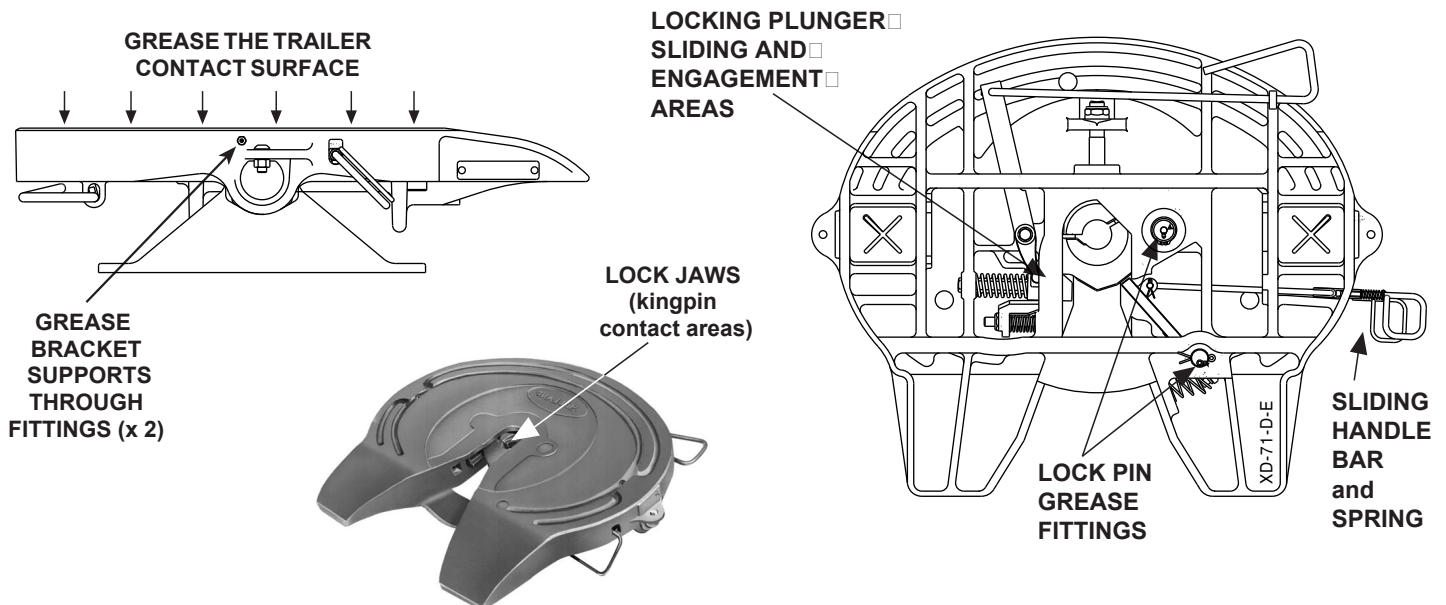

3.2 Required Inspections and Adjustments

NOTE: Perform the following every three (3) months or 50,000 km, whichever comes first. Thoroughly steam clean all components before inspecting or adjusting.

3.2.1 General Fifth Wheel Inspection

Inspect the fifth wheel mounting and fifth wheel assembly

- Tighten loose bolts and fasteners with required torque
- Replace missing or damaged bolts
- Replace bet, worn, or broken parts

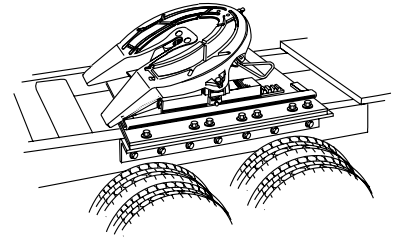

Use only genuine Holland parts kits

3.2.2 Inspection of Locking Mechanism

NOTE: Perform the following every three (3) months or 50,000 km, whichever comes first. Thoroughly steam clean all components before inspecting or adjusting.

- 1 Verify the proper operation of the fifth wheel by locking and unlocking the fifth wheel locks using Holland Kingpin Lock Tester TF-TLN-1000 or TF-TLN-5001.

TO
LOCK

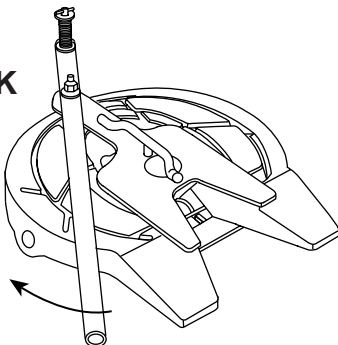

- 2 Set tool on fifth wheel and rotate handle

TO
UNLOCK

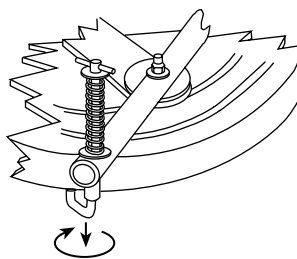

- 3 Push down and rotate the "J" hook under the fifth wheel, then pull handle back

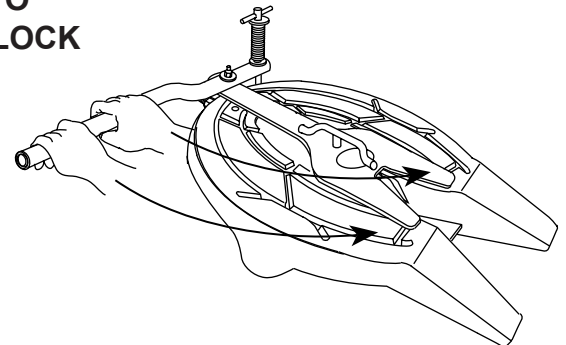

- 4 After each attempt, verify that the fifth wheel is properly locked as shown below.



WARNING

If you do not obtain a proper couple, repeat the coupling sequence.
DO NOT USE ANY FIFTH WHEEL THAT FAILS TO OPERATE PROPERLY.

3 MAINTENANCE PROCEDURES

3.2 Required Inspections and Adjustments

3.2.3 Lock Adjustment Procedure

- 1** Using Holland TF-TLN-5001 Lock Adjustment Tool, lock the fifth wheel and verify that it is closed as shown in Step 10 on Page 5.
- 2** Using a socket wrench with a 1/2" Allen hex bit socket, tighten the lock by turning the lock adjustment bolt clockwise 1/4 turn at a time. Remove the socket wrench from the bolt and rotate the tool as shown to check for resistance between the tool and lock.
- 3** Continue to alternate tightening (clockwise) the adjustment bolt 1/4 turn at a time, until the fifth wheel lock is tight against the kingpin in the lock tester.

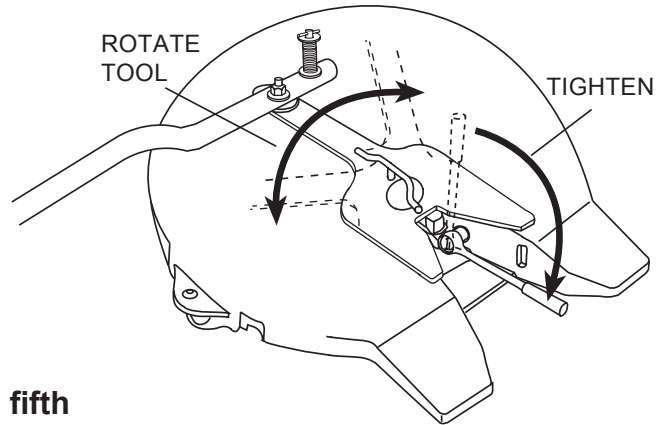

WARNING

At this point the fifth wheel is **OVER-ADJUSTED** and **NOT** usable. The remaining adjustment procedures must be completed.

- 4** Loosen the adjustment bolt (counter-clockwise) 1 1/2 turns. The lock is now properly adjusted.
- 5** Verify the proper adjustment by locking and unlocking the fifth wheel several times with the lock tester. On each attempt, make sure the locks properly engage.



WARNING

Improper adjustment can cause improper locking of the fifth wheel. If the fifth wheel does not operate properly, **DO NOT USE IT!** Repeat the adjustment procedures or contact Holland Europe.

Copyright © June 2004 • The Holland Group Inc.



The Holland Group, Inc.
Holland, MI 49423
United States
Phone: (616) 396-6501
Fax: (616) 396-1511



Holland Europe GmbH
Altenkamp 9
D-33758
Schloss Holte-Stukenbrock
Germany
Phone: +49 (0) 5207-89560
Fax: +49 (0) 5207-895656

Holland Eurohitch Ltd.
Hoo Farm Industrial Estate
Worcester Road
Kidderminster
Worcestershire
DY11 7RA
Phone: +44 (0) 1562-732010
Fax: +44 (0) 1562-732020

Holland Hitch (Aust.) Pty. Ltd.
Melton, Victoria, Australia
Phone: 61-(0)3-9743-6799
Fax: 61-(0)3-9747-9617

Holland Transtrade
(Thailand) Company, Ltd.
Bangkok, Thailand
Phone: 66 (0)2-513-8758
Fax: 66 (0)2-513-8757

Nippon Holland, Ltd.
Tokyo, Japan
Phone: 81-(0)3-3461-9130
Fax: 81-(0)3-3463-1407

Holland Transtrade
Far East SDN BHD
Shah Alam, Malaysia
Phone: 60 (0)3 734-2888
Fax: 60 (0)3 736-5588