

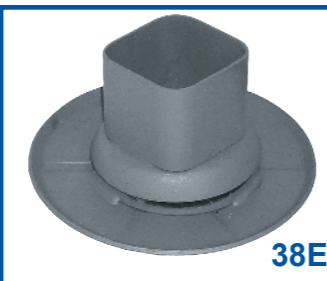

MARKV

GO THE DISTANCE.

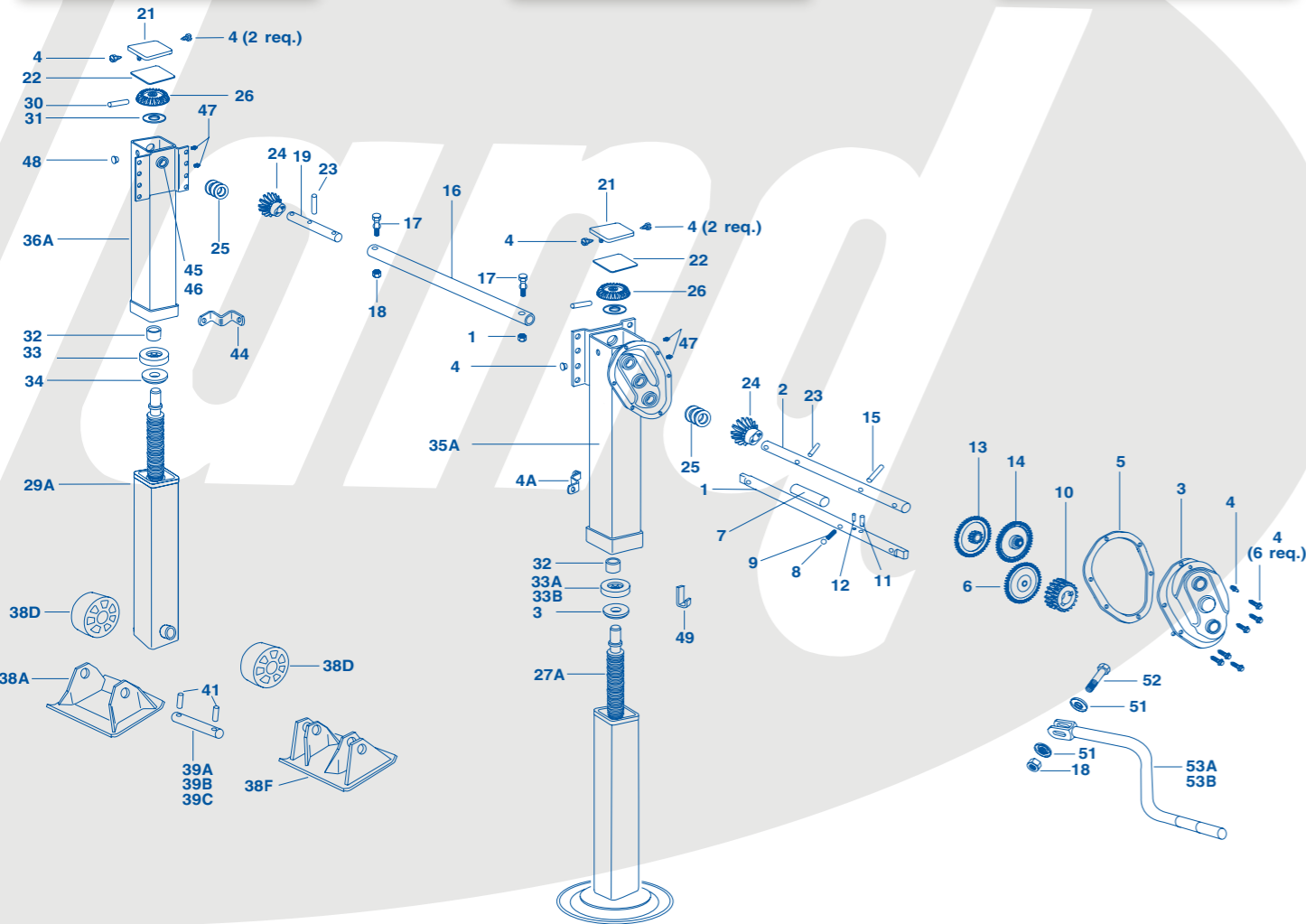
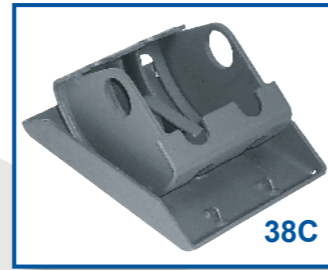
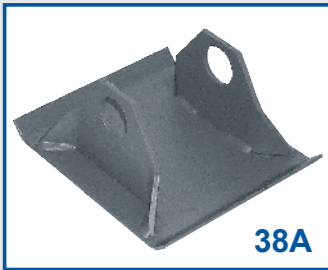

LANDING GEAR PARTS

Item	Description	Qty	Item	Description	Qty
1	XAV06625A	Crankshaft	34	XAV06629	Collar
2	XAV06624A	Drive gear shaft	35A	Not available seperately	
3	XAV06618	Gearbox cover assembly	36A	Not available seperately	
4	XB06372	Thread rolling screw	38A	XAV796WS	Weight saver skid foot, 3.8" x 10"x 11.5"
5	XBV06621	Gearbox gasket	38B	XAV818R	Rocker foot
6	XAV066602	Idler ear	38C	RKE1091	Compensating foot
7	XAV07085	Idler gear shaft	38D	XBV747	Wheel
8	XBPP002301	Ball	38E	N/A	Self leveling foot
9	XBPP002002	Spring	38F	XAV796T	Heavy duty skid foot
10	XAV066041	Shifter gear	39A	RKV19011	Axle kit - suits skid & compensation foot
11	XACRPV06633	Pin, 25" x 1.44"	39B	RKV19014	Axle rocker foot
12	XB21S2181250	Spring pin, 22"x 1.25"	39C	RKV19012	Axle wheel
13	XAV06606	Spur gear	39D	XAV19013	Axle kit - Heavy duty skid foot
14	XAV06603	Step gear	41	XB21S3753000	Rollpin .38" x 3"
15	XACRPV06634	Pin, 38" x 1.5"	44	XAV1938	Ear brace
16	XAV1910	Cross shaft	45	XBLG0559	Bearing
17	XBV4441	HHCS, 3/8" - 16	46	XBLG1570	Retainer
18	XB338	Locknut, 3/8"-16 x 1.75"	47	XB767	Lube fitting
19	XAV06623A	Bevel pinion gear	48	XB01789	Plastic plug
21	XAV06611	Upper leg cover	49	XAV1914	Crank hanger
22	XBV07054	Gasket	51	XB1108	3/8" SAE washer
23	XB02065	Groove pin	52	XBH332	HHCS, 1/4"-28 x 3"
24	XAV06600	Bevel pinion gear	53A	XAV902A	Crank Handle Short
25	XB01977	Shim	53B	XAV9010A	Crank Handle Long
26	XAV06601	Bevel gear	*54	XAV85	Lever
27A	XAV066280101	Inner leg & screw assy.	*55	XBV932	Spring
29A	XAV066280000	Inner leg & screw assy.	*56	XBV06622	Bushing retainer -open
30	XACRPV06635	Pin, 38" x 2"	*57	XBV07082	Bushing, retainer -closed end
31	XBV06632	Washer	*58	XBLG065801	Bushing, shifter
32	XBV06630	Bushing	*59	XB60066	Spring, Compensating Foot used in 38C
33	XBV647	Thrust bearing			

* Items not shown