

NEW

SAF SBS 1918 H0

SERIES PRODUCTION OF THE NEW TRAILER DISC BRAKE SAF SBS 1918 H0 FROM JUNE 2015

SAF-HOLLAND is launching the lightest adaptable 19.5" disc brake currently available for the 9t axle range.

From the 3rd quarter of 2015, it will replace the 19.5" brakes used up to now as the standard for 9t axles.

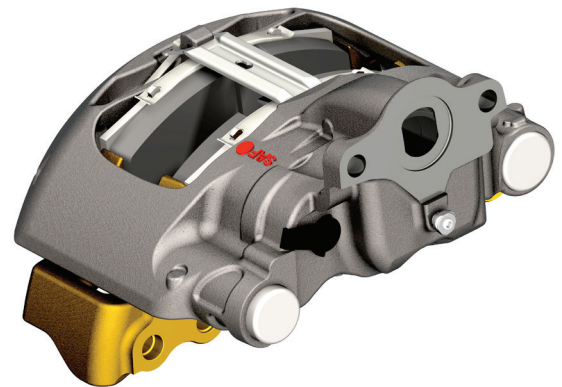

New axle models	Existing axle model	
RIGID AXLES		
B19 - 19S	B19 - 19W	B19 - 19K
B9 - 19S	B9 - 19W	B9 - 19K
SI9 - 19S	SI9 - 19W	SI9 - 19K
ZI9 - 19S	ZI9 - 19W	ZI9 - 19K
FRICTION-STEERED AXLES FOR INTRA CD AND MODUL*		
BIL9 - 19S	BIL9 - 19W	BIL9 - 19K
BL9 - 19S	BL9 - 19W	BL9 - 19K
FRICTION-STEERED AXLES FOR INTRA		
BILL9 - 19S	BILL9 - 19W	BILL9 - 19K
BLL9 - 19S	BLL9 - 19W	BLL9 - 19K

* With steering axles the use of the new brakes may cause a change in the possible steering angle. This must therefore be checked when changing to the new brakes

OVERVIEW

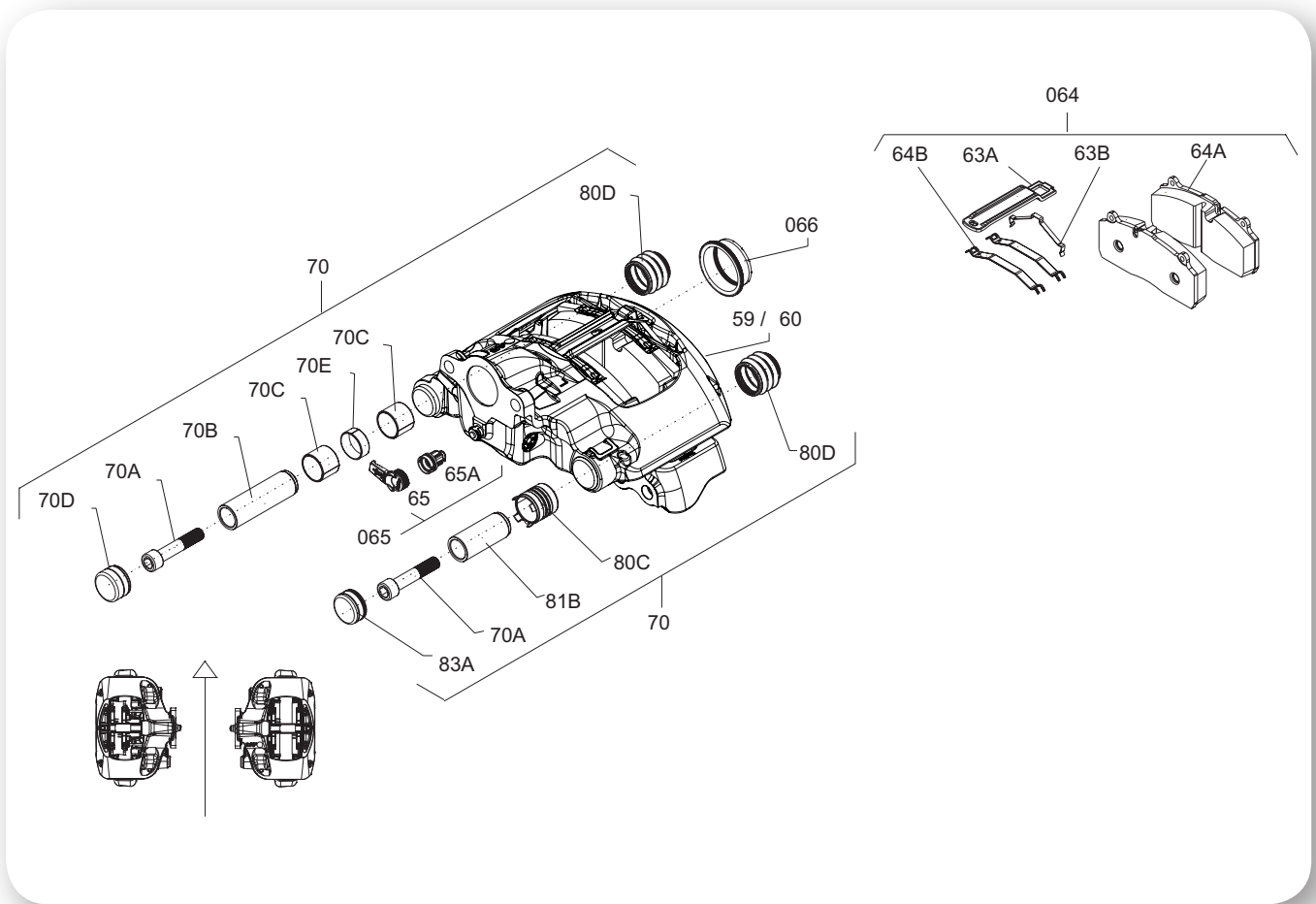

Order no.	Description	Position
03 080 0085 00	Disc brake caliper-Kit - LH	59
03 080 0086 00	Disc brake caliper-Kit - RH	60
03 057 0014 00	Repair-Kit Pad	064
03 434 3863 00	Repair-Kit	066
03 434 3861 00	Repair-Kit seal	70
03 434 3862 00	Univ. adjuster cap	065

Die Stückliste und Explosionszeichnung für SAF SBS 1918 H0 sind bereits auf unserem POD „Parts on demand“ zu finden.

SAF-HOLLAND GmbH

Business Unit Aftermarket · Hauptstraße 26 · 63856 Bessenbach · Germany · Tel +49 6095 301-301

www.safholland.com

SAF-Holland
ORIGINAL PARTS