

Rebuild Kit Instructions

Electronic Lock Indicator Technology (ELI-te™) RK-12131AU

- For XA-351 and XA-331 Series Fifth Wheel Top Plates

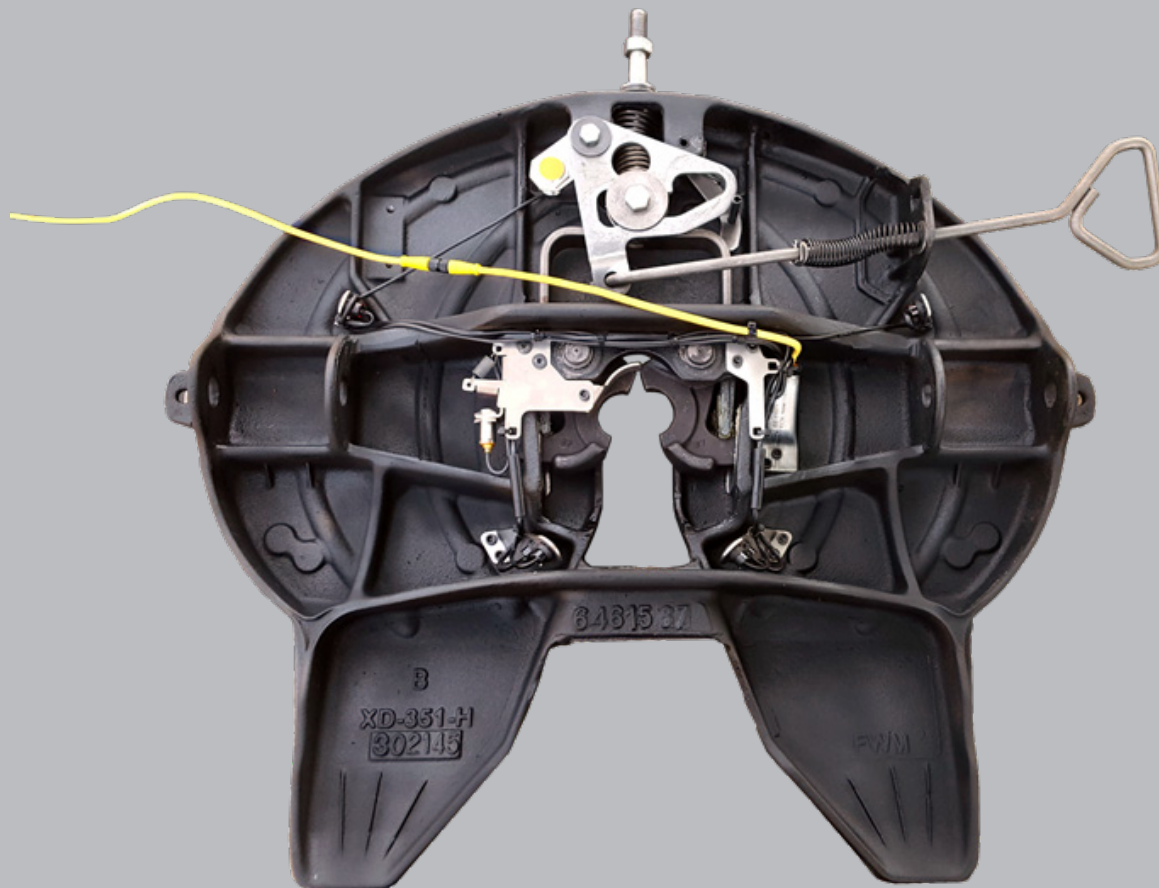



Contents	Page
Introduction.....	2
Notes, Cautions, and Warnings.....	2
Section 1 – General Safety Instructions.....	3
Section 2 – Model Identification.....	3

Contents	Page
Exploded View and Parts List.....	4
Section 3 – Top Plate Removal.....	5
Section 4 – ELI-te Installation.....	6
Section 5 – Cable Tie Installation.....	8
Section 6 – Top Plate Installation.....	10

Introduction

This manual provides procedures for installing the Electronic Lock Indicator System Technology Enhanced (ELI-te) for Holland fifth wheels. See page 3 for exact model identification.

NOTE: For HOLLAND® replacement components contact SAF-HOLLAND Customer Service: 1300 131 613

Notes, Cautions, and Warnings

You must read and understand all of the procedures presented in this manual before starting work on any Electronic Lock Indicator System (ELI-te) for the HOLLAND® series fifth wheels.

IMPORTANT: Keep this manual in a safe location for future reference.

Proper tools must be used to perform the maintenance and repair procedures described in this manual.

NOTE: This manual is written based on the assumption that all applicable safety regulations are followed by the location where work is performed.

Throughout this manual, you will notice the terms “NOTE,” “IMPORTANT,” “CAUTION,” and “WARNING” followed by useful product information. So that you may better understand the manual, those terms are defined as follows:

NOTE: Includes additional information to enable accurate and easy performance of procedures.

IMPORTANT: Includes additional information that, if not followed, could lead to hindered product performance.

CAUTION Used without the safety alert symbol, indicates a potentially hazardous situation which, if not avoided, could result in property damage.

CAUTION Indicates a potentially hazardous situation which, if not avoided, could result in minor or moderate injury.

WARNING Indicates a potentially hazardous situation which, if not avoided, could result in death or serious injury.

1. General Safety Instructions

Read and observe all Warning and Caution hazard alert messages in this publication. They provide information that can help prevent serious personal injury, damage to components, or both.

The Electronic Lock Indicator System Technology Enhanced (ELI-te) installation must be performed by a trained technician using proper tools and safe procedures

IMPORTANT: The Electronic Lock Indicator Technology Enhanced (ELI-te) is a tractor-trailer fifth wheel coupling aid and is intended as an additional safety check to assure the driver of a safe and complete coupling. It does not eliminate the requirement for a visual inspection of the fifth wheel. Always get out of the tractor cab and visually inspect the fifth wheel coupling before proceeding.

IMPORTANT: Prior to operation of the fifth wheel you must be thoroughly satisfied that the fifth wheel has been properly installed on the vehicle.

⚠ WARNING Failure to properly install, the fifth wheel may result in tractor trailer separation which, if not avoided, could result in death or serious injury.

Refer to SAF-HOLLAND Installation Manual FW-21-6A (available on the Internet at www.safholland.com.au) for proper installation procedures.

We recommend only the use of HOLLAND® Original Parts. A list of SAF-HOLLAND technical support locations to supply SAF-HOLLAND® Original Parts can be found at www.safholland.com.au or contact our customer service group at 1300 131 613.

Updates to this manual will be published as necessary on the Internet at www.safholland.com.au

2. Model Identification

This manual contains retrofit procedures for installing an Electronic Lock Indicator (ELI-te) on the 351 Fifth Wheel Top Plate (XA-351 Series, **Figure 1**), and for the LowLube Fifth Wheel Top Plate (XA-331 Series, **Figure 2**)

Figure 1

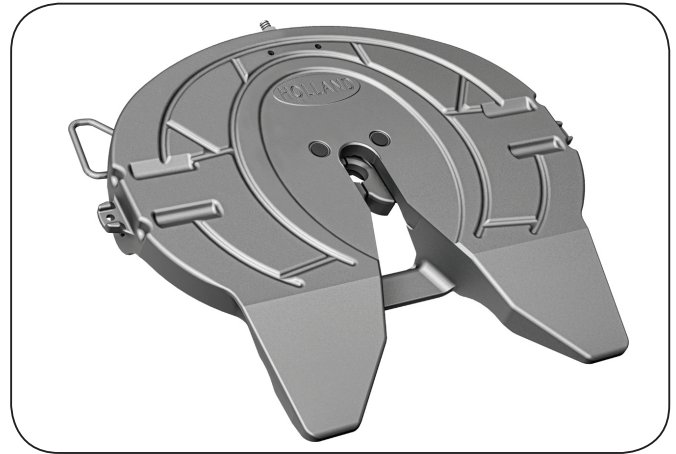
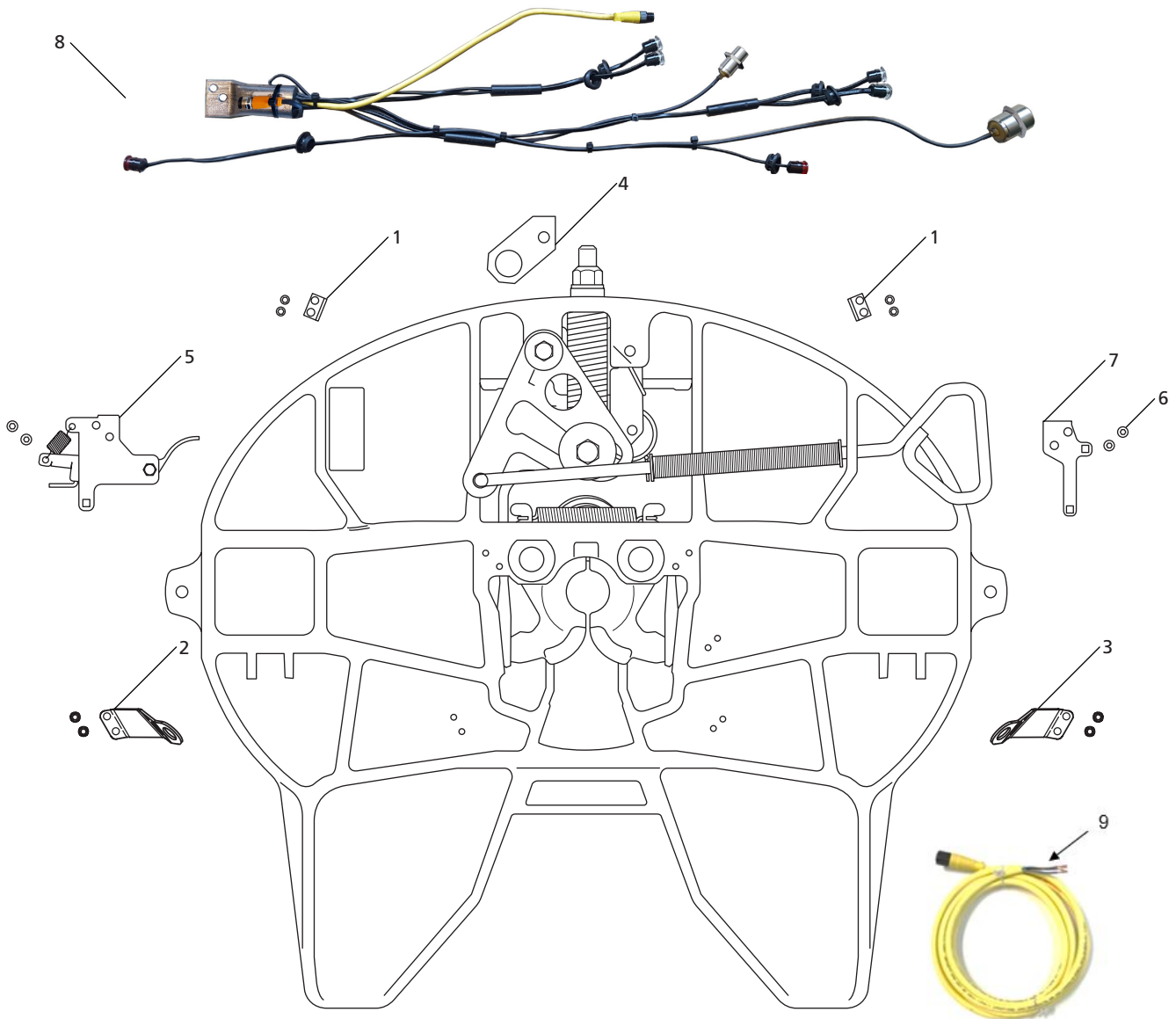

Figure 2



Exploded View and Parts List

The contents of RK12131AU are outlined below. Note that individual parts comprising the kit are not available for separate purchase. The exception to this is Item 9, the power extension cable, which is available under part number: RK120150



ITEM	DESCRIPTION	QTY.
1	Bracket, Indicator Light	2
2	Bracket, Inspection Light, Left	1
3	Bracket, Inspection Light, Right	1
4	Bracket, Cam Sensor	1
5	Sensor Flag Assembly, Kingpin	1
6	SCHS, 5/16"-18 x 1/2" LG	14
7	Bracket, Wire Mount	1
8	Coupling Monitor Assembly	1
9	Power extension cable (RK120150)	1

3. Top Plate Removal

NOTE: Some fifth wheel assemblies have replaceable pocket inserts installed between the fifth wheel top plate and mounting base. Take care when removing the fifth wheel top plate not to lose pocket inserts.

CAUTION Failure to prevent pocket inserts from falling out of the top plate could cause a potentially hazardous situation which, if not avoided, may result in minor or moderate injury

1. If fitted, remove bracket pin retention bolts and nuts from both sides of fifth wheel top plate (**Figure 3**). Using a pry bar, pull bracket retention pins out of fifth wheel top plate
2. Using a lifting device capable of lifting 500 lbs (227 kg), remove the top plate from the mounting base. Place the fifth wheel upside down on a flat, clean working area.

NOTE: Follow instructions published by lifting device manufacturer for proper operation of lifting device.

3. It is recommended that installers use a SAF-HOLLAND® fifth wheel rebuild stand (**Figure 4**) (part number: TF042291) and 2" (50 mm) fifth wheel lock adjustment tool (**Figure 5**) (part number: TLN5001) when installing ELI-te components.

Figure 3

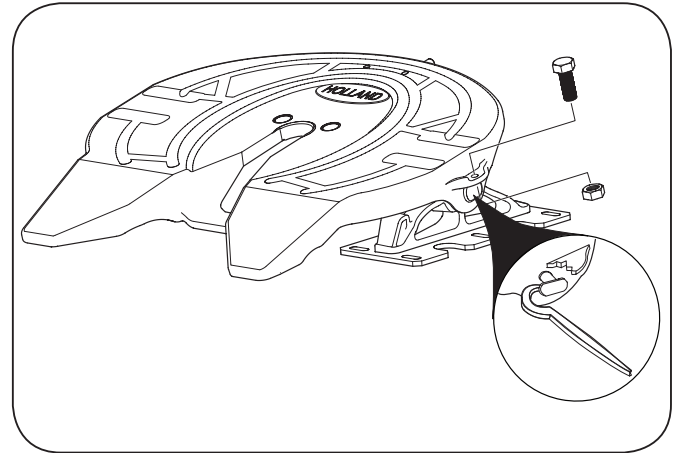

Figure 4

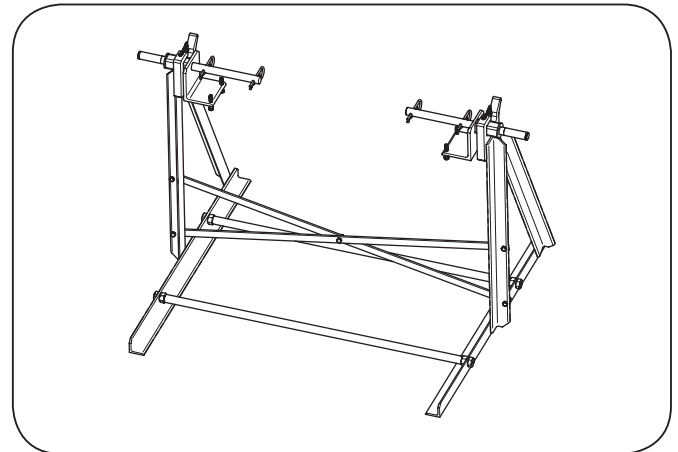
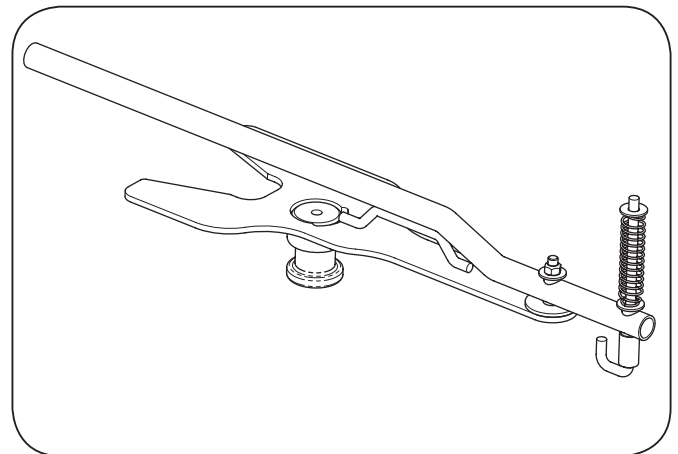

Figure 5



4. ELI-te Installation

NOTE: These instructions assume that the fifth wheel has already been drilled to facilitate the ELI-te component installation.

If the fifth wheel has not been drilled, contact SAF-HOLLAND to obtain an ELI-te drilling kit and set of drilling instructions.

1. Kingpin Sensor Flag Installation: Assemble the kingpin sensor flag assembly to the fifth wheel with two (2) bolts torqued to 22 ft-lbs (30 Nm) (**Figure 6**).
2. Warning Light Bracket Installation: Install (2) brackets using four (4) bolts. Torque to 22 ft-lbs (30 Nm) (Components of fifth wheel not shown for clarity) (**Figure 7**).
3. Inspection Light Bracket Installation: Install the left- and right-side brackets using four (4) bolts. Torque to 22 ft-lbs (30 Nm). (Components of fifth wheel not shown for clarity) (**Figure 8**).
4. Wire Mount Bracket Installation: Install the bracket using two (2) bolts. Torque to 22 ft-lbs (30 Nm). (Components of fifth wheel not shown for clarity) (**Figure 9**).

Figure 7

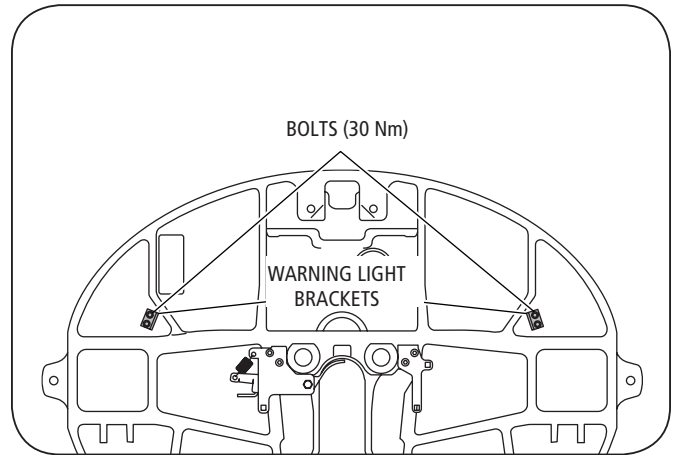

Figure 8

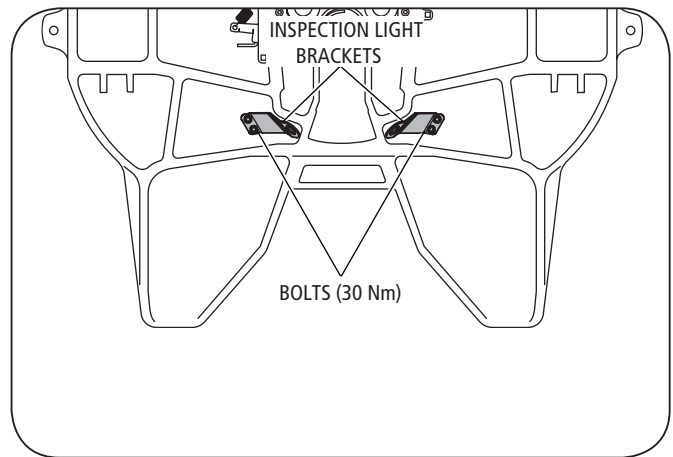

Figure 6

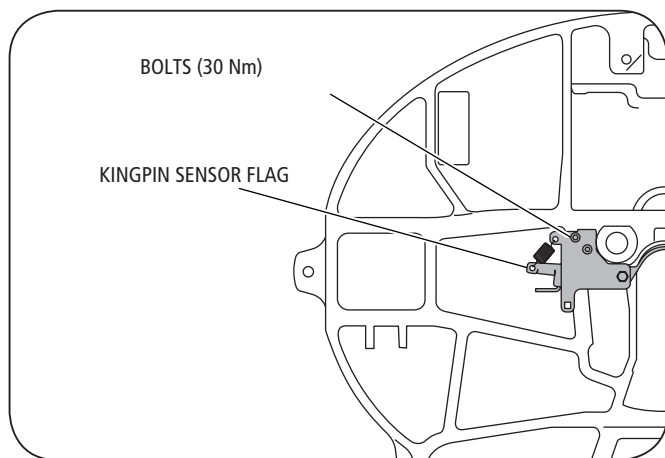
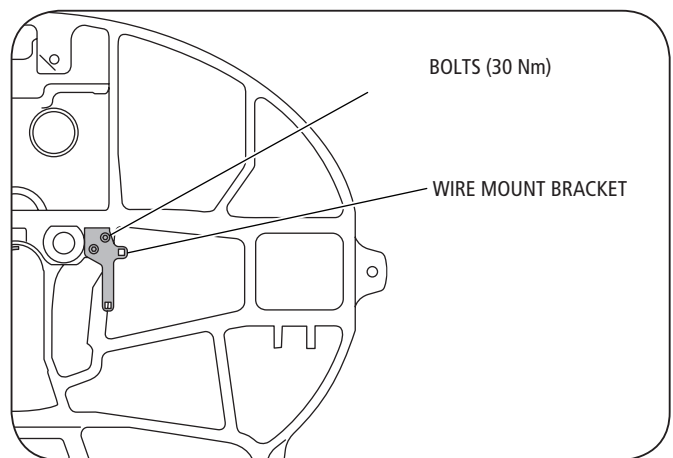

Figure 9



SAF-HOLLAND Group

5. Cam Sensor Bracket Installation: Install the cam sensor bracket to the casting using the cam pivot bolt. Torque to 65 ft-lbs (360 Nm) (Figure 10).
6. Coupling Monitor Assembly Installation: Install the logic box enclosure (attached to the main wiring harness) using two (2) bolts. Torque to 22 ft-lbs (30 Nm). (Components of fifth wheel not shown for clarity) (Figure 11).
7. Install the two (2) roadside red LEDs into the warning light brackets. Install grommet into light bracket, then pull light through bracket. Secure the roadside red LED cable to the bracket using one (1) cable tie (Figure 12).
8. Install the wire harness to the brackets in the following order. Install the two (2) roadside white LED's in the left- and right-side brackets by pulling the retaining boot backwards off the LED, passing both the LED and the boot through the mounting hole in the bracket, pulling the boot back over the LED and pressing it into place on the bracket. Secure the two (2) roadside white LED cables to the inspection light brackets using one (1) cable tie. Secure the two (2) cables from the white LED cables to the wire mount bracket with one (1) cable tie. Install the two (2) red LED lights into the warning light brackets. Secure the red LED cables to the brackets using two (2) cable ties.
9. Secure the five (5) cable ties coming from the logic box as well as the roadside red LED cable to the top of the wire mount bracket with two (2) cable ties. Move the yellow vehicle power cable out of the way.
10. Secure the four (4) cable ties traveling to the curbside of the wheel with one (1) cable tie next to each lock pin. DO NOT include the yellow power cable in these bundles.
11. Secure the four (4) cables to the kingpin sensor flag using one (1) cable tie.
12. Install the cam sensor into the cam sensor bracket at the top of the wheel. Use Loctite 243 (blue) on the threads of the sensor where the nut contacts to ensure the nut is secure.
13. Secure the remaining two (2) cables for the white curbside LED's and kingpin sensor to the bottom of the kingpin sensor flag.
14. Install the kingpin sensor into the kingpin sensor flag. with the orange face of the sensor facing the kingpin flag. Use Loctite 243 (blue) on the threads of the sensor where the nut contacts to ensure the nut is secure.

NOTE: Kingpin sensor flag should have close contact to the cam.

Figure 10

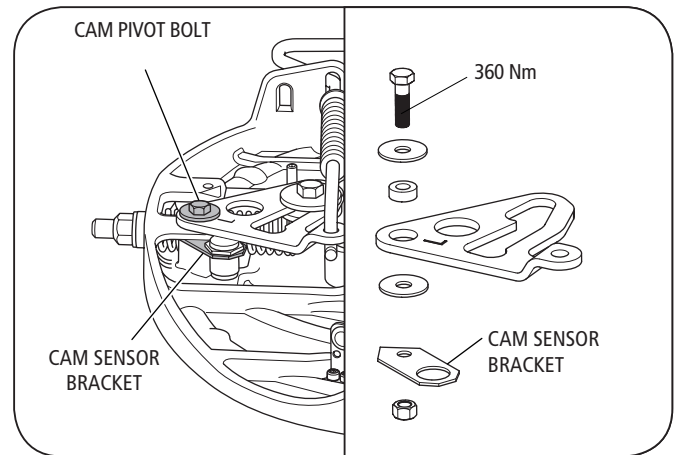

Figure 11

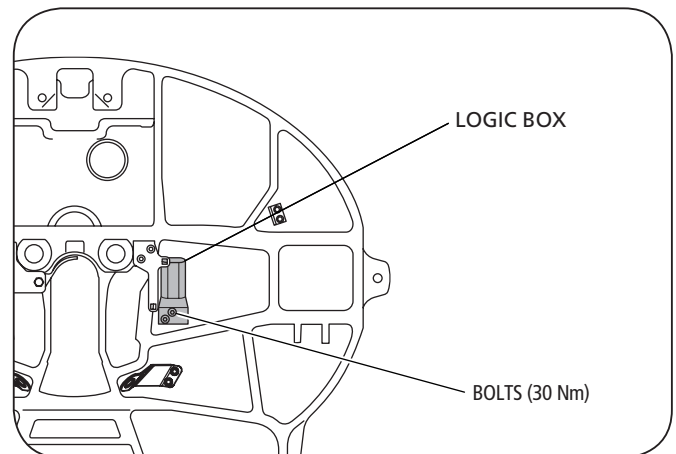
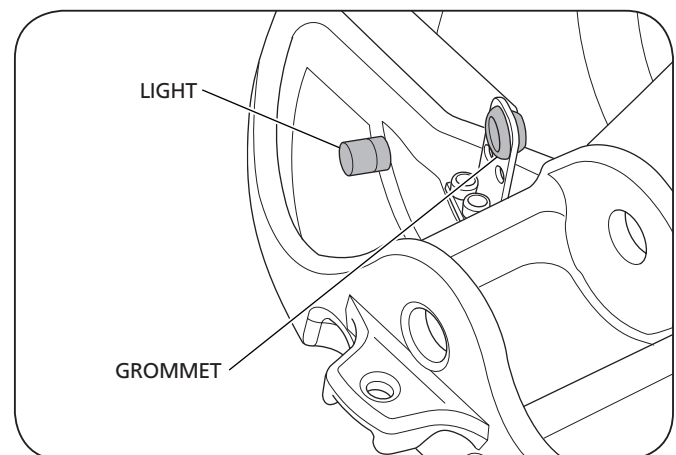
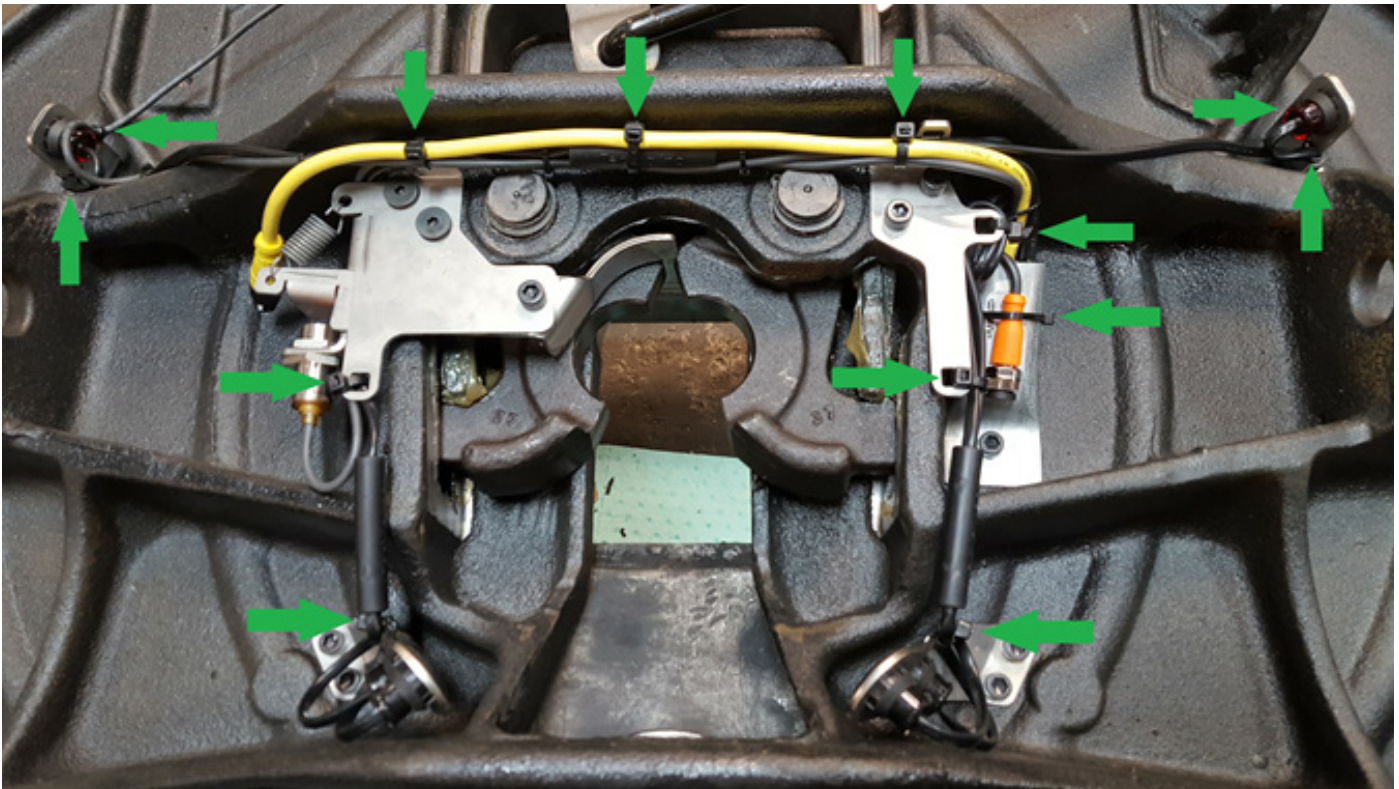
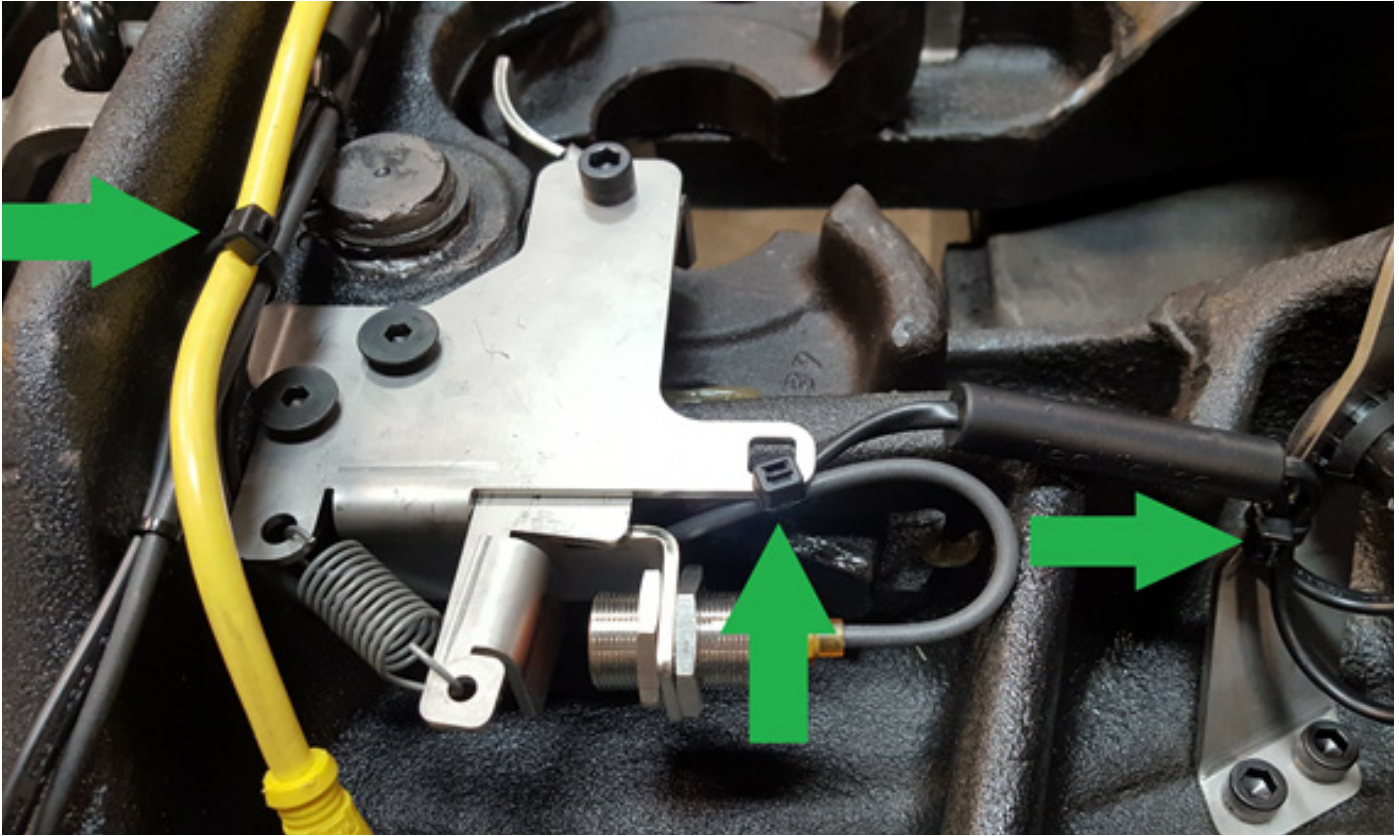
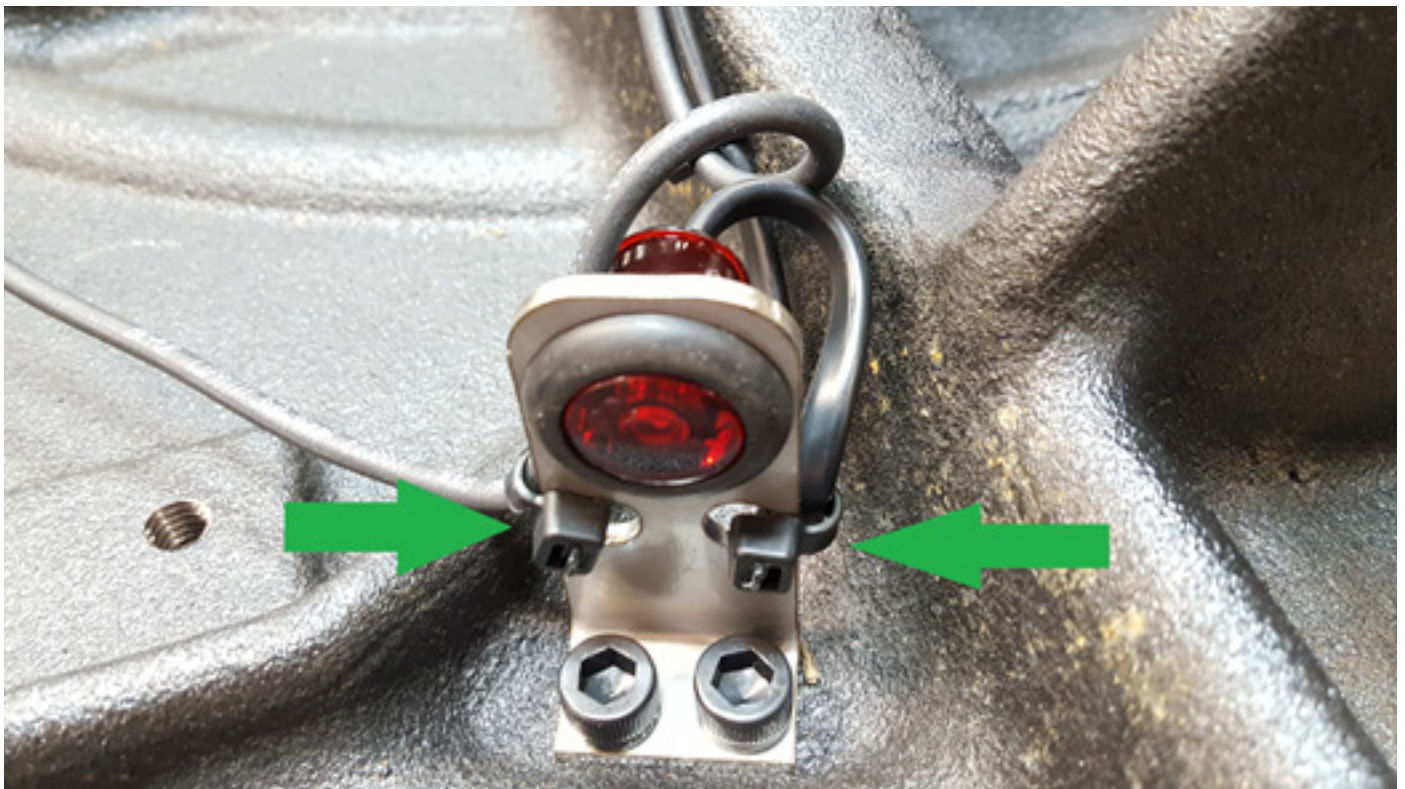
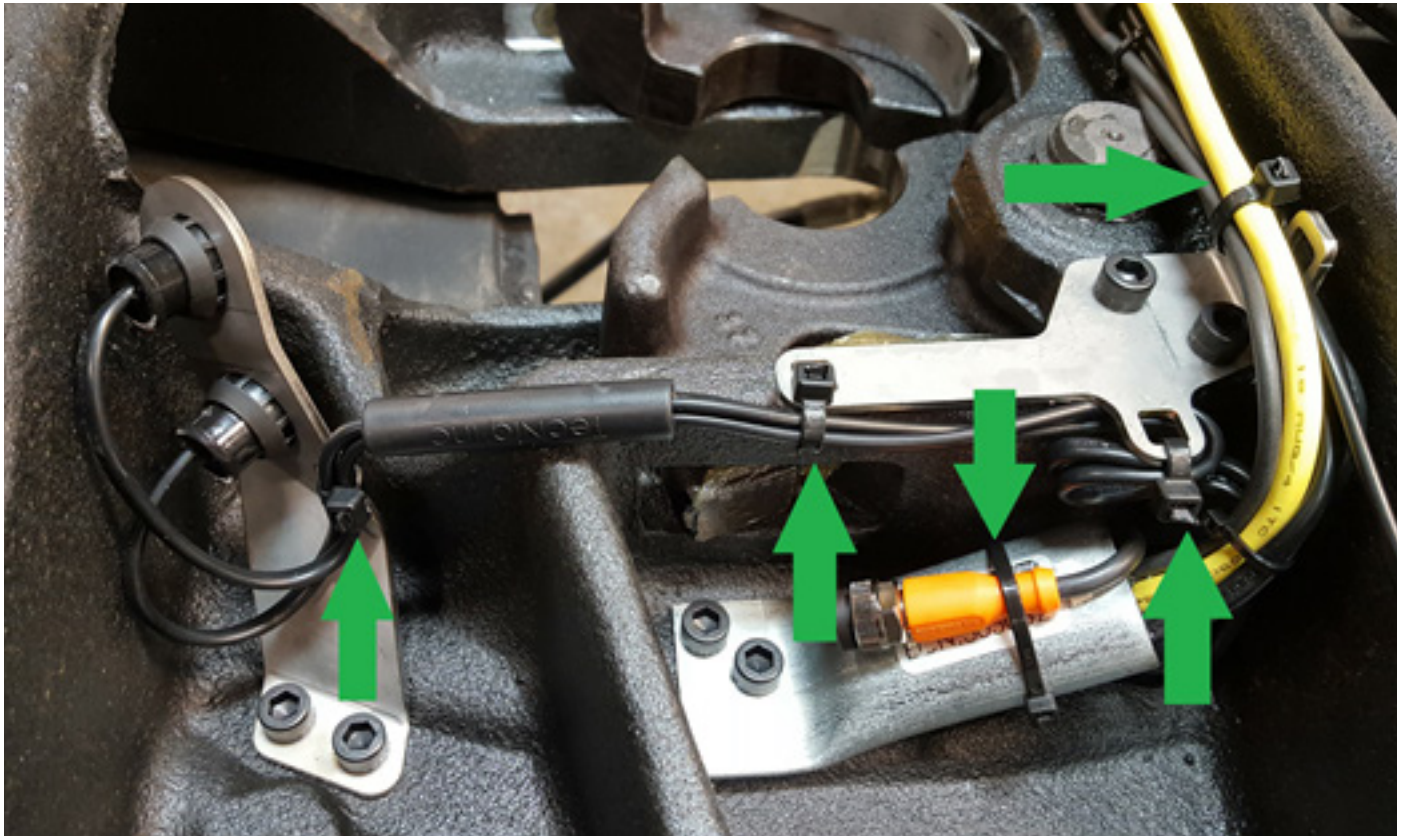

Figure 12



5. Cable Tie Installation Locations (shown with green arrows)





6. Top Plate Installation

1. Visually inspect both pocket inserts for excessive wear, chips, cracks or gouges. If any of these conditions are found, the pocket insert(s) must be replaced (**Figure 13**). For pocket insert replacements, contact SAF-HOLLAND Customer Service 1300 131 613.
2. If pocket inserts are dislodged from fifth wheel casting, clean pocket area of casting and apply a strip of double face tape in bottom of pockets. Install pocket inserts by pressing them down into the pocket areas (**Figure 13**).
3. Using a lifting device capable of lifting 500 lbs. (227 kg), install fifth wheel top plate onto its mounting base.

NOTE: Follow instructions published by lifting device manufacturer for proper operation of lifting device.

4. If fitted, install bracket pins through fifth wheel casting and mounting base and secure by installing the bracket pins retention bolts and nuts (Figure 14). Torque retention bolts not to exceed 60 ft-lbs. (81 Nm).
5. Complete the installation by wiring the ELI-te® power extension cable to a convenient, fused 12-volt power supply system. The wiring designation is as follows:

WIRE	DESCRIPTION	DETAILS
Brown	Ground	-
White	Power input	8-16 V input, 2A max
Blue	Couple output	0.3 A max
Black	Warning output	0.3 A max

Figure 13

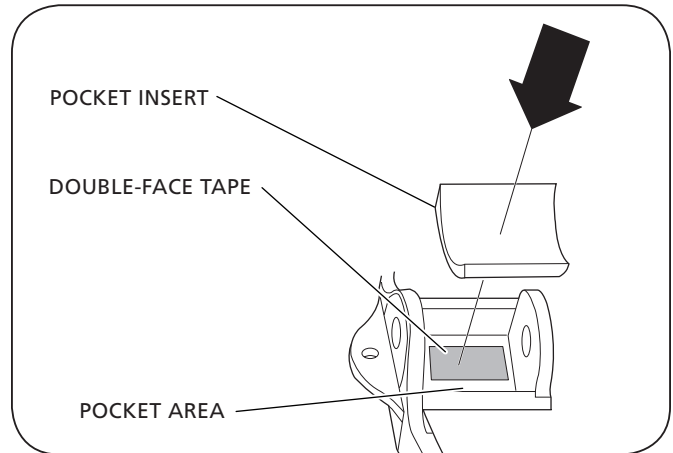
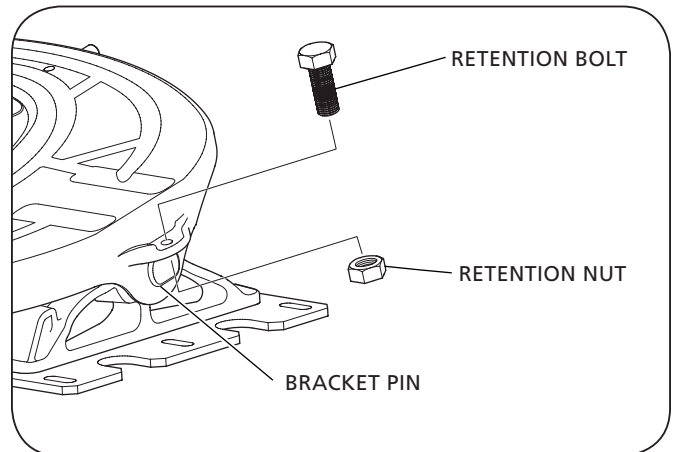

Figure 14







From fifth wheel rebuild kits to suspension bushing repair kits, SAF-HOLLAND Original Parts are the same quality components used in the original component assembly.

SAF-HOLLAND Original Parts are tested and designed to provide maximum performance and durability. Will-fits, look-a likes or, worse yet, counterfeit parts will only limit the performance potential and could possibly void SAF-HOLLAND's warranty. Always be sure to spec SAF-HOLLAND Original Parts when servicing your SAF-HOLLAND product.

SAF-HOLLAND (Aust.) Pty. Ltd.

PO Box 63 · 115 High St · Melton Vic 3337 Tel: (03) 9971 7900
Fax: (03) 9743 6763

Western Australia	·Tel: (08) 9353 1720	Fax: (08) 9353 1730
Queensland	·Tel: (07) 3375 7033	Fax: (07) 3375 7044
New South Wales	·Tel: (02) 9672 1950	Fax: (02) 9672 1994
South Australia	·Tel: (08) 8346 7035	Fax: (08) 8346 3583

www.safholland.com.au

