

# OWNER'S MANUAL

## G36 Fifth Wheel - External Safety Clip



<b>Contents</b>	<b>Page</b>
<b>General Safety Information .....</b>	<b>3</b>
<b>Operating Instructions .....</b>	<b>4-5</b>
<b>Coupling Instructions .....</b>	<b>6-7</b>

## Introduction

This manual describes how to use the external safety clips for G36 fifth wheels.

**IMPORTANT:** Keep this manual in a safe location for future reference.

## Notes, Cautions and Warnings

You must read and understand all of the procedures presented before starting work. Failure to follow all of the procedures contained in these instructions may result in a hazardous condition or cause a hazardous condition to develop.

Other company-specific and workshop procedures, as set by applicable regulations, must be followed. Proper tools must be used to perform the maintenance and repair procedures described in this manual.

Throughout this manual, you will notice the terms "NOTE," "IMPORTANT," "CAUTION," and "WARNING" followed by useful product information.

So that you may better understand the manual, those terms are defined as follows:

**NOTE:** Includes additional information to enable accurate and easy performance of procedure.

**IMPORTANT:** Includes additional information that if not followed could lead to hindered product performance.

### CAUTION

Used without the safety alert symbol, indicates a potentially hazardous situation which, if not avoided, may result in property damage.

### ⚠ CAUTION

Indicates a potentially hazardous situation which, if not avoided, may result in minor or moderate injury.

### ⚠ WARNING

Indicates a potentially hazardous situation which, if not avoided, could result in death or serious injury.

## General Safety Information

Read and observe all Warning and Caution hazard alert messages in this publication. They provide information that can help prevent serious personal injury, damage to components, or both.

Installations must be performed by a trained technician using proper tools and safe procedures. We recommend only the use of SAF-HOLLAND Original Parts.

A list of SAF-HOLLAND technical support locations to supply SAF-HOLLAND original parts can be found at [www.safholland.com.au](http://www.safholland.com.au) or contact the customer service team at 1300 131 613.

Updates to this manual will be published as necessary and will be available at [www.safholland.com.au](http://www.safholland.com.au)

## Operating Instructions – to operate the safety clip during trailer connection/ disconnection

1. Note the individual parts of the safety clip assembly.
  - a. the adjustment block
  - b. the snap hook
  - c. the connecting link
  - d. the eye bolt

**⚠ WARNING** If any part of the safety clip assembly is worn or damaged, it must be replaced immediately.

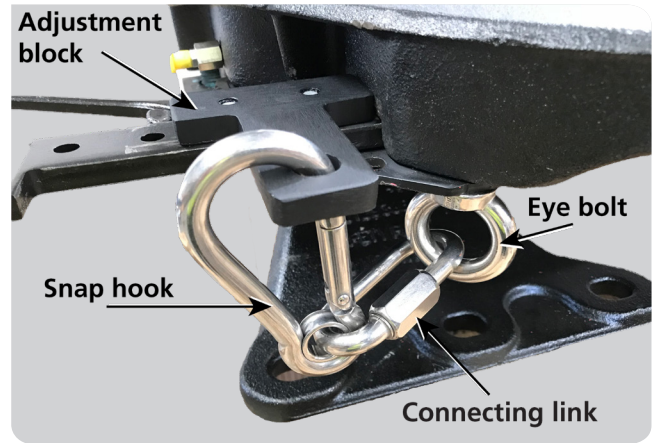

2. To detach the safety clip, unhook the snap hook from the adjustment block.



3. Let the snap hook and quick link hang from the eye bolt while the trailer is disconnected.

**⚠ WARNING** Do not attempt to hang, drape, or connect any part of the safety clip assembly onto or near the sliding handle mechanism.

If this warning is not followed, the clip may become caught in the sliding mechanism during operation of the fifth wheel, and may prevent a secure coupling.

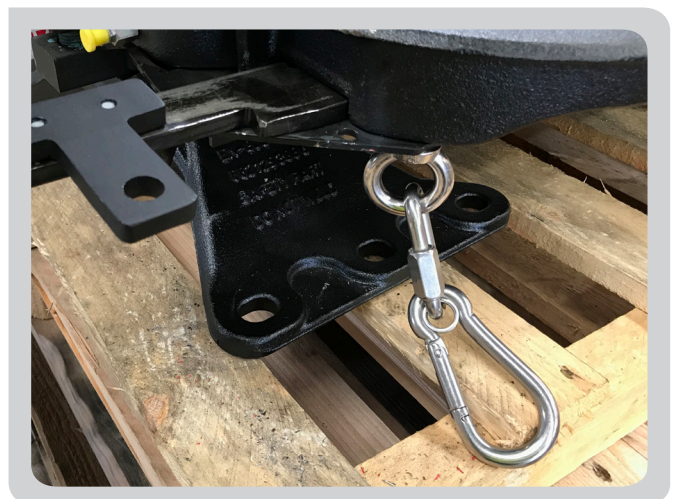

4. Follow the normal fifth wheel coupling Instructions (attached for reference purposes).

Conduct the following visual checks to confirm that the coupling is secure:

- a. **Adjustment block sits flush against the top plate**
- b. **No gap between skidplate and fifth wheel top**
- c. **Lock is completely closed around the kingpin**

5. Once a secure coupling is visually confirmed, re-attach the snap hook into the adjustment block.

**NOTE:** When not in use, the snap hook can be attached to the eye bolt to prevent the snap hook from resting on the fifth wheel foot or baseplate.

**⚠ WARNING**

Do not remove and/or discard any part of the safety clip assembly. If service work is required, please contact SAF-HOLLAND.

**IMPORTANT**

When changing the position of the adjustment block to adjust the fifth wheel's locking mechanism, ensure that the adjustment block is re-attached in the orientation depicted in this manual.

Refer to the fifth wheel owner's manual (document: SH-38) for advice on the adjustment of the fifth wheel's locking mechanism.

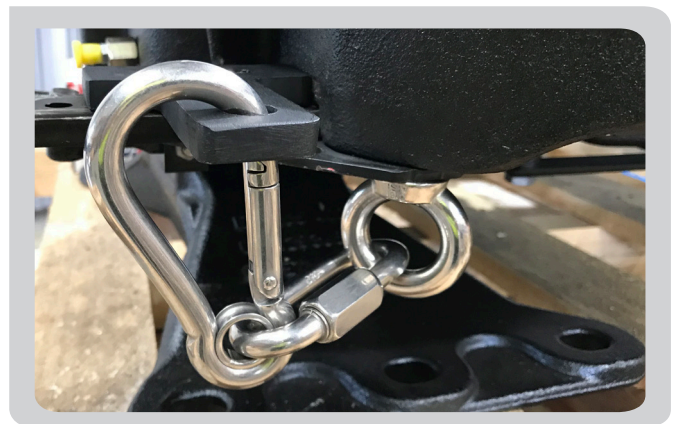
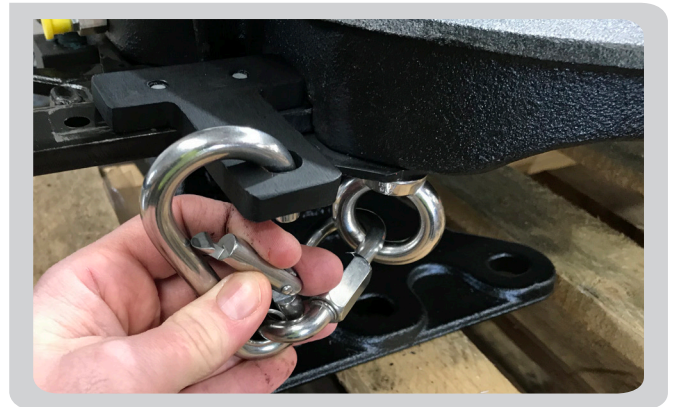



**G36 / G36L**
**FIFTH WHEEL COUPLING INSTRUCTIONS**

## STEP 1

Check that the locks are **OPEN**

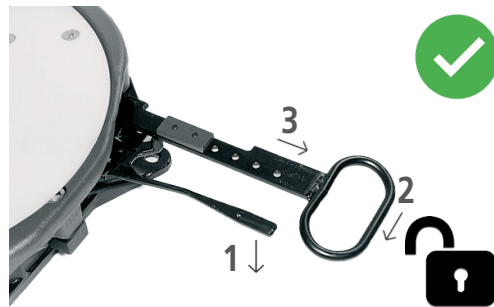

**OPEN** READY TO COUPLE

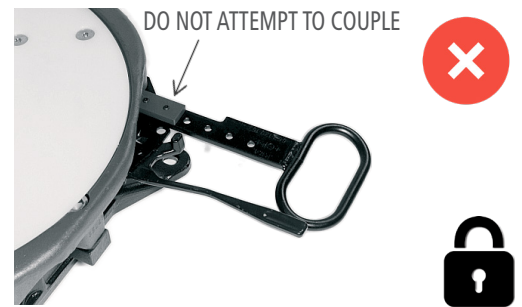

**CLOSED** FIFTH WHEEL IS LOCKED

## STEP 2

Tilt Fifth Wheel down

Adjust landing gear (use low gear)

Slowly reverse prime mover until Fifth Wheel is under **SKID PLATE**

Fifth Wheel **MUST** lift trailer

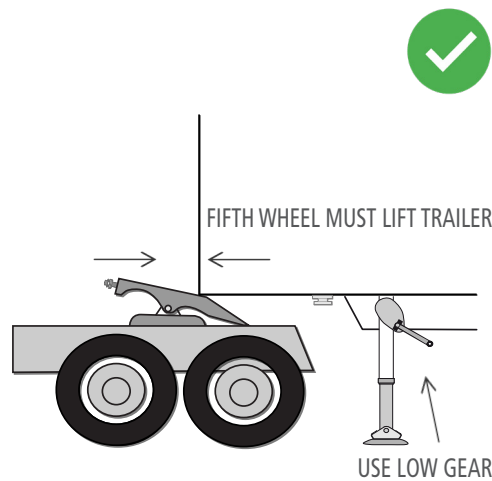

**CORRECT POSITION**

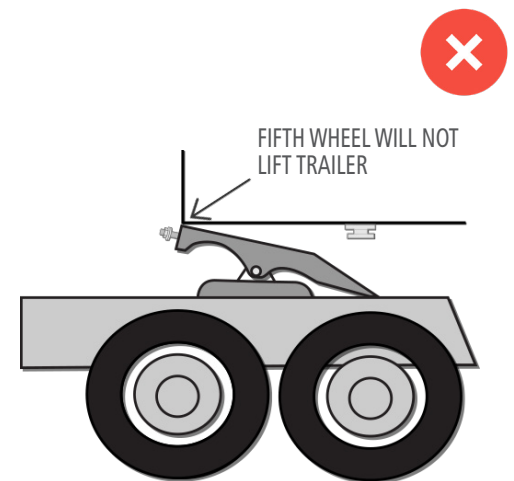

**TRAILER IS TOO HIGH**

## STEP 3

**SLOWLY** back into trailer

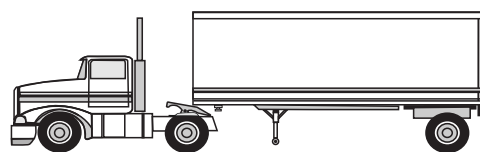

**BACK INTO TRAILER SLOWLY**

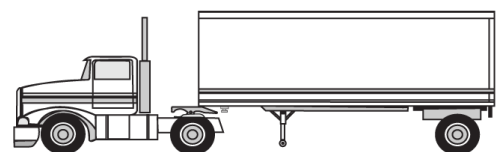

**DO NOT BACK INTO TRAILER FAST**

**G36 / G36L**
**FIFTH WHEEL COUPLING INSTRUCTIONS**

## STEP 4

Do a pull test as an  
**INITIAL CHECK**

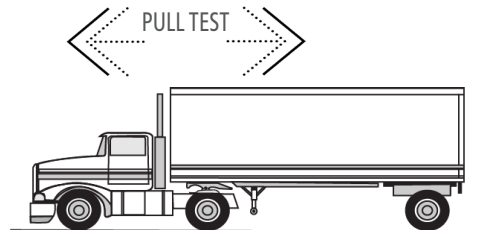

PULL FORWARD WITH TRUCK

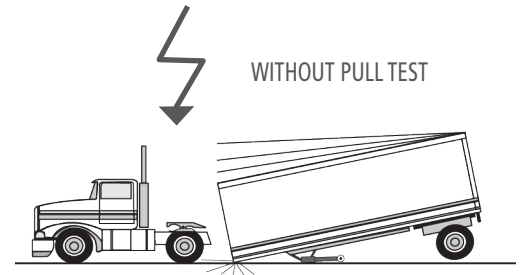

DO NOT SKIP THE PULL TEST

## STEP 5

Get out of truck  
and **VISUALLY** check  
that the locks are  
**CLOSED!**

Attach safety clip to  
handle

NOTE:  
THE ADJUSTMENT  
BLOCK SITS FLUSH  
AGAINST THE TOP  
PLATE

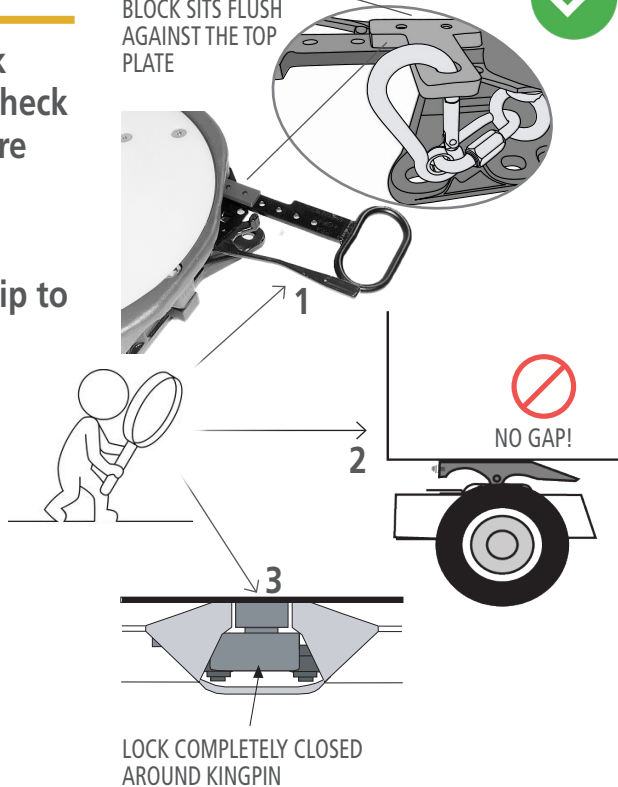

GET OUT OF TRUCK

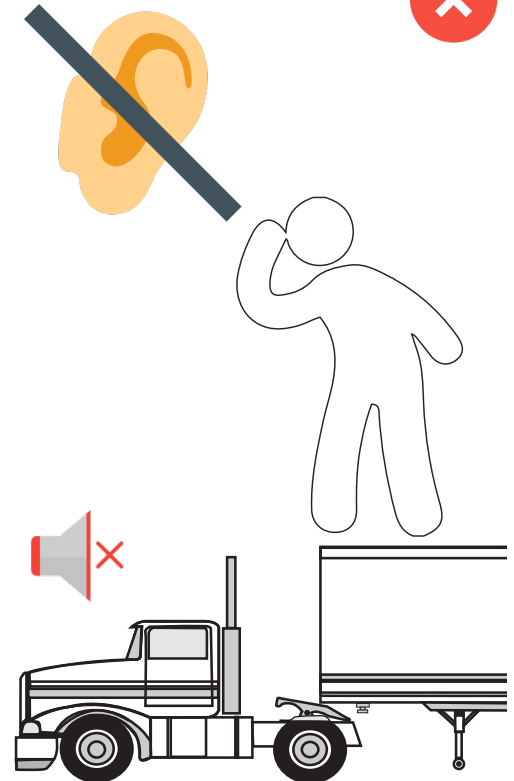

DO NOT RELY ON SOUND ALONE!

**SAF**  
TRAILER AXLES AND  
SUSPENSION SYSTEMS

**Holland**  
COUPLING AND LIFTING  
TECHNOLOGIES

**NEWAY**  
SUSPENSIONS FOR  
TRUCKS AND BUSES

**KIL**  
SUSPENSIONS AND COMPONENTS  
FOR COMMERCIAL VEHICLES

**CORPCO**  
BUS AIR SUSPENSION  
SYSTEMS

**V.ORLANDI**  
COUPLING AND LIFTING  
TECHNOLOGIES

**YORK**  
TRAILER AXLES AND  
SUSPENSION SYSTEMS

[safholland.com.au](http://safholland.com.au)

**SAF-HOLLAND (Aust.) Pty. Ltd.**

VIC · Tel: (03) 9971 7900 Fax: (03) 9743 6763 WA · Tel: (08) 9353 1720 Fax: (08) 9353 1730  
QLD · Tel: (07) 3375 7033 Fax: (07) 3375 7044 NSW · Tel: (02) 9672 1950 Fax: (02) 9672 1994  
SA · Tel: (08) 8346 7035 Fax: (08) 8346 3583 · [enquiries@safholland.com.au](mailto:enquiries@safholland.com.au) · [www.safholland.com.au](http://www.safholland.com.au)