

重装/维修手册

FW20 系列鞍座

■ RK-200-A 重装工具包



中文

English

目录	页面
简介	2
注释、注意和警告	2
第 1 节 - 一般安全说明	3
第 2 节 - 型号识别	4
FW20 系列分解图和零件列表	5
第 3 节 - 拆卸顶板	6

目录	页面
第 4 节 - 安装解锁把手	7
第 5 节 - 安装锁止块	8
第 6 节 - 安装润滑嘴	10
第 7 节 - 安装顶板	11
第 8 节 - 鞍座的检查和调节	12

简介

本手册提供正确重装荷兰德® FW20、XA-11542 系列鞍座所需的信息。请将本手册存放在安全的地方，以供日后查阅。本手册的更新内容将根据需要发布，并可以通过访问 www.safholland.com 在互联网上获取。

如需更换零部件，赛夫-荷兰德® 强烈建议只使用赛夫-荷兰德® 原厂配件。您可以访问 www.safholland.cn，查找供应赛夫-荷兰德原装零配件的赛夫-荷兰德技术支持地点，或者拨打 +86 592 6388891 联系我们的客服，您也可以在本手册的封底查找附近的技术支持地点寻求帮助。

注释、注意和警告

使用设备之前，您应该首先阅读并理解本手册中展示的全部程序。本手册中包含“注”、“重要提示”、“注意”和“警告”等词，后跟重要的产品信息。这些词的定义如下：

注： 提供额外信息，有助于准确、轻松地执行程序。

重要提示： 提供额外信息，如不遵循，可能无法充分利用产品性能。

注意

不含安全提醒标志时，表示如不避免该潜在危险情况，可能会造成财产损失。

⚠ 注意

表示如不避免该潜在危险情况，可能会导致轻微或中度人身伤害。

⚠ 警告

表示如不避免该潜在危险情况，可能会导致死亡或严重人身伤害。

1. 一般安全说明

- 请阅读并遵守所有“警告”和“注意”下的危险警示信息。这些警示信息有助于防止发生严重人身伤害和/或部件损坏。

警告

如果不按照本手册的说明和安全注意事项进行操作，可能会导致不正确的操作或动作，进而引发组件故障，而组件故障如果无法避免，可能会导致死亡或严重的人身伤害。

- 所有维修和维护工作都应由训练有素的技术人员使用适当/特定的工具并遵循安全操作程序来完成。

注： 重装华兰德® 鞍座之前，请查看标识标签上指定的型号。此重装程序只适用于 FW20、XA-11542 型号的鞍座顶板。

重要提示： 切记，所有维护工作都必须在牵引车与挂车分离之后进行。

重要提示： 这些说明只适用于 FW20、XA-11542 系列鞍座顶板的正确重装。出于必要性、谨慎原因考虑和/或依照法律要求，还有其他重要检查、检视和程序，但这里未列出。

- 如需了解正确的安装程序，请参阅赛夫-华兰德® 安装手册 XL-FW10008BM（可通过访问 www.safholland.cn 在互联网上获取）。

重要提示： 开始操作鞍座之前，请确认鞍座已经正确安装到车辆上。

警告

如果鞍座未能正确维修和安装，可能会给性能带来不利影响，从而导致牵引车和挂车分离；如不可避免，可能会造成严重人员伤亡。

2. 型号识别

鞍座的序列号标签位于鞍座支架销之上鞍座顶板的右侧，或位于挂接坡板上 (图 1)。

标签上列出了识别号和序列号 (图 2)。

图 1



图 2





RK-11623

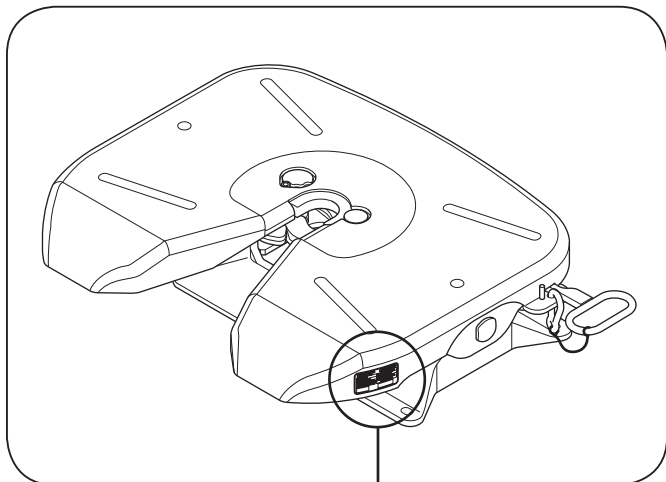
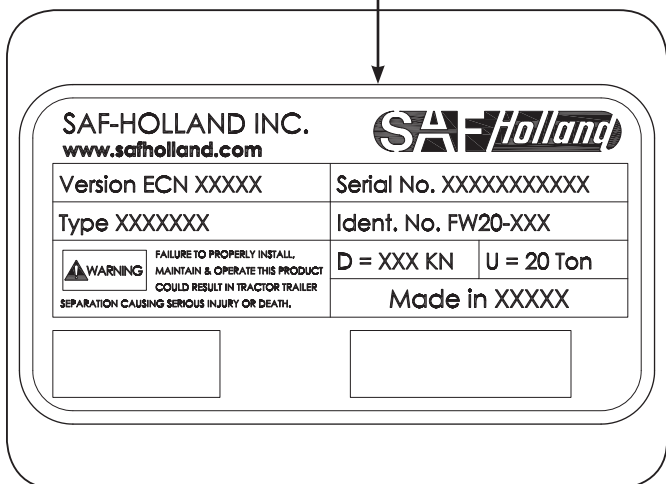
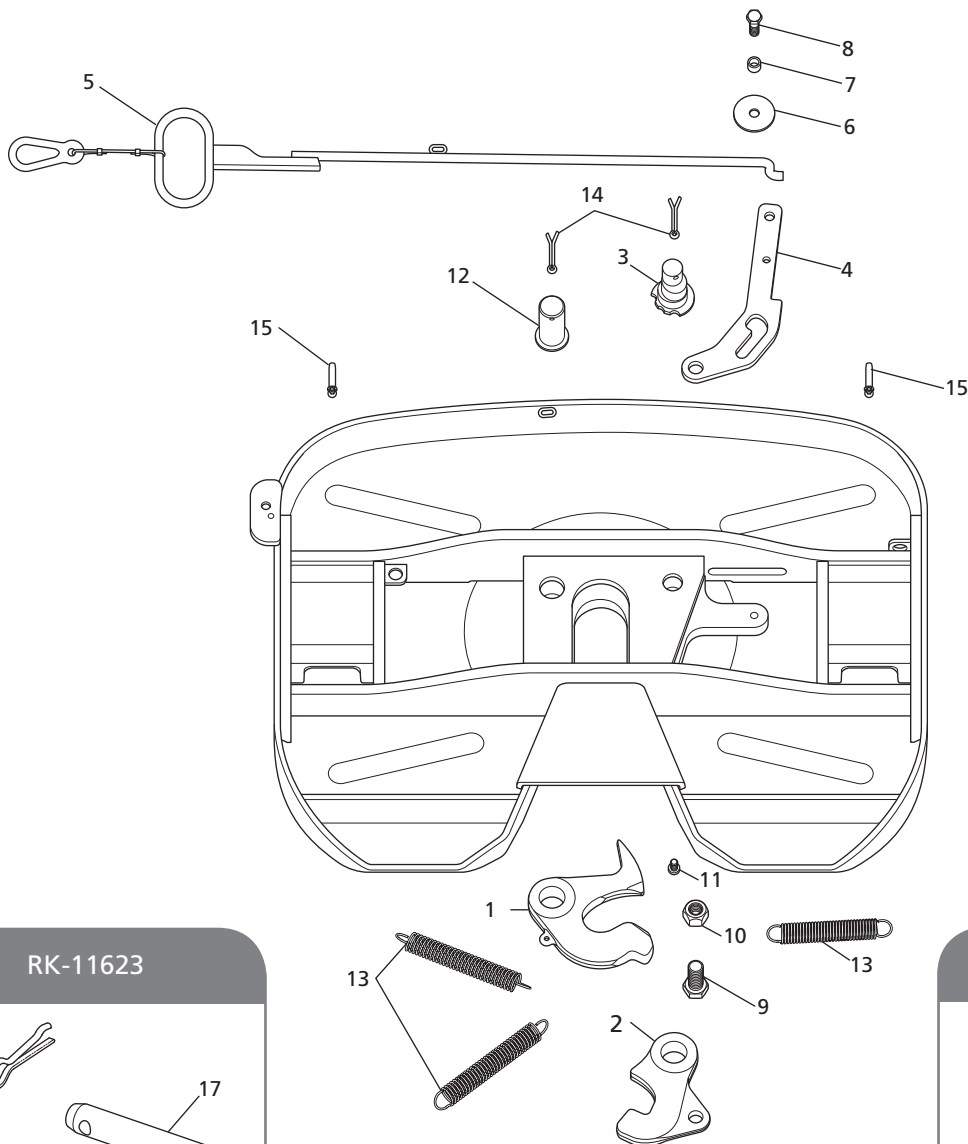
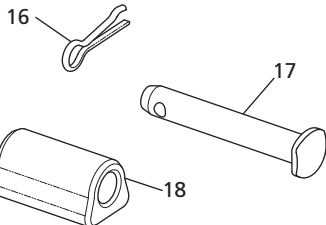

维修工具

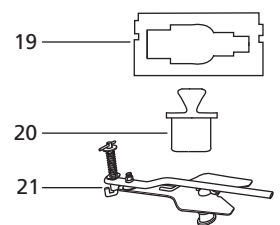

FW20 RK-200-A 套件零件列表

项目	说明	零件编号	数量
1	锁止块	XA-10486-C	1
2	挂钩	XA-10487-C	1
3	调节销	XA-10364-C	1
4	解锁凸轮	XA-11458-C	1
5	解锁把手	XA-11554	1
6	解锁凸轮衬套	XA-10810-C	1
7	垫圈	XB-10294-C	1
8	六角头螺钉, M12 x 1.75 x 40 mm	XB-HCS-M12-40-Z-C	1
9	六角头螺钉, M12 x 2.5 x 50 mm	XB-11615	1
10	螺母, M20 x 2.5	XB-11616	1
11	短头内六角圆柱头螺钉, M12 x 1.5 x 16 mm	XB-11617	1

FW20 RK-200-A 套件零件列表

项目	说明	零件编号	数量
12	锁止销	XB-06344-C	1
13	拉簧 (锁止块/解锁把手/凸轮)	XB-10489-C	3
14	开口销	XB-5-C	2
15	润滑嘴、展开, 90°	XB-05849-C	2
16*	夹销	9900169	2
17*	支架销	XA-11533	2
18*	橡胶衬套	XB-0011-3-C	2
19*	牵引销规	TF-0110	1
20*	2" 锁止规 (塞)	TF-TLN-0237	1
21*	牵引销锁止测试器	TF-TLN-5001	1

* 未包含于 RK-200-A 重装套件中

3. 拆卸顶板

1. 拆下鞍座顶板两侧支架销上的夹销 (图 3)。
2. 使用撬杠将鞍座支架销从鞍座顶板中撬出 (图 3)。
3. 在倒置鞍座之前，拆下原来的短头螺钉并安装上新的短头螺钉 (图 4)。
4. 使用提升能力达到 230 kg (507 磅) 的提升设备，将顶板从安装底座上拆除。将鞍座倒置放于平坦洁净的工作区域内。

注： 遵循提升设备制造商发布的说明，正确操作提升设备。

5. 从鞍座上拆除新的内六角圆柱头螺钉之外的所有组件，并将其废弃。

重要提示： 此重装套件包含完全重装鞍座顶板所需的所有组件。请勿重复使用旧零件。

注： 锁止销可能难以取出，可能需要用力拆下。

注意

请勿用钢锤敲击钢质零件，因为零件可能会破碎，使碎钢片向任何方向飞出，带来危险，如不可避免，可能会导致轻微或中度人身伤害。

6. 用蒸汽彻底清洁顶板和前端锁止区，从而去除所有润滑脂。

图 3



图 4



7. 检查顶板是否有裂纹以及平整度如何。如果顶板破裂则必须将其废弃。华兰德® 系列的锁止销和调节销为滑装型，未设计为其他型号华兰德® 鞍座那样的压配合。但是，如果两个孔中的任何一个被拉长，则 [必须] 更换顶板。

注： 锁止销孔的最大允许直径为 36.3 mm (1.4")。调节销孔的最大允许直径为顶部 42.47 mm (1.6")、底部 29.77 mm (1.1")。

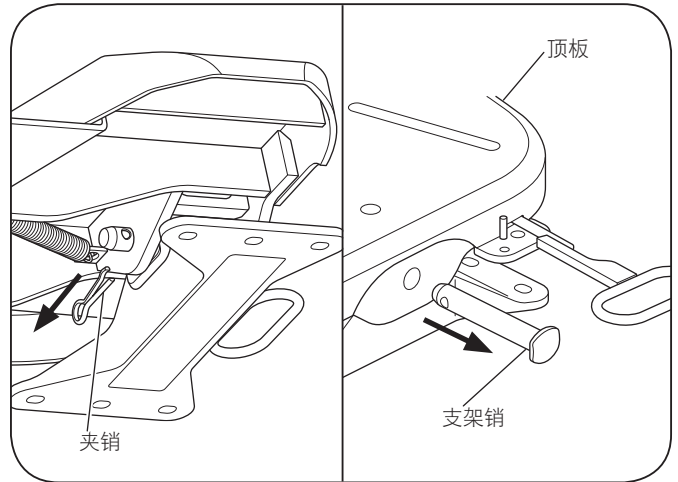
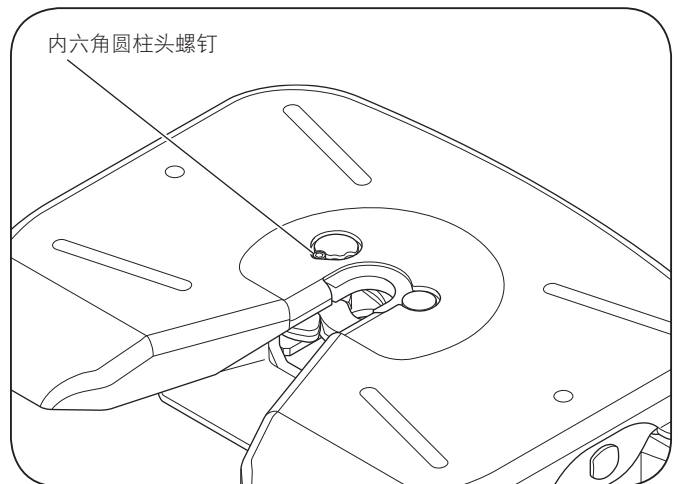
警告

如未能更换出现裂缝或锁止销孔或调节销孔拉长的鞍座，可能导致牵引车和挂车分离；如不可避免，可能会造成严重人员伤亡。

4. 安装解锁把手

1. 润滑解锁把手的两侧 (图 5)。
2. 将解锁把手通过裙板把手窗口插入，插入时“S”向下弯 (图 5)。
3. 将此解锁把手安装进解锁凸轮 (图 6)。

图 5



图 6



4. 用 Never-Seez® 润滑脂润滑解锁凸轮两端的孔，同时也润滑凸轮两侧凸轮槽的周边和凸轮槽本身 (图 7)。
5. 将解锁凸轮通过主肋板上的槽送入 (图 8)。

5. 安装锁止块

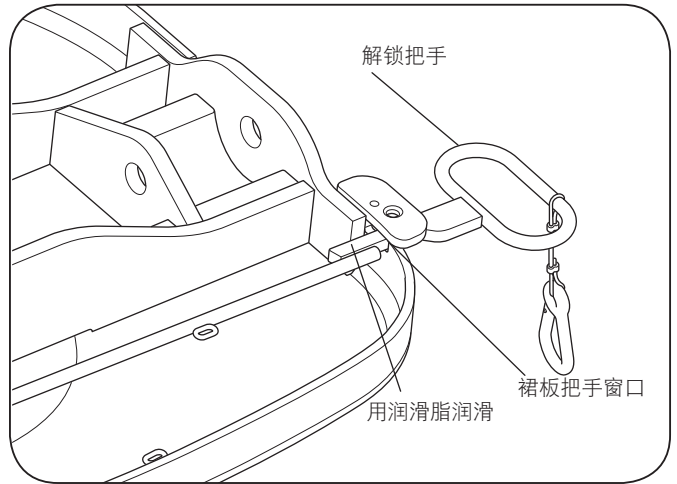
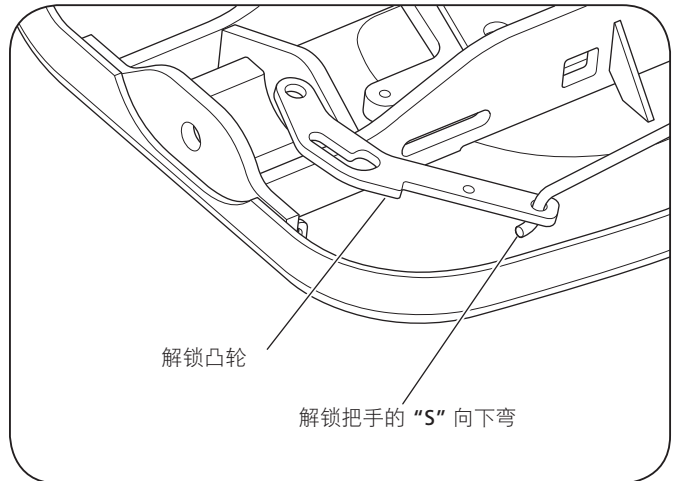
1. 润滑挂钩 (图 9)。

图 7



图 8



图 9



2. 将钩置于解锁凸轮之上并安装 M20 x 2.5 x 50 mm 六角头螺钉，安装时螺钉的头应朝向鞍座。安装 M20 x 2.5 螺母。完全紧固螺母，然后松开一圈 (图 10)。
3. 将钩和解锁凸轮移动到位置，使凸轮槽位于鞍座的螺纹孔上方 (图 10)。
4. 将垫圈放置为其圆面朝向 M12 x 1.75 x 40 mm 六角头螺钉上的解锁凸轮和衬套 (图 11)。
5. 通过将 M12 x 1.75 x 40 mm 六角头螺钉插入鞍座凸起部的螺纹孔并拧至 54-68 N•m (40-50 ft.-lbs.) 扭力来紧固装置 (图 11)。
6. 润滑调节销、锁止销和锁止块 (图 12)。

图 10

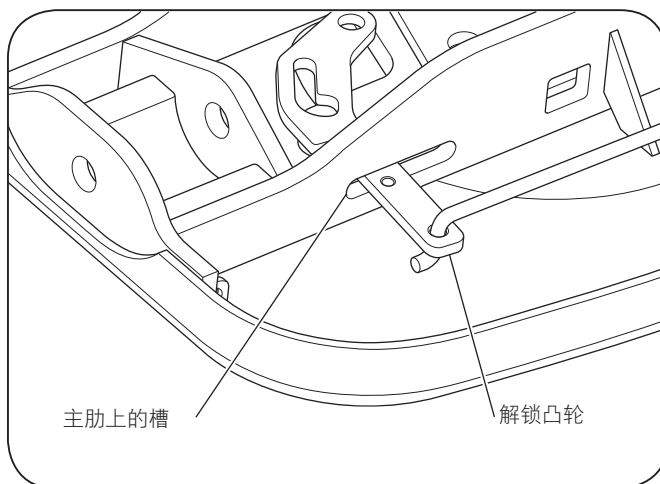
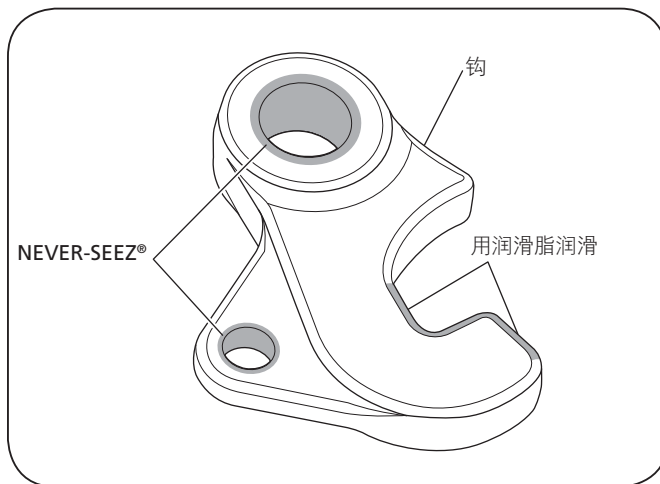

图 11



图 12

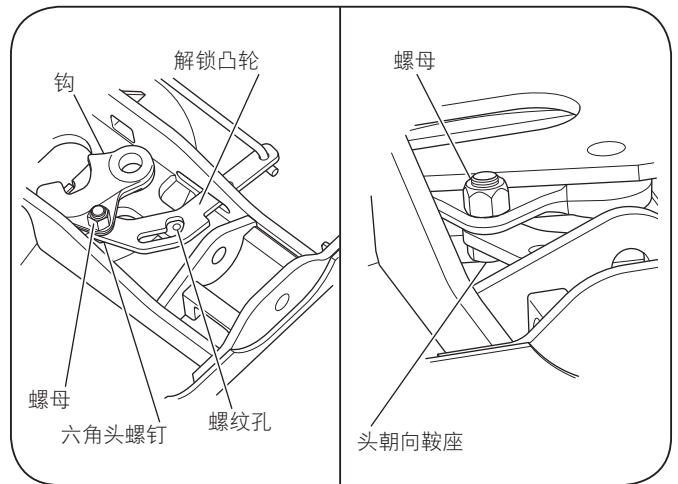

7. 将钩对齐并插入调节销，使其与第一个调节凹口对齐 (图 13)。

8. 安装开口销，安装时使销脚张开 20° 以上 (图 14)。

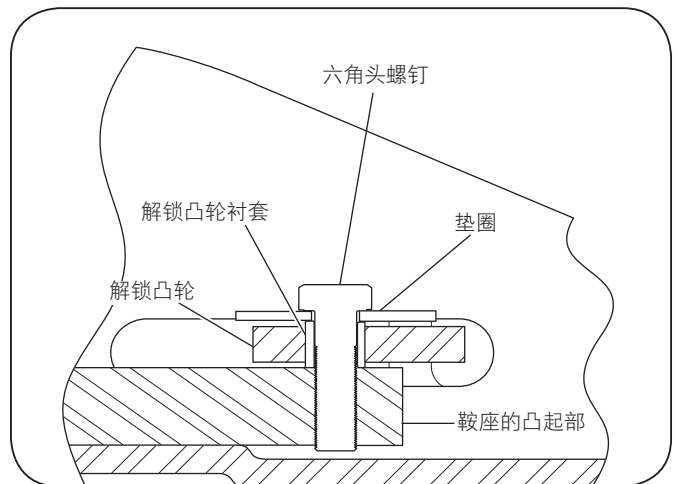
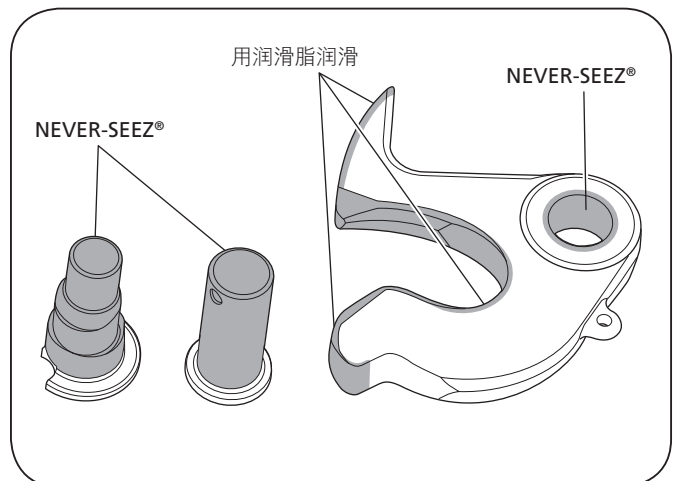
警告

如果未能在锁止销中正确安装开口销，可能会导致牵引车和挂车分离；如不可避免，可能会造成严重人员伤亡。

9. 对齐锁止块，插入锁止销并安装开口销，安装时销脚张开超过 20° (图 14)。

10. 将锁止块转开并安装锁止拉簧，安装时弹簧开口背离鞍座表面 (图 15)。

11. 转动锁止块将其关闭，并将把手、凸轮和钩移至“锁止”位置。安装解锁凸轮拉簧，方法是先以其一端钩住解锁凸轮，使弹簧开口背离鞍座的面，再以其另一端钩住弹簧固定端 (图 15)。

12. 安装解锁把手拉簧，安装时弹簧开口背离鞍座表面 (图 15)。

13. 使用提升能力达到 230 kg (507 磅) 的提升设备将鞍座翻转倒置。

6. 安装润滑嘴

1. 在每个袋的螺纹孔上安装润滑嘴 (图 15)。

图 13



图 14



图 15

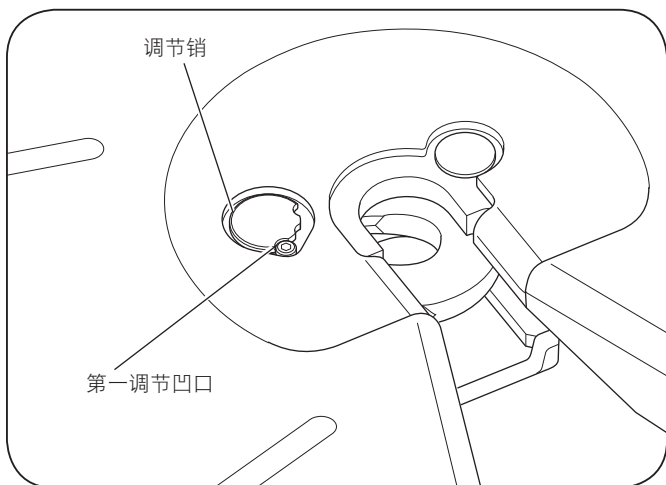

7. 安装顶板

1. 使用提升能力达到 230 kg（507 磅）的提升设备将鞍座顶板安装到安装支架上。

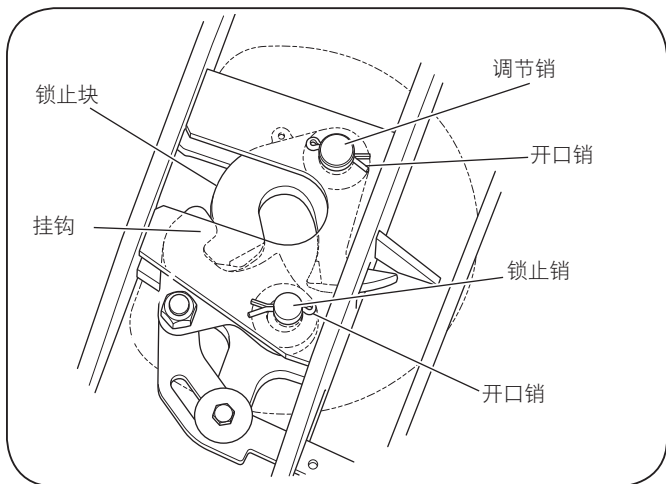
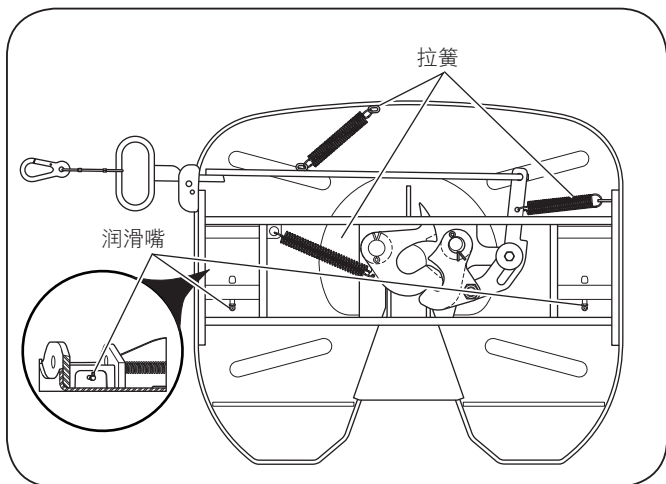
注： 遵循提升设备制造商发布的说明，正确操作提升设备。

2. 将支架销穿过鞍座顶板和安装支架，然后安装夹销进行紧固 (图 16)。

图 16

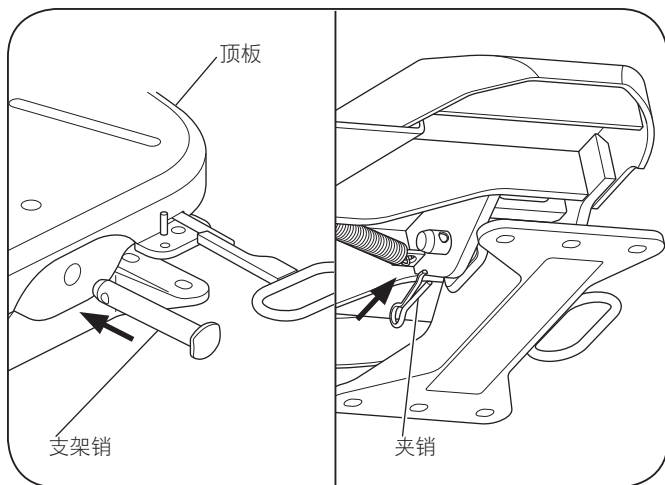

8. 鞍座的检查和调节



警告

如果鞍座调节不当，可能会导致车辆失控；如不可避免，可能会造成严重人员伤亡。

注： 为了实现正确的调节，赛夫-华兰德® 建议使用零件编号为 TF-TLN-5001 的华兰德® 锁止测试器。您可以从本地华兰德® 经销商处购买该测试器。

1. 拔出把手打开锁止块并检查确认锁止块都处于打开状态 (图 17)。
2. 将锁止测试器设定在鞍座顶板上 (图 18)。
3. 要锁止鞍座，顺时针旋转锁止测试器上的手柄，直到锁止块围绕牵引销闭合 (图 18)。
4. 在闭合的锁止块中前后滑动锁止测试器，检查锁止块与牵引销之间的空隙状况。确保此工具始终平放，并完全挨着鞍座顶板。使用针规测量空隙。如果空隙超过 2 mm (0.08")，则调节锁止机构 (图 18)。
5. 要调节锁止块，旋开内六角圆柱头螺钉，直到螺钉完全脱离调节销。然后顺时针旋转调节销，直到下一个凹口与内六角圆柱头螺钉对齐。重新拧紧内六角圆柱头螺钉。一次仅调节一 (1) 个凹口 (图 19)。

注： 如果无法拆除该螺钉，则拆除调节销底部的开口销，然后将调节销提起并旋转到下一个凹口。重新安装开口销，使销脚张开 20° 以上。

图 17



图 18



图 19

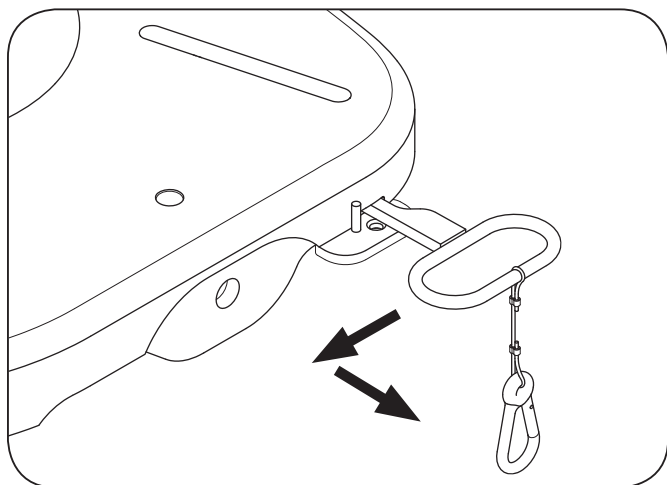

6. 通过使用锁止测试器多次锁止和解锁鞍座，确认调节正确。检查确认鞍座锁止正确 (图 20)。
7. 左右旋转锁止测试器，确保锁止块不会过紧。锁止块不应夹紧牵引销，因此工具应能自由旋转 (图 21)。
8. 通过前后滑动锁止测试器和使用针规测量空隙，重新检查空隙 (图 18)。空隙最小应为 1 mm (0.04")。如果空隙仍然超过 2 mm (0.08")，请重复此程序并再调节一个凹口。
9. 拔出解锁把手从而解锁鞍座。下推并旋转锁止测试器上的“J”形挂钩，使其挂在鞍座顶板前方裙板之下 (图 22)。逆时针拉动锁止测试器的手柄，松开牵引销并拆下锁止测试器。

重要提示： 切勿使用任何无法正常使用的鞍座。如果鞍座无法正常使用，请立即拨打 +86 592 6388891 联系赛夫-华兰德® 客服，或在本手册的封底查找附近的技术支持地点寻求帮助。

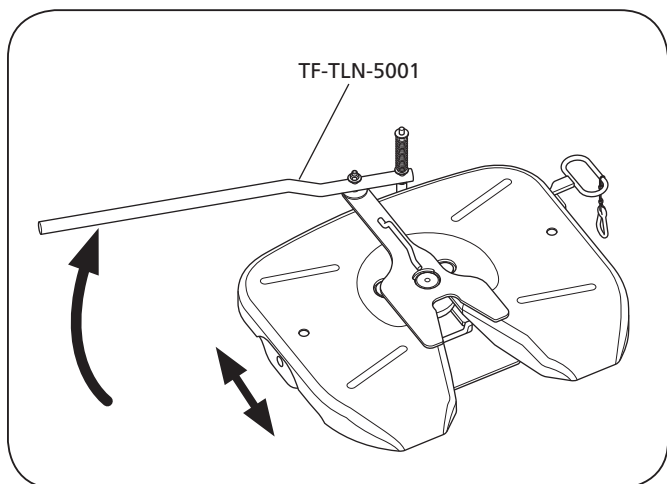
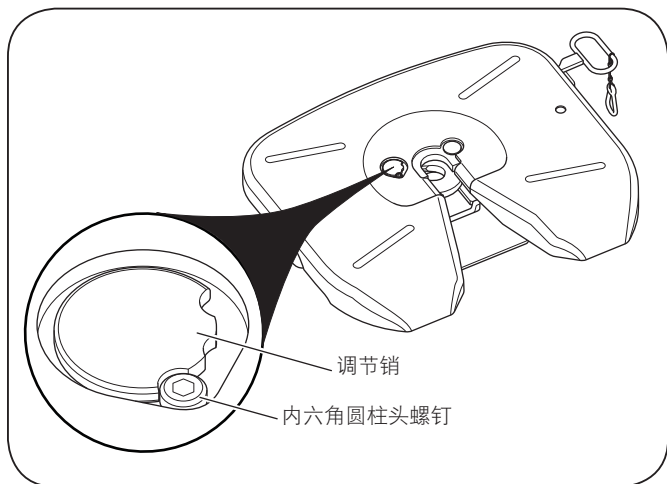
图 20



图 21



图 22

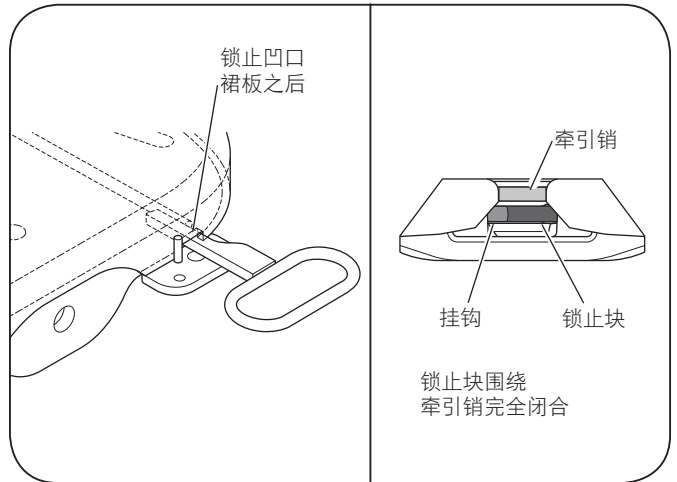

Rebuild/Repair Manual

FW20 Series Fifth Wheels

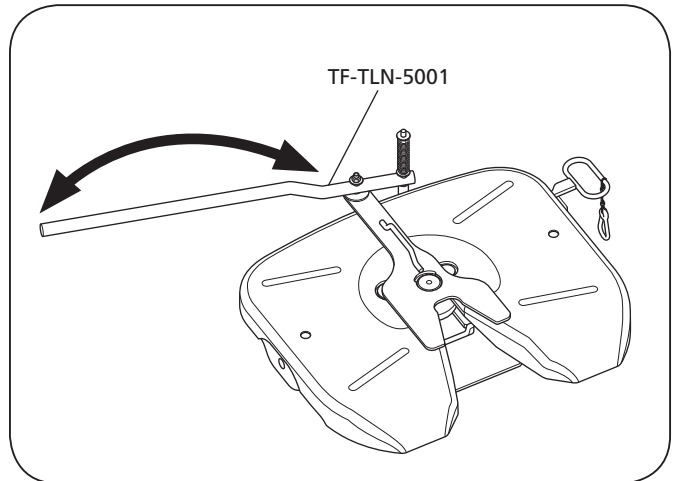
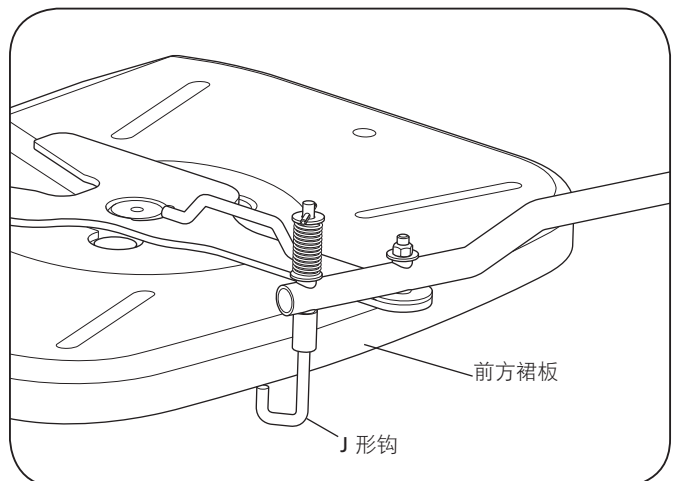
- RK-200-A Rebuild Kit



Contents	Page
Introduction	16
Notes, Cautions, and Warnings	16
Section 1 – General Safety Instructions	17
Section 2 – Model Identification.....	18
FW20 Series Exploded View and Parts List.....	19
Section 3 – Top Plate Removal.....	20

Contents	Page
Section 4 – Release Handle Installation.....	21
Section 5 – Lock Installation	22
Section 6 – Lube Fitting Installation	24
Section 7 – Top Plate Installation	25
Section 8 – Fifth Wheel Inspection and Adjustment.....	26

Introduction

This manual provides the information necessary to properly rebuild the HOLLAND® FW20, XA-11542 Series Fifth Wheels. Read this manual before using or servicing this product and keep it in a safe location for future reference. Updates to this manual, which are published as necessary, are available on the internet at www.safholland.com.

When replacement parts are required, SAF-HOLLAND® highly recommends the use of only SAF-HOLLAND® Original Parts. A list of SAF-HOLLAND technical support locations that supply SAF-HOLLAND Original Parts can be found on the internet at www.safholland.cn or contact Customer Service at +86 592 6388891 or refer to this manual’s back cover for the nearest location for assistance.

Notes, Cautions, and Warnings

Before starting any work on the unit, read and understand all the safety procedures presented in this manual. This manual contains the terms “NOTE”, “IMPORTANT”, “CAUTION”, and “WARNING” followed by important product information. These terms are defined as follows:

NOTE: Includes additional information to enable accurate and easy performance of procedures.

IMPORTANT: Includes additional information that if not followed could lead to hindered product performance.

CAUTION Used without the safety alert symbol, indicates a potentially hazardous situation which, if not avoided, could result in property damage.

⚠ CAUTION Indicates a potentially hazardous situation which, if not avoided, could result in minor or moderate injury.

⚠ WARNING Indicates a potentially hazardous situation which, if not avoided, could result in death or serious injury.

1. General Safety Instructions

- Read and observe all Warning and Caution hazard alert messages. The alerts provide information that can help prevent serious personal injury, damage to components, or both.

⚠ WARNING Failure to follow the instructions and safety precautions in this manual could result in improper servicing or operation leading to component failure which, if not avoided, could result in death or serious injury.

- All repair and maintenance should be performed by a properly trained technician using proper/special tools, and safe procedures.

NOTE: Before rebuilding the HOLLAND® Fifth Wheel review the model number on the identification tag. This rebuild procedure applies only to models FW20, XA-11542 fifth wheel top plates.

IMPORTANT: All maintenance MUST be performed while the tractor is uncoupled from the trailer.

IMPORTANT: These instructions apply to the proper rebuild of FW20, XA-11542 series fifth wheel top plates only. There are other important checks, inspections, and procedures not listed here that are necessary, prudent, and/or required by law.

- For proper installation procedures, refer to SAF-HOLLAND® Installation Manual XL-FW10008BM-zh-CN available on the internet at www.safholland.cn.

IMPORTANT: Prior to operation of the fifth wheel, verify that the fifth wheel has been properly installed on the vehicle.

⚠ WARNING Failure to properly repair and install the fifth wheel could adversely affect performance resulting in tractor trailer separation which, if not avoided, could result in death or serious injury.

2. Model Identification

Fifth wheel serial tags are located on the right side of the fifth wheel top plate above the fifth wheel bracket pin, or on the pickup ramps (**Figure 1**).

The identification number and serial number are listed on the tag (**Figure 2**).

Figure 1

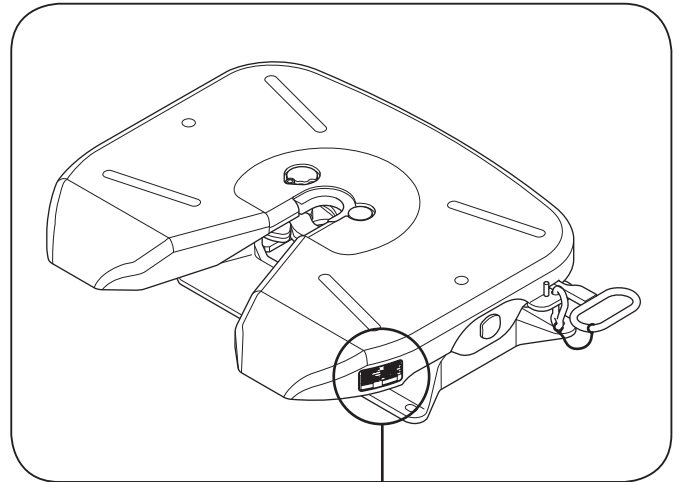
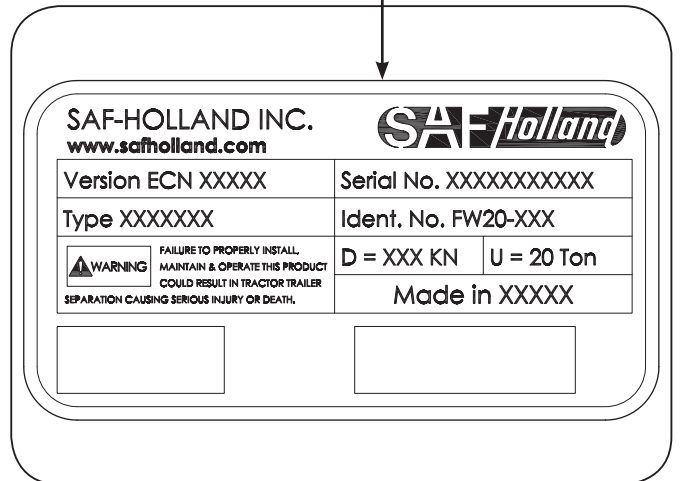
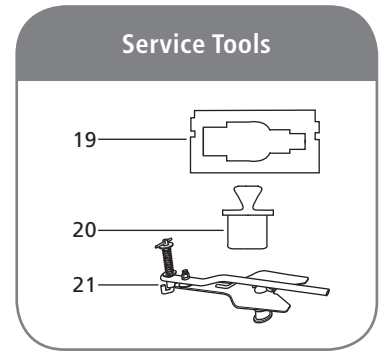
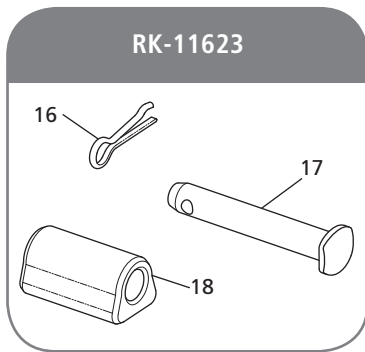
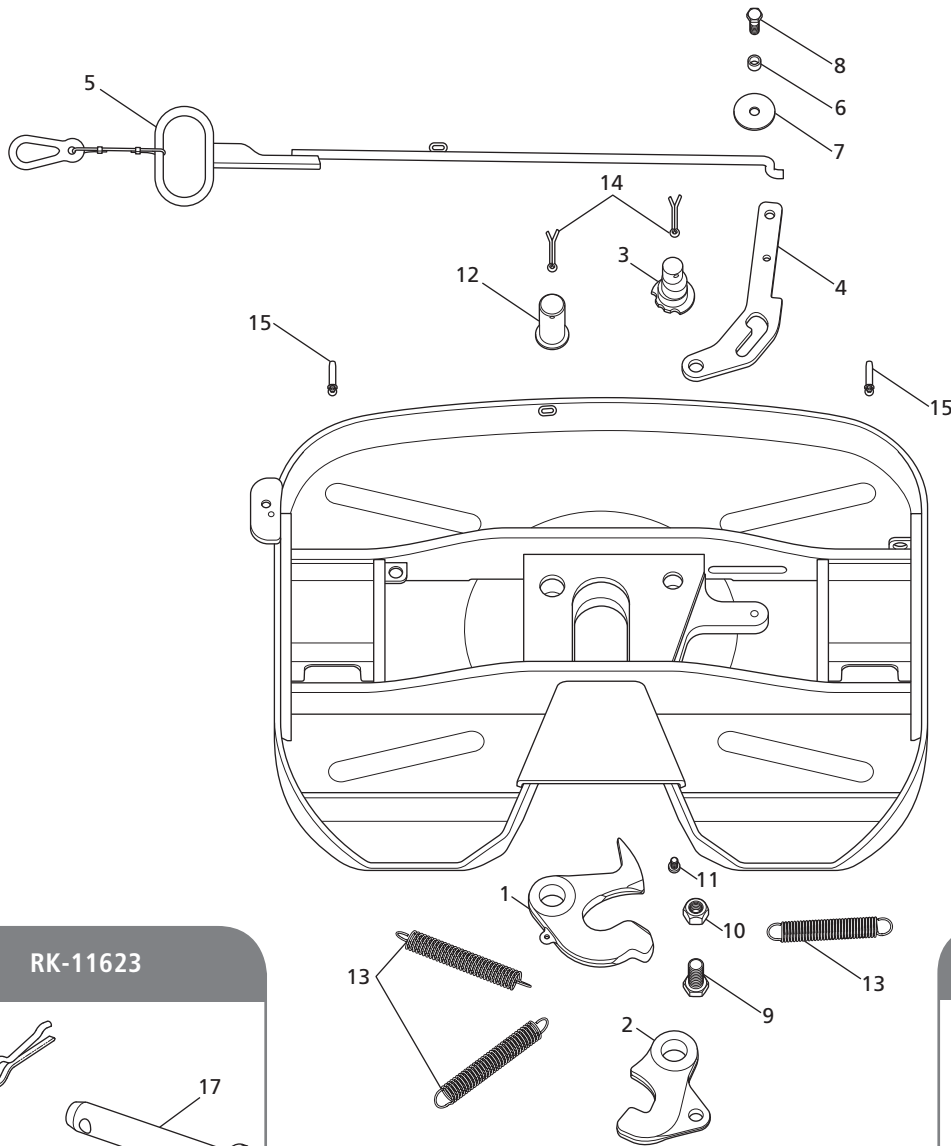

Figure 2





English

FW20 RK-200-A KIT PARTS LIST			
ITEM	DESCRIPTION	PART NUMBER	QTY.
1	Lock	XA-10486-C	1
2	Hook	XA-10487-C	1
3	Adjusting Pin	XA-10364-C	1
4	Release Cam	XA-11458-C	1
5	Release Handle	XA-11554	1
6	Release Cam Bushing	XA-10810-C	1
7	Washer	XB-10294-C	1
8	Hex Head Cap Screw, M12 x 1.75 x 40 mm	XB-HCS-M12-40-Z-C	1
9	Hex Head Cap Screw, M20 x 2.5 x 50 mm	XB-11615	1
10	Nut, M20 x 2.5	XB-11616	1
11	Low Head Socket Cap Screw, M10 x 1.5 x 16 mm	XB-11617	1

FW20 RK-200-A KIT PARTS LIST			
ITEM	DESCRIPTION	PART NUMBER	QTY.
12	Lock Pin	XA-06344-C	1
13	Extension Spring (Lock/Release Handle/Cam)	XB-10489-C	3
14	Cotter Pin	XB-5-C	2
15	Lube Fitting, Extended, 90°	XB-05849-C	2
16*	Clinch Pin	9900169	2
17*	Bracket Pin	XA-11533	2
18*	Rubber Bushing	XB-0011-3-C	2
19*	Kingpin Gauge	TF-0110	1
20*	2" Lock Gauge (Plug)	TF-TLN-0237	1
21*	Kingpin Lock Tester	TF-TLN-5001	1

* Not included in RK-200-A Rebuild Kit

3. Top Plate Removal

1. Remove clinch pins from the bracket pins on both sides of fifth wheel top plate (**Figure 3**).
2. Using a pry bar, pull fifth wheel bracket pins out of fifth wheel top plate (**Figure 3**).
3. Before placing the fifth wheel upside down, remove the low head socket cap screw and install the new one (**Figure 4**).
4. Using a lifting device capable of lifting 230 kg (507 lbs.), remove top plate from mounting base. Place fifth wheel upside down on a flat, clean working area.

NOTE: Follow instructions published by lifting device manufacturer for proper operation of lifting device.

5. Completely remove all components EXCEPT the new low head socket cap screw from the fifth wheel and discard.

IMPORTANT: This rebuild kit contains all the components necessary to completely rebuild the fifth wheel top plate. DO NOT reuse old parts.

NOTE: The lock pin may be difficult to dislodge and may require force to remove.

CAUTION DO NOT hit steel parts with a steel hammer as parts could break, sending steel fragments flying in any direction creating a hazard which, if not avoided could result in minor to moderate injury.

6. Thoroughly steam clean the top plate and front lock region to remove all grease.

Figure 3

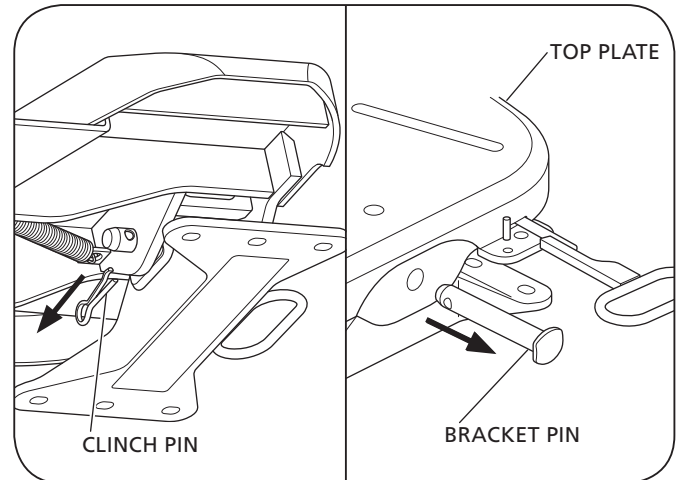
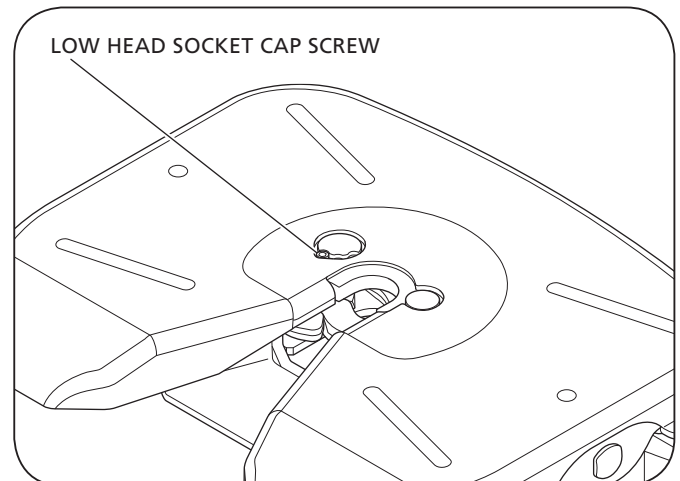

Figure 4



7. Inspect the top plate for cracks and flatness. If the top plate is cracked it **MUST** be discarded. The lock pin and adjusting pin on the HOLLAND® FW20 Series are slip fit, and are not designed to be press fit like other HOLLAND® fifth wheels. However, if either hole is elongated, the top plate **MUST** be replaced.

NOTE: The maximum allowable lock pin hole diameter is 36.3 mm (1.4"). The maximum allowable adjusting pin hole diameters are 42.47 mm (1.6") for the top, and 29.77 mm (1.1") for the bottom.

⚠ WARNING Failure to replace fifth wheels with cracks, elongated lock pin or adjusting pin holes could result in tractor trailer separation which, if not avoided, could result in death or serious injury.

4. Release Handle Installation

1. Lubricate the release handle on both sides (**Figure 5**).
2. Insert the release handle through the skirt handle window with "S" bend down (**Figure 5**).
3. Install the release handle into the release cam (**Figure 6**).

Figure 5

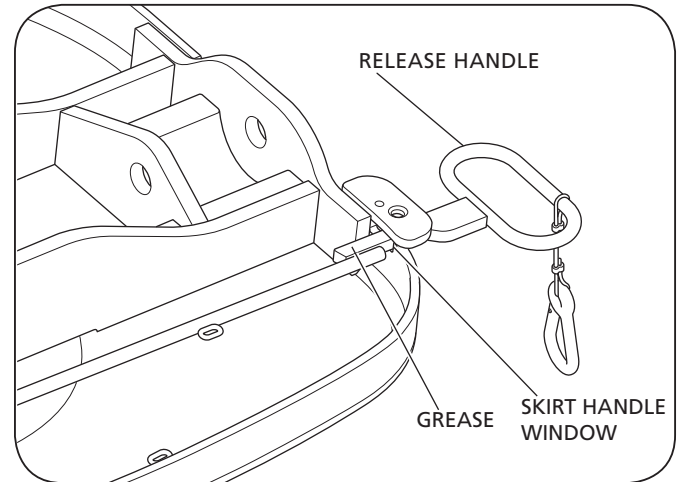
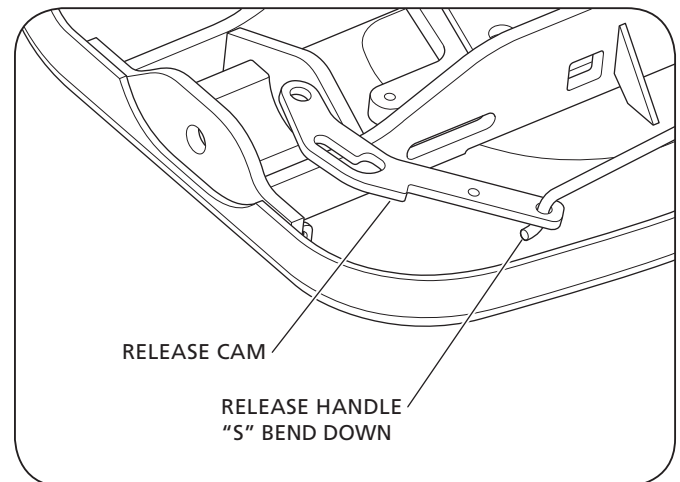

Figure 6



4. Lubricate holes on each end of the release cam with Never-Seez®. Also lubricate both sides around the cam slot and the cam slot itself with grease (**Figure 7**).
5. Feed the release cam through the slot in the main rib (**Figure 8**).

5. Lock Installation

1. Lubricate the hook (**Figure 9**).

Figure 7

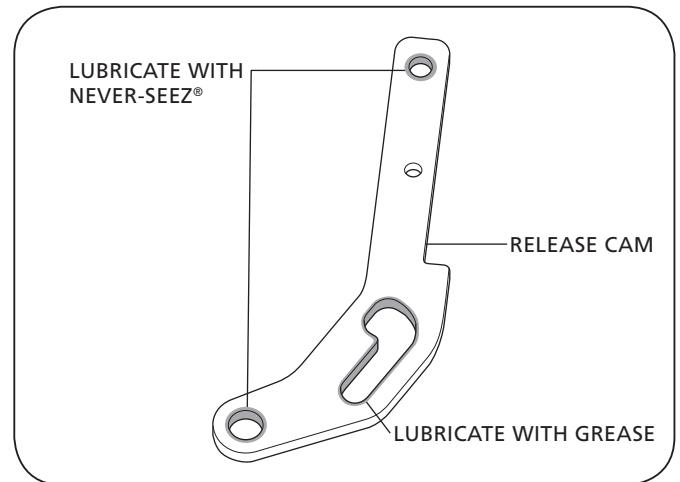

Figure 8

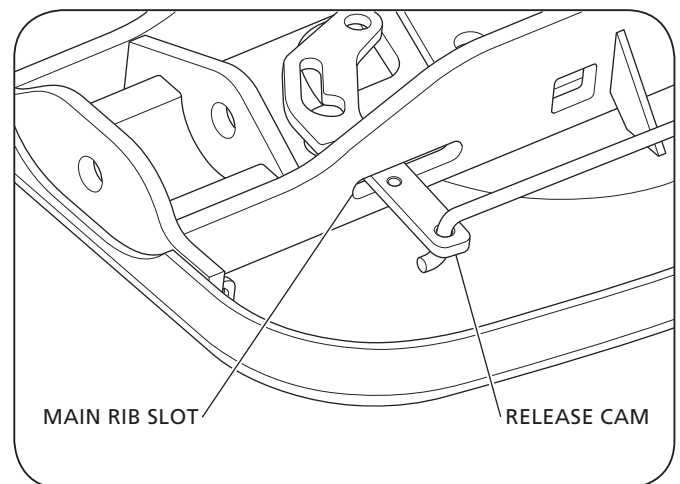
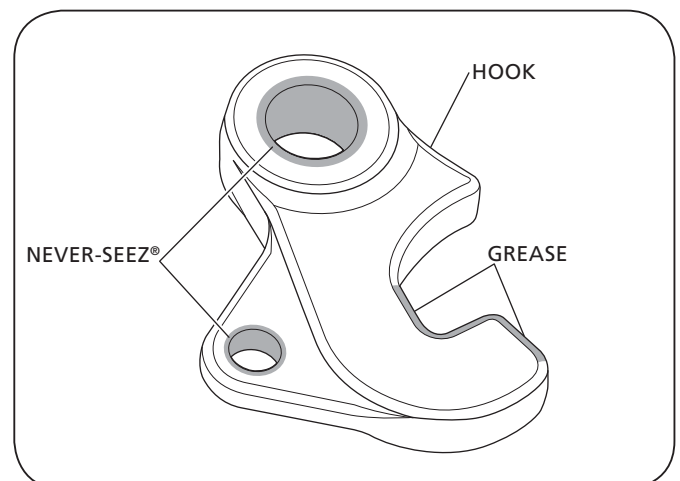

Figure 9



2. Place the hook over the release cam and install the M20 x 2.5 x 50 mm hex head cap screw with the head of the screw toward the fifth wheel. Install the M20 x 2.5 nut. Fully tighten the nut and then loosen one turn (**Figure 10**).
3. Move the hook and release cam into position so the cam slot is over the tapped hole in the fifth wheel (**Figure 10**).
4. Place the washer with the rounded side towards the release cam and bushing on the M12 x 1.75 x 40 mm hex head cap screw (**Figure 11**).
5. Secure the assembly by inserting the M12 x 1.75 x 40 mm hex head cap screw into the tapped hole in the boss of the fifth wheel and tighten to 54-68 N•m (40-50 ft.-lbs.) (**Figure 11**).
6. Lubricate the adjusting pin, the lock pin, and the lock (**Figure 12**).

Figure 10

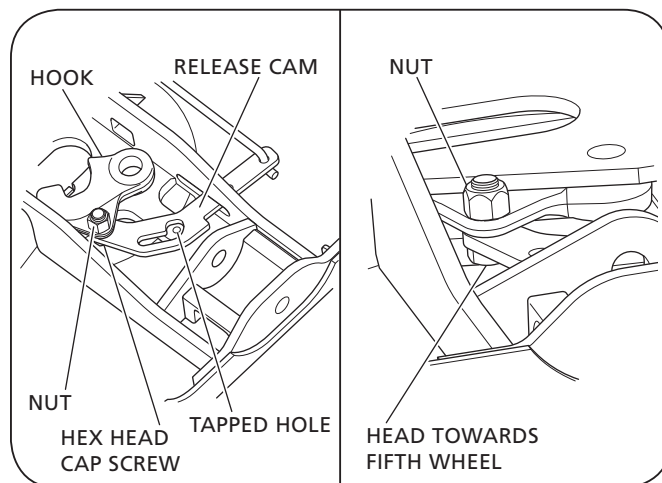
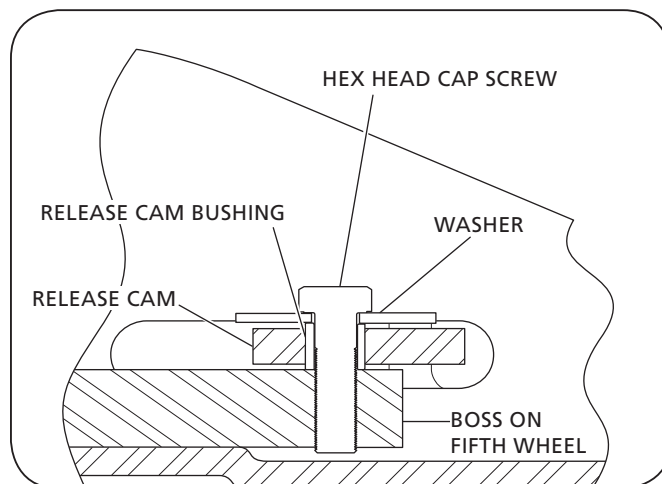
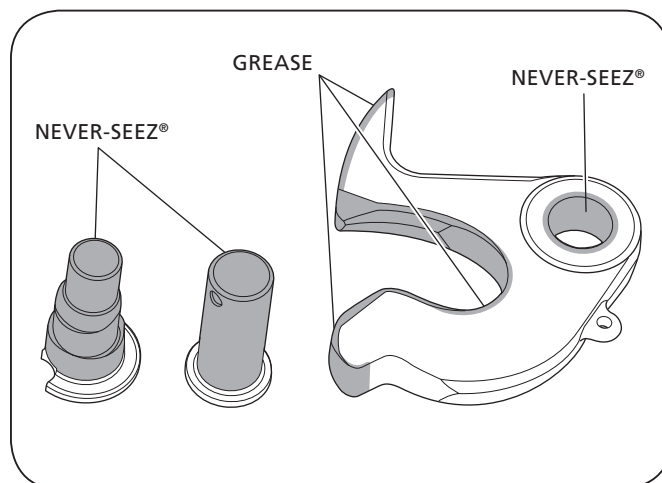

Figure 11



English

Figure 12



7. Align the hook and insert the adjusting pin so that it lines up with the first adjustment notch (**Figure 13**).
8. Install the cotter pin spreading both legs beyond 20° (**Figure 14**).

⚠ WARNING Failure to properly install the cotter pin in the lock pin, could result in tractor trailer separation which, if not avoided, could result in death or serious injury.

9. Align the lock and insert the lock pin and install the cotter pin spreading both legs beyond 20° (**Figure 14**).
10. Swing lock open and install the lock extension spring with the spring openings facing away from the face of the fifth wheel (**Figure 15**).
11. Swing lock closed and move handle, cam, and hook to "LOCKED" position. Install the release cam extension spring by hooking one end to the release cam first so that the spring opening is facing away from the face of the fifth wheel. Hook the other end to the spring anchor (**Figure 15**).
12. Install the release handle extension spring so that the spring openings face away from the face of the fifth wheel (**Figure 15**).
13. Using a lifting device capable of lifting 230 kg (507 lbs.), flip the fifth wheel over.

6. Lube Fitting Installation

1. Install the lube fittings into the threaded holes on each pocket (**Figure 15**).

Figure 13

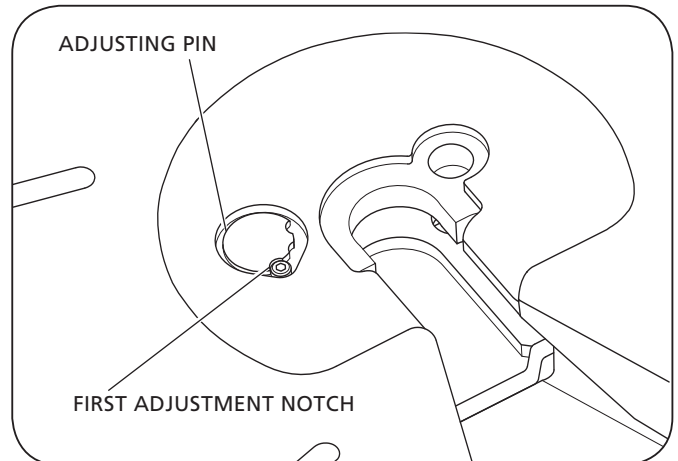

Figure 14

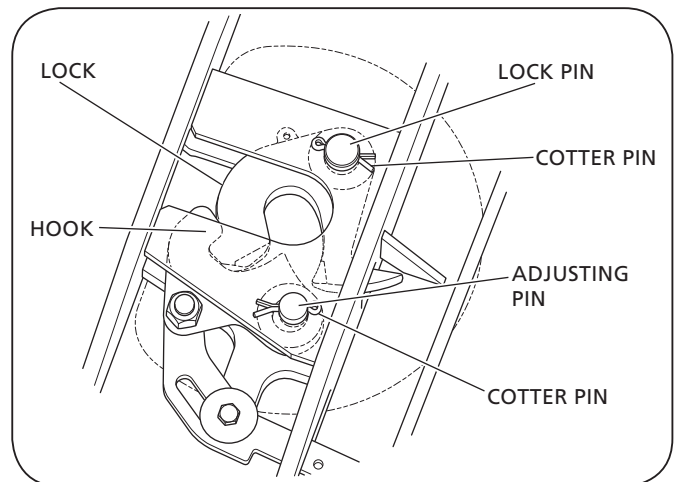
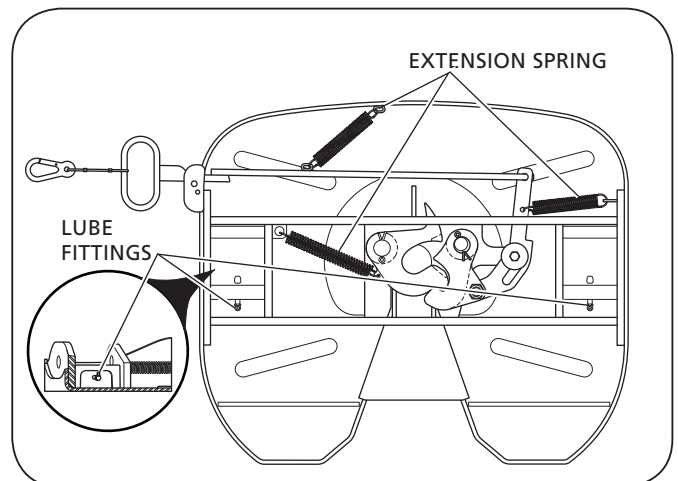

Figure 15



7. Top Plate Installation

1. Using a lifting device capable of lifting 230 kg (507 lbs.), install the fifth wheel top plate onto the mounting brackets.

NOTE: Follow the instructions published by lifting device manufacturer for proper operation of lifting device.

2. Install the bracket pins through the fifth wheel top plate and mounting brackets. Secure by installing the clinch pins (**Figure 16**).

Figure 16

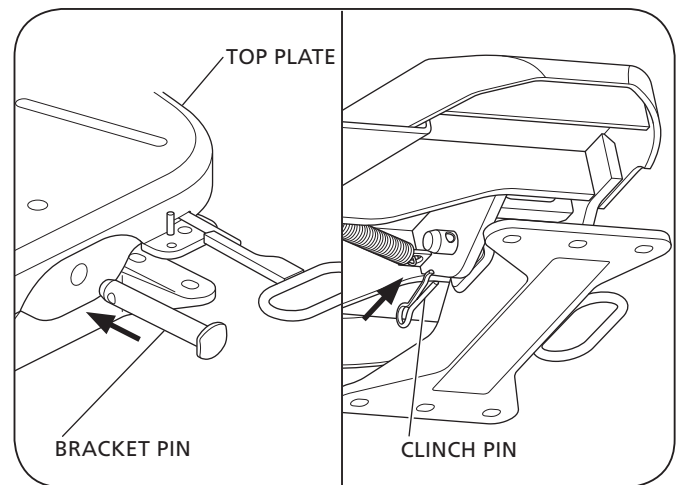

8. Fifth Wheel Inspection and Adjustment

⚠ WARNING Failure to maintain proper fifth wheel adjustment could result in loss of vehicle control which if not avoided, could result in death or serious injury.

NOTE: To obtain proper fifth wheel adjustment SAF-HOLLAND® recommends the use of the HOLLAND® lock tester Part No. TF-TLN-5001, available from a local SAF-HOLLAND® distributor.

1. Pull the handle to open locks and verify that the locks are open (**Figure 17**).
2. Set the lock tester on fifth wheel top plate (**Figure 18**).
3. To lock the fifth wheel, rotate the handle on lock tester clockwise until the locks close around the kingpin (**Figure 18**).
4. Slide the lock tester forward and backward in the closed lock to check for the play between lock and kingpin. Ensure that the tool remains flat with full contact on the fifth wheel top plate. Use a pin gage to measure the free play. If the free play exceeds 2 mm (0.08") adjust the lock mechanism (**Figure 18**).
5. To adjust the lock, unscrew the low head socket cap screw until the head clears the adjusting pin. Rotate the adjusting pin clockwise, until the next notch lines up with the low head socket cap screw. Retighten the low head socket cap screw. Adjust only one (1) notch at a time (**Figure 19**).

NOTE: If the screw cannot be removed, remove the cotter pin from the bottom of the adjustment pin, then lift and rotate the pin to the next notch. Re-install the cotter pin and spread the pin legs beyond 20°.

Figure 17

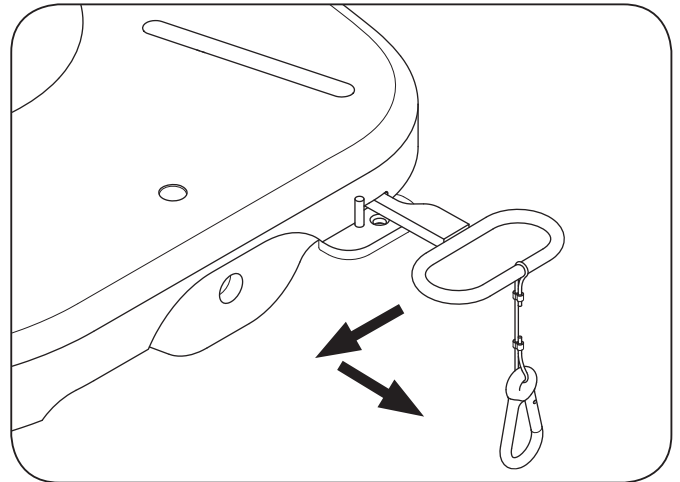

Figure 18

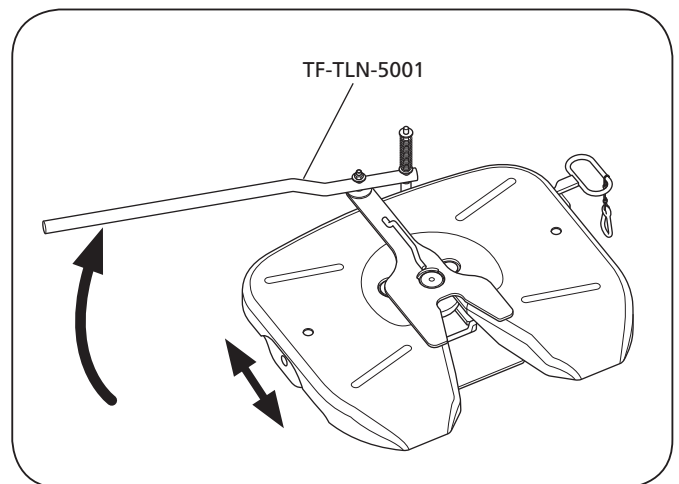
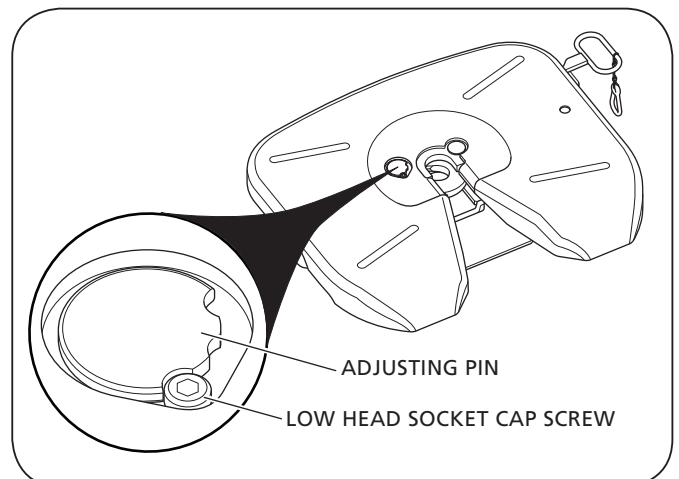

Figure 19



6. Verify the proper adjustment by locking and unlocking the fifth wheel several times with the lock tester. Check that the fifth wheel is properly locked (**Figure 20**).
7. Rotate the lock tester from side to side to ensure that the lock is not over tightened. The lock should not grip the kingpin and the tool should rotate freely (**Figure 21**).
8. Re-check for free play in the lock by sliding the lock tester forward and backward using a pin gage to measure the free play (**Figure 18**). Free play should be 1 mm (0.04") minimum. If free play still exceeds 2 mm (0.08"), repeat procedure and adjust one more notch.
9. Pull the release handle to unlock the fifth wheel. Push down and rotate "J" hook on the lock tester so that it hooks under the front skirt of the fifth wheel top plate (**Figure 22**). Pull the lock tester handle counter-clockwise to release the kingpin and remove the lock tester.

IMPORTANT: DO NOT use any fifth wheel which does not operate properly. If the fifth wheel does not operate properly, contact SAF-HOLLAND® Customer Service at +86 592 6388891 or refer to this manual's back cover for the nearest location for assistance.

Figure 20

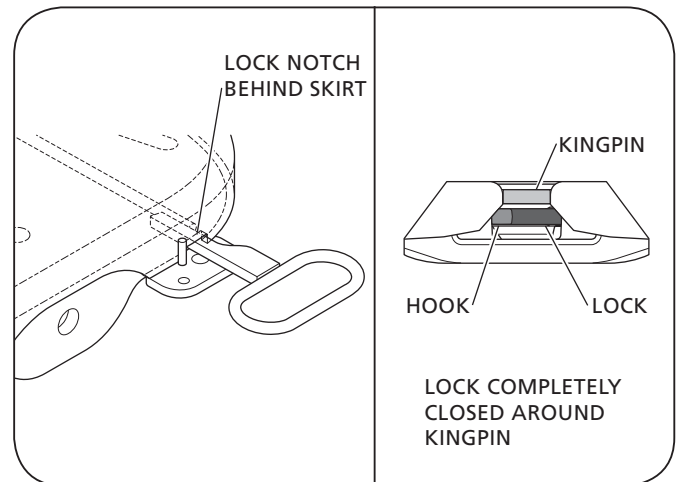

Figure 21

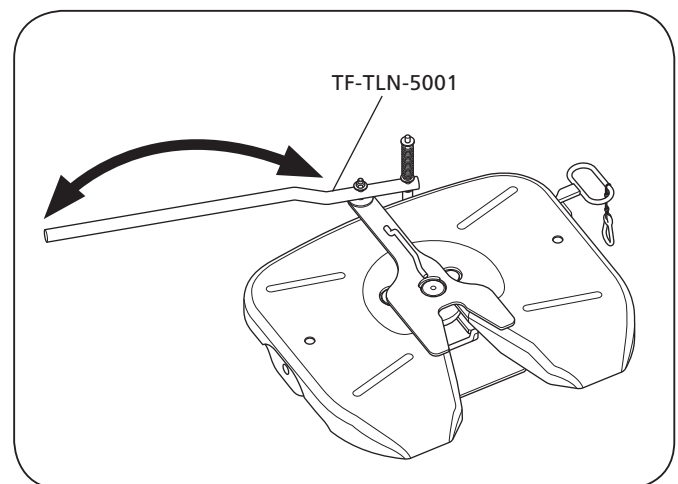
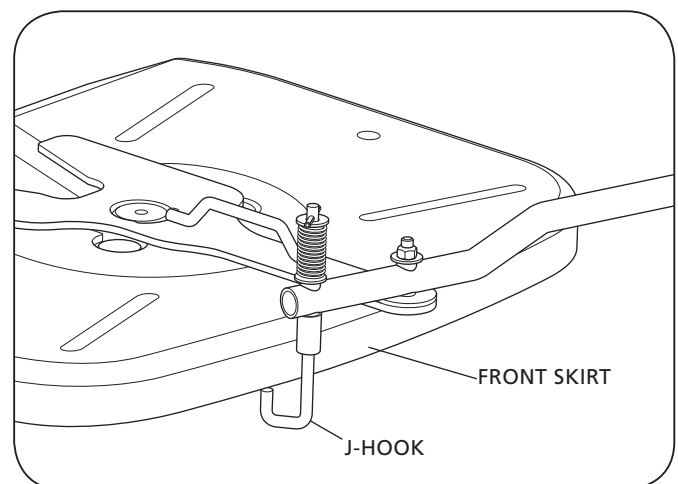

Figure 22





从鞍座重装套件到悬架轴衬维修套件，
赛夫-华兰德® 原装零部件是指与原装部件总成所用部件相同的高品质零部件。

赛夫-华兰德® 原装零部件经过测试和设计，
能够实现最佳的性能和最强的耐用性。
非赛夫-华兰德® 零部件将限制产品潜在性能的发挥，
并可能导致赛夫-华兰德® 保修失效。
维修您的赛夫-华兰德® 产品时，
请始终确保使用指定的赛夫-华兰德® 原装零部件。

赛夫-华兰德美国公司

美国 • 马斯基根
电话：888.396.6501
传真：800.356.3929
网站：www.safholland.us

赛夫-华兰德澳大利亚公司

澳大利亚 • 梅尔顿
电话：+61.3.9971.7900
传真：+61.3.9743.6763
网站：www.safholland.com.au

赛夫-华兰德加拿大

加拿大 • 伍德斯托克
电话：519.537.3494
传真：800.565.7753
网站：www.safholland.ca

赛夫-华兰德马来西亚公司

马来西亚 • 八打灵再也
电话：+60.3.8024.3433
传真：+60.3.8024.3431

赛夫-华兰德南非公司

南非 • 蒙德、约翰内斯堡
电话：+27.11.496.3196
传真：+27.11.496.3696
网站：www.safholland.co.za

赛夫-华兰德中东公司

阿拉伯联合酋长国 • 迪拜
电话：+971.(4).883.62.62
传真：+971.(4).883.62.65
网站：www.safholland.ae

赛夫-华兰德德国

德国 • 贝森巴赫
电话：+49.6095.301.602
传真：+49.6095.301.260
网站：www.safholland.de

赛夫-华兰德巴西

巴西 • 圣保罗州雅瓜里乌纳
电话：+55.19.3311.1550
传真：+55.19.3311.1554
网站：www.safholland.com.br

赛夫-华兰德厦门有限公司

中国 • 厦门
电话：+86.592.6388.891
传真：+86.592.6288.892
网站：www.safholland.cn

赛夫-华兰德墨西哥

墨西哥 • 塔兰潘特拉巴兹
电话：52.1.55.5456.8641
传真：52.55.58162230
网站：www.safholland.com.mx

赛夫-华兰德泰国有限公司

泰国 • 北榄府
电话：+66.2.740.0972
传真：+66.2.740.0974

info@safholland.com