

COUPLER PRODUCTS

LATCH REPLACEMENT PROCEDURES



RK-05961

For PH-760

1. Remove the nut, pivot bolt, cotter pin and latch assembly. Discard the nut, latch assembly, and cotter pin. Retain the pivot bolt.

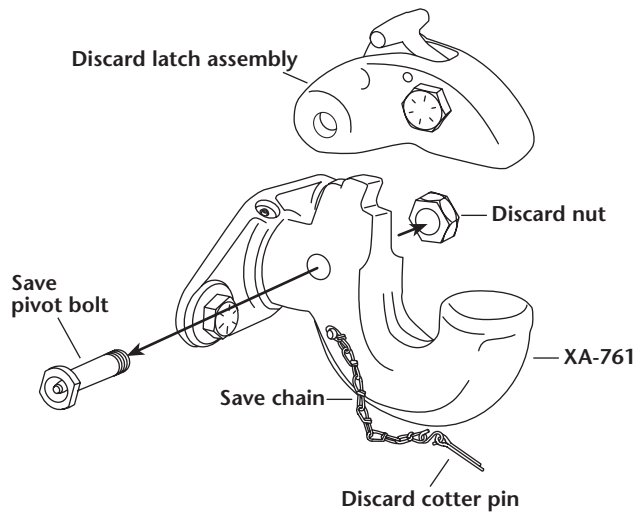

2. Apply Never-Seez® to entire shaft of the old pivot bolt (not on threads).

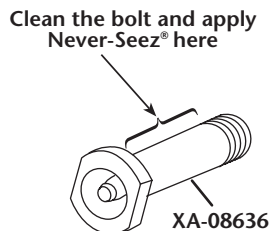

3. Install the new latch assembly using the old pivot bolt and a new pivot nut. Torque the nut to 75-100 ft-lbs. Install a new cotter pin with "S" link on the end of the existing chain. Crimp to secure the cotter pin.

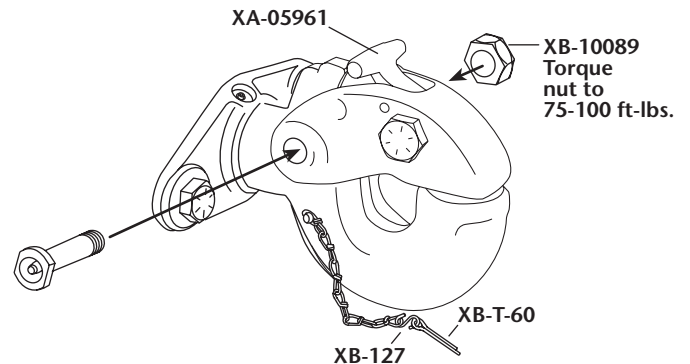

4. Check the latch for proper operation. It should open and close freely. When closed, the lock must be fully down. Install the cotter pin into the hole in the side of the latch, as shown. Spread the cotter pin to secure it in the latch.

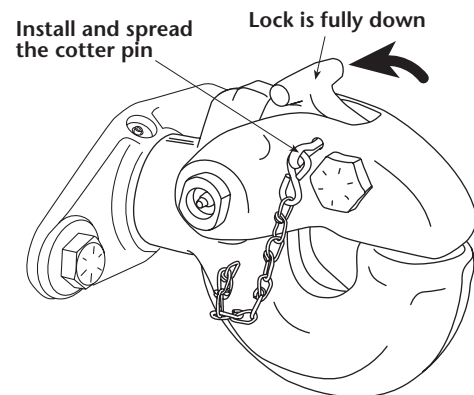

Copyright © April 2002 • The Holland Group, Inc.

Holland USA, Inc. Facilities:

Denmark, SC Muskegon, MI
 Dumas, AR Warrenton, MO
 Holland, MI Whitehouse Station, NJ
 Milpitas, CA Wylie, TX

Ph: 888-396-6501 Fax: 800-356-3929

Holland International, Inc.

Holland, MI
 Phone: 616-396-6501
 Fax: 616-396-1511

Holland Hitch of Canada, Ltd.

Woodstock, Ontario • Canada
 Phone: 519-537-3494
 Fax: 800-565-7753

Holland Equipment, Ltd.

Norwich, Ontario • Canada
 Phone: 519-863-3414
 Fax: 519-863-2398

Holland Hitch Western, Ltd.

Surrey, British Columbia • Canada
 Phone: 604-574-7491
 Fax: 604-574-0244