

# BH-50mmRN41

## Specifications

### Rigid Type Pintle Hook with 50 mm Ball Hitch.

**50 mm Ball Hitch: 4535.92 kg Max. Gross Trailer Weight**

**Pintle Hook: 1814.37 kg Max. Vertical Load, 9071.85 kg Max. Gross Trailer Weight**

(Meets SAE J684 Class 4 Standards in a 50 mm Ball)

Tested in accordance with SAE J847 (Type II)

### Important Safety Information

Maintain adequate vertical (tongue) load to properly control the trailer (generally 10%) but DO NOT exceed the above rated capacities.

DO NOT damage the latch. Be particularly careful with the drawbar when coupling and uncoupling.

Other steps and inspections are also required. Consult OSHA and D.O.T. regulations and American Trucking Association for complete coupling and uncoupling procedures. These cover items such as cargo securement, brakes, lights, safety chains, and other important requirements.

This equipment MUST NOT be used or maintained in a careless manner.

### General Information

1. DO NOT modify or add to the product.
2. Wear safety goggles during installation, removal and servicing.
3. Never strike any part of the item with a steel hammer.
4. DO NOT weld on this product.

This product is covered by SAF-HOLLAND's® Commercial Products Warranty. SAF-HOLLAND reserves the right, without giving prior notice, to change specifications and dimensions as designs are altered or improved.

### Towing Applications

Trailers and equipment designed for over-the-road towing within the stated capacities. Use ONLY with a non-swivel type drawbar. For off-road applications, reduce the capacities above by 25% and use in conjunction with a swivel type drawbar.

### Drawbar Eye/Ball Hitch Dimensions

Compatible with drawbar eyes with the following dimensions:

- 60.45 mm to 76.20 mm I.D. with 31.75 mm to 41.40 mm
- 50 mm SAE J684 ball hitch coupler.

### Mounting

1. Use a mounting structure of sufficient strength to support the rated capacity of the pintle hook in accordance with SAE J847 and SAE J849.
2. Use the hole pattern described on the reverse.
3. Use four 12 mm class 10.9 fasteners, properly torque to 81.35 Nm.

### Operating Instructions - Pintle Hook

1. Before operating, inspect for proper operation, worn, damaged or missing parts and a secure mounting. Correct as required before use.
2. Open latch (A) by removing lock pin (B) and lifting the lock handle (C) (**Figure 1**).
3. Position the drawbar eye over the horn of the pintle and lower into place.
4. Push the latch (A) closed and insert the lock pin (B) in the hole provided in the latch (**Figure 1**).
5. If main lock does not engage when attempting to close latch, do not force it closed by striking. Check bottom of latch and top of horn and lock seating notch on pintle body that they are free of debris.

### Operating Instructions - Pintle Hook

1. Before operating, inspect for proper operation, worn, damaged or missing parts and a secure mounting. Correct as required before use.
2. Open latch (A) and lift the lock handle (B).
3. Position ball coupler over the 50 mm ball and lock into place, following the instructions of the coupler manufacturer. Be sure coupler size matches ball size.

**Figure 1**

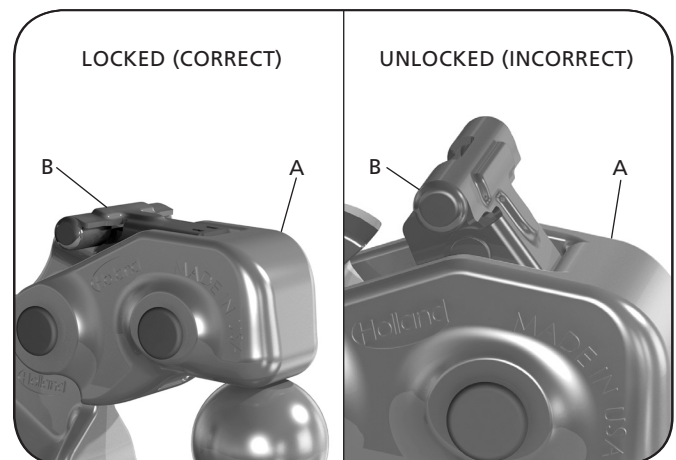

# BH-50mmRN41



SAF-HOLLAND Group

## Maintenance

For proper performance, the following maintenance steps should be performed every 48,280 miles or 3 months, whichever comes first.

1. Clean and inspect for worn, damaged or missing parts. Replace as required using only SAF-HOLLAND original parts.
2. Inspect the hook (XA-10799-50) and latch (XA-10636 sub-assembly) in areas where contact is made with the drawbar for excessive wear. Replace the hook when wear exceeds 3.175 mm from the original surface profile.
3. With the latch closed, measure the gap between the hook and the latch while lifting up on the latch. Replace the latch (XA-10636 sub assembly) when the gap exceeds 6.35 mm. Refer to Detail A.
4. Check mounting fasteners as instructed in Step 3 of the "Mounting" Section.
5. Lubricate latch pivots with a light oil lubricant or penetrating oil.

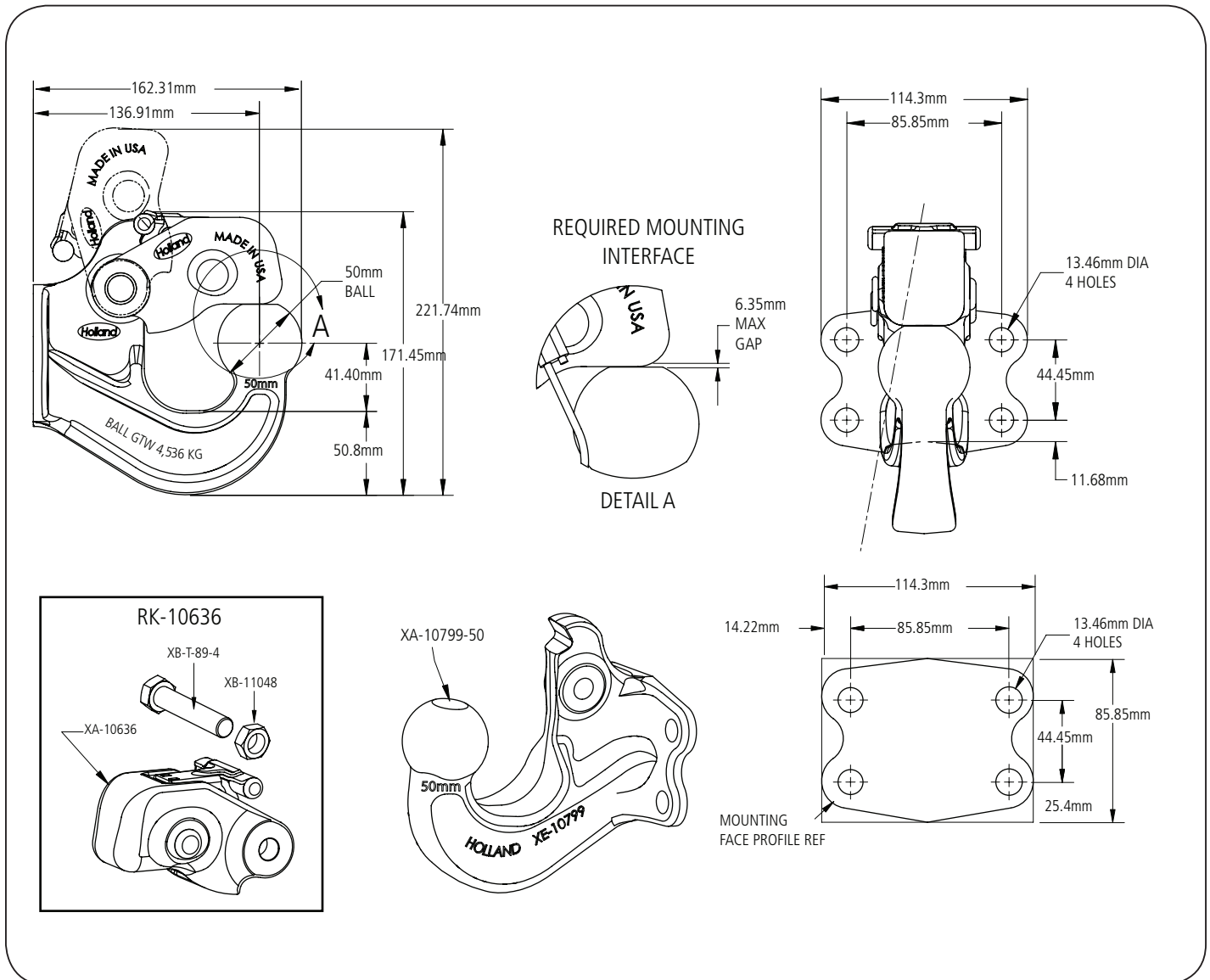

XL-PH379 Rev C - 2018-03-12 - Amendments and Errors Reserved - © SAF-HOLLAND, Inc., SAF-HOLLAND, HOLLAND, SAF, and logos are trademarks of SAF-HOLLAND S.A., SAF-HOLLAND GmbH, and SAF-HOLLAND, Inc.

